

BYD P6-36 Series

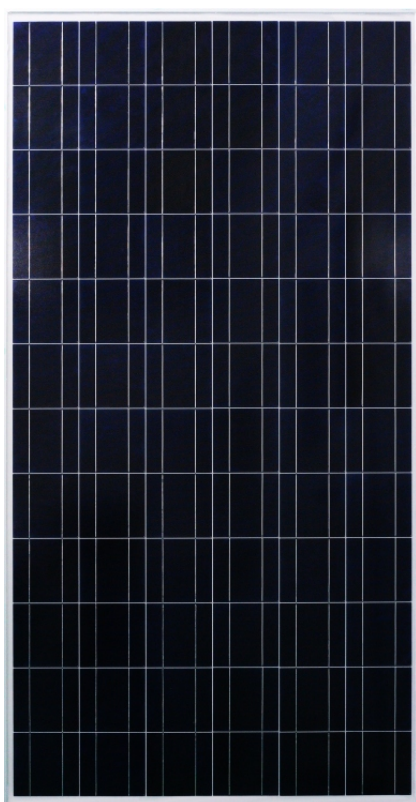

BYD, a fastest-growing green technology manufacturer, provides advanced PV products ranging from Wafer to PV Module. Based on its advanced technology, BYD Solar aims at Grid Parity, which can drive mass market-adoption of renewable energy.

Features

- High efficiency-BYD has achieved 17.4% efficiency
- Excellent optical performance
- Easy to be installed
- Strong frame module, passing mechanical load test of 5400Pa

Warranty

- 10 years for product
- 10 years on 90% for performance
- 25 years on 80% for performance

Recommended Applications

- Residential roof top systems
- On-grid commercial systems
- On-grid utility systems
- Off-grid commercial systems
- Off-grid utility systems

Certificates

UL1703, CE, TÜV, IEC 61215, IEC 61730, PV Cycle, MCS and CEC.
ISO9001:2008, ISO14001:2004

Model	BYD 260P6-36	BYD 265P6-36	BYD 270P6-36	BYD 275P6-36	BYD 280P6-36	BYD 285P6-36	BYD 290P6-36	BYD 295P6-36	BYD 300P6-36
Open Circuit Voltage (Voc)	42.77 V	42.84 V	43.03 V	43.28 V	43.93 V	44.58 V	44.82 V	45.00 V	45.25 V
Maximum Operating Voltage (Vmp)	34.62 V	34.70 V	34.80 V	34.93 V	35.23 V	35.52 V	35.76 V	36.00 V	36.20 V
Short Circuit Current (Isc)	8.22 A	8.23 A	8.34 A	8.46 A	8.57 A	8.59 A	8.82 A	8.90 A	8.99 A
Maximum Operating Current (Imp)	7.51 A	7.66 A	7.76 A	7.87 A	7.95 A	8.02 A	8.10 A	8.19 A	8.29 A
Maximum Power in STC (Pmax)	260 Wp	265 Wp	270 Wp	275 Wp	280 Wp	285 Wp	290 Wp	295 Wp	300 Wp
Module Efficiency	13.40%	13.66%	13.92%	14.17%	14.43%	14.69%	14.95%	15.20%	15.46%
Operating Temperature	-40 °C ~ + 85 °C								
Maximum System Voltage	1000 VDC(IEC) / 600 VDC (UL)								

■ STC: IRRADIANCE 1000W/m², Module Temperature 25°C, AM=1.5



BYD COMPANY LIMITED

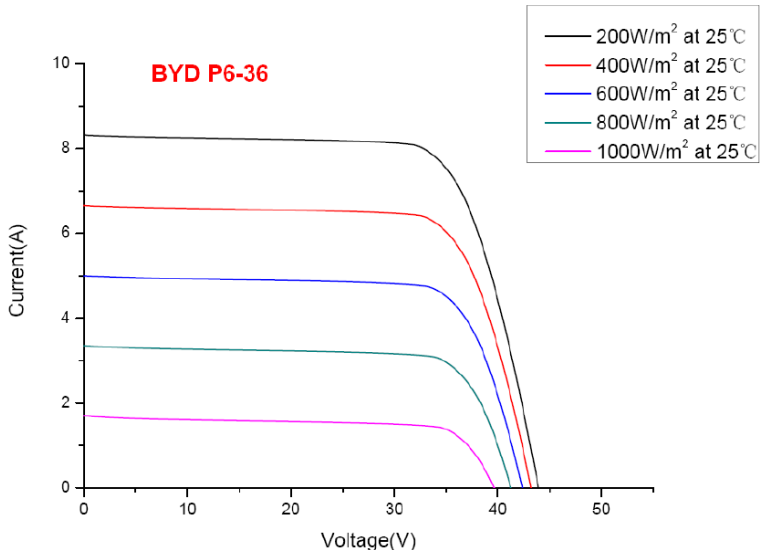
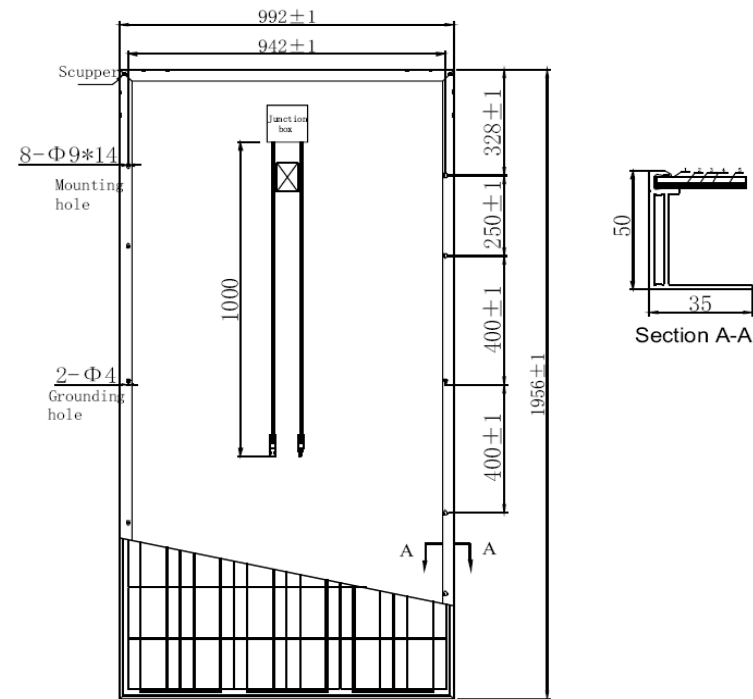

Temperature Coefficients	
NOCT	45 °C ± 2 °C
Short-circuit current temperature coefficient	0.045%/ °C
Open-circuit voltage temperature coefficient	-0.34%/ °C
Peak power temperature coefficient	-0.47%/ °C
Power tolerance	0~ 3%

NOCT: Nominal Operating Cell Temperature. The above data is only for reference.

Specifications	
Cell	Polycrystalline Silicon solar cells 156mm * 156 mm / 6 inch
No. of cells	72 (6 * 12) pcs
Dimension of module	1956 mm * 992 mm * 50 mm / 77.0 inch * 39.1 inch * 2.0 inch
Weight	23.10 kg / 50.93 lbs
Front Glass	3.2 mm (0.13 inch) tempered glass
Frame	Anodized aluminum alloy
Junction Box Protection Degree	IP65 rated
Plug connector protection degree	IP65 / IP67(MC 4)
Bypass-Diodes	6 pcs. (IEC) / 3 pcs. (UL)
Max. Fuse Current Rating	15 A
Type of Connector	MC4, MC4 compatible, MC3 compatible, 0-1394462-4/6-1394461-2

Output Cables	
Cable Section Area	4 mm ² / 0.0062 Sq inch
Cable Length	2 * 1000 mm / 2 * 39.4 inch

Package Information	
Package	40' HC
Pcs/pallet	21
Pallet/container	22
Pcs/container	462