



## ∟ CN SOLAR(POLY SERIES)

### ● STRENGTHS

Tolerance  $\pm 3\%$   
2 Bus Bar Configuration  
Plug and Play Connectors  
High Transmission, Low Iron  
Tempered Glass  
Can bear loads up to 5400  
pascals (IEC 61215 2nd)

### ● WARRANTY

10 years product guarantee.  
25 years performance  
warranty of 90% for the first  
10 years and 80% for the  
remaining 15 years.



POLY

### ● POLY CRYSTALLINE SOLAR MODULE

Using only the best quality materials to provide high quality solar modules

- High efficiency solar cells with high transmission and low Iron textured glass delivering high efficiency modules;
- Bypass diode minimizes the power drop caused by shading;
- Tempered glass, EVA resin, and weatherproof film, plus aluminum frame for extended outdoor use;
- Modules independently tested to ensure conformance with certification and regulatory standards;
- Manufacturing facility certified to ISO 9001 & ISO 14001 quality management System standards;





## CN SOLAR(POLY SERIES)

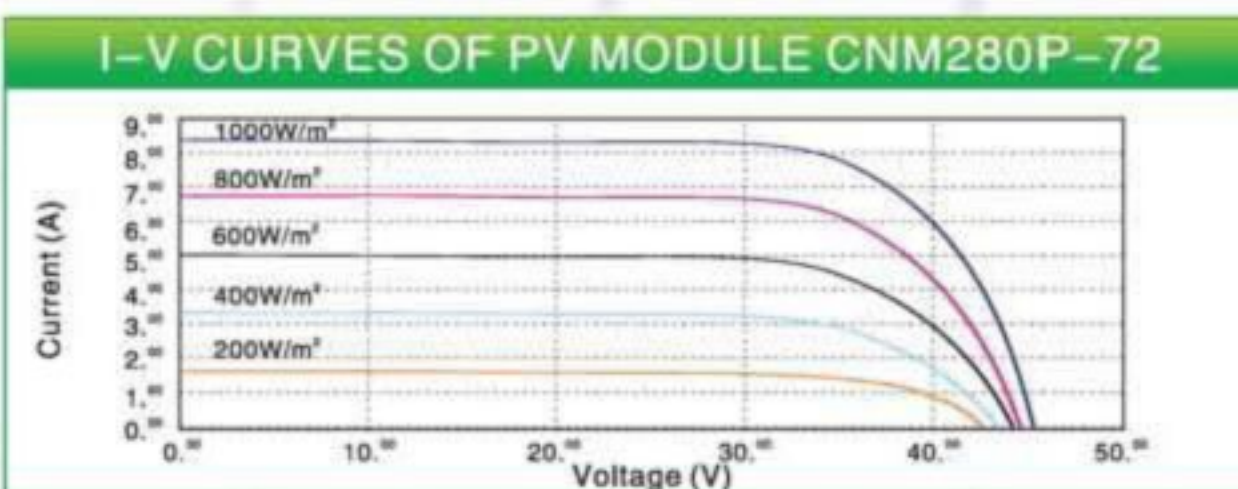
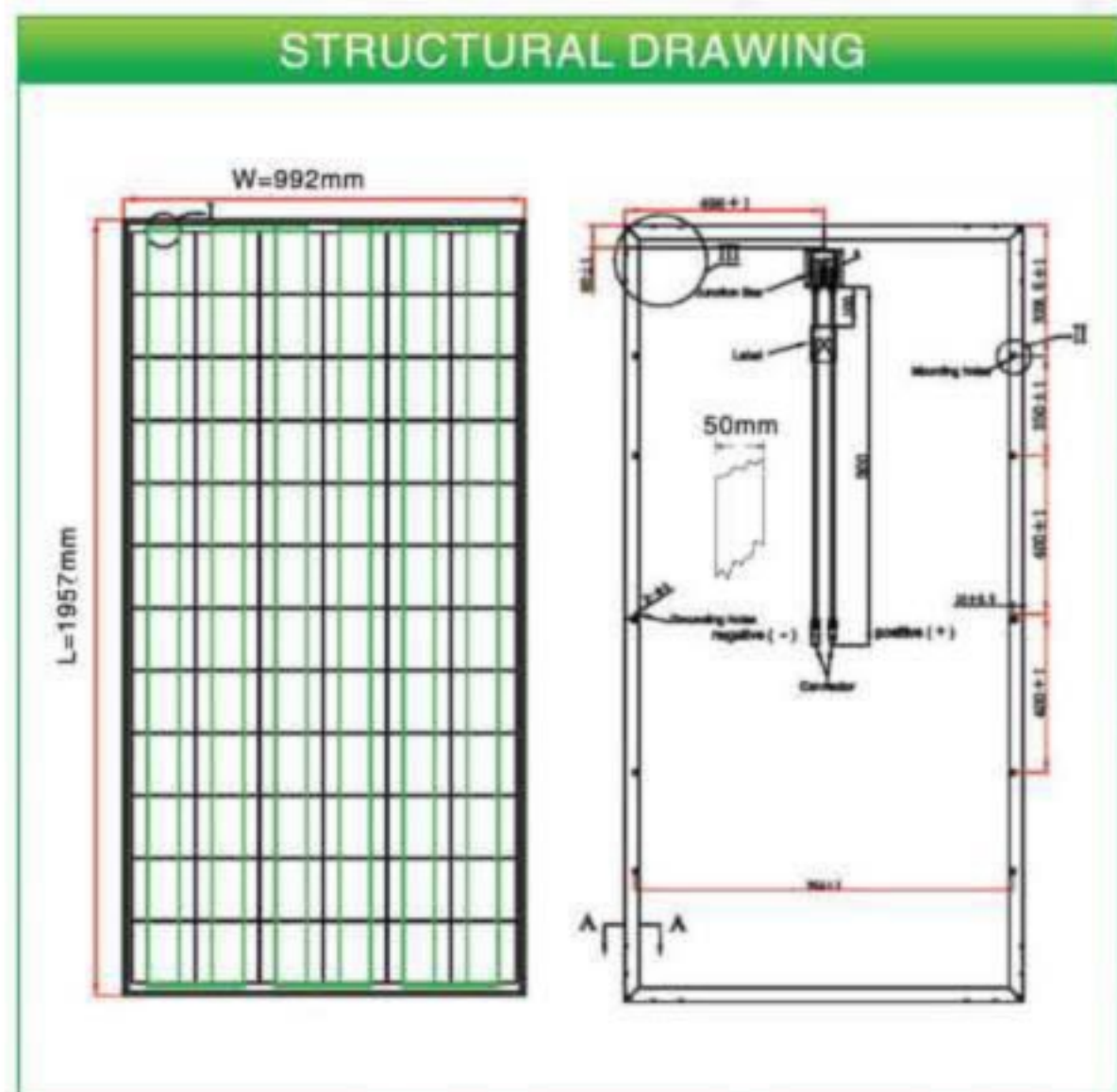

**SPECIFICATIONS**

Cell	156*156(mm)
No. of cells and connections	72Pcs
Weight	22.5kgs
Dimension(L*W*H)	1957*992*50(mm)



**CHARACTERISTICS**

Model	CNM270P-72	CNM275P-72	CNM280P-72	CNM285P-72	CNM290P-72	CNM295P-72
Maximum Power (Pm)	270Wp	275Wp	280Wp	285Wp	290Wp	295Wp
Open circuit voltage (Voc)	44.00V	44.00V	44.60V	44.60V	44.60V	45.30V
Optimum operating voltage(Vm)	35.50V	35.50V	36.00V	36.00V	36.00V	36.50V
Short circuit current (Isc)	8.14A	8.30A	8.40A	8.55A	8.61A	8.72A
Optimum operating current (Im)	7.61A	7.75A	7.78A	7.92A	8.05A	8.08A
Maximum Voltage at STC (Vm)	1000VDC					
Operating temperature (°C)	-40°C ~ 85°C					

STC: AM1.5, 25

### ● Model (CNM285P-72) Specifications

**General Data**

Solar Cells	156*156
Type of Connector	TUV certified MC4 compatible plug & play
Cable Type diameter and length	φ = 4mm²   L = 1000 mm TUV certified
Front Glass Thickness (mm)	3.2

**Mechanical and Packing Conguration**

Size of Module(mm)	1957*992*50
Maximum Power(W)	285
Number of Cells(pcs) per module	6*12
Optimum Power Voltage(Vmp)	36.00
Optimum Operating Current(Imp)	7.92
Open Circuit Voltage(Voc)	44.60
Short Circuit Current(Isc)	8.55
Weight Per Piece(KG)	22.50
Packaging	Wooden box 19 pcs per box. 418 pcs per 40HQ container
Cell Efficiency (%)	16.80
Module Efficiency (%)	14.68

**TEMPERATURE AND COEFFICIENTS**

NOCT ( °C )	47°C ± 2°C
Temperature Coefficients of Voc(%)/°C	-0.35
Temperature Coefficients of Isc(%)/°C	0.05
Temperature Coefficients of Pm(%)/°C	-0.45
Tolerance Wattage(e.g. +/-3%)	± 3%

NOCT: Nominal Operating Cell Temperature

**Warranty**

10 years manufacturing warranty
10 years warranty, 90% power output
25 years warranty, 80% power output

**Others**

Surface Maximum Load Capacity	5400Pa
Allowable Hail Load	23m/s 7.53g
Junction Box Type	TUV Certified
Bypass Diode Rating(A)	10
Temperature Range	-40°C to +85°C
Frame(Material Corners, etc.)	50#
Backing (Brand Type)	TPT
Standard Test Conditions	AM1.5
FF (%)	70-76%

### CN Solar Technology Co.,Ltd.

No. 199, Binhai 4RD, Hangzhou Bay Economic Development Zone, Ningbo China.  
 Tel: +86-574-63937488 Fax: +86-574-63937499  
 Http: //www.zjcn solar.com E-mail: cn@zjcn solar.com

