

kWp230p - kWp235p - kWp240p - kWp250p

The careful selection of raw materials combined with the high standard of production processes makes **kWpower** photovoltaic panels a safe, reliable and efficient product.

kWpower module features are the result of a continuous research of excellence by the company.

- EUROPEAN PRODUCT

- Careful selection of raw materials
- High quality control
- Ammonia Test
- Product warranty against manufacturing defects 10 years
- Coverage of the guarantees offered by insurance

Construction

- 1) Cover: tempered glass 4 mm
- 2) First layer of EVA (ethylene-vinyl-acetate)
- 3) Silicon cells
- 4) Second layer of EVA
- 5) Back: TPT

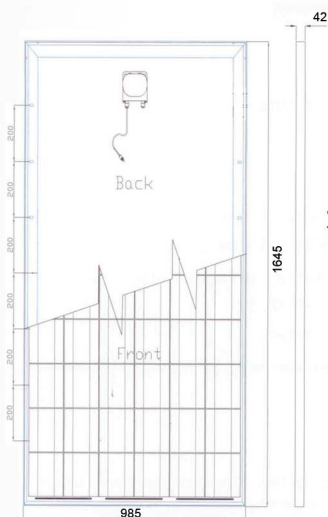
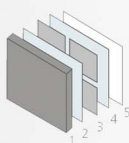

Label



Junction box
Tyco Electronics



TECHNICAL DATA

Model		kWp230p	kWp235p	kWp240p	kWp250p
Maximum power (+/-3%)	Pmax(Wp)	230	235	240	250
Maximum current (A)	I _{mp}	7.80	7.85	7.90	8.10
Short-circuit current (A)	I _{sc}	8.28	8.35	8.50	8.80
Open circuit voltage (V)	V _{oc}	37.0	37.2	37.5	37.7
Voltage at maximum power (V)	V _{mp}	29.5	29.9	30.4	30.8
Efficiency		14.20%	14.50%	14.80%	15.43%
Nominal Operating Cell Temperature	NOCT		45 °C		
Maximum system voltage (V)			1000 Vdc		
Temperature range			-40°C a +85°C		
Hail resistance			up to 25mm / 90 km/h		
Maximum power temperature coefficient (°C)			-0.45%		
Temperature coefficient of short circuit current (°C)			0.07%		
Temperature coefficient of open circuit voltage (°C)			-0.34%		
Surface load			550kg/m ²		
Dimensions			1645x985x42 mm		
Weight			22 kg		

Product warranty against manufacturing defects 10 years.

10 years 90% production guarantee,
25 years 80% production guarantee.

kWpower reserves the right to modify the product without notice

Read the instructions carefully before installing.
All right reserved.