

## STS-5M- (220-265) M-96 MONO CRYSTALLINE SOLAR MODULES 单晶硅太阳能电池



### PRODUCT OVERVIEW 产品简介

- STS Solar's modules are optimally manufactured and adjusted to meet the needs of the current market; scientifically designed module dimension makes the installation simple and easy.
- 产品符合市场需求，尺寸设计科学合理、安装简便
- Our continuous efforts in quality assurance system and certifications the international authentication institutions of STS Solar's products demonstrate our commitment to product quality and customer requirements.
- 产品性能稳定、质量可靠，已获得国内外权威机构检测认证

### MODULE CHARACTERISTICS 产品特点

- High efficiency crystalline silicon solar cells.
- 高效晶硅太阳能电池片
- High transmission low iron tempered glass, strong mechanical resistance.
- 高透光低铁钢化玻璃
- Standard waterproof junction box, with bypass diode.
- 标准防水接线盒（带二极管）。
- High endurance to different atrocious weather.
- 高耐候性
- Custom designed modules according to clients' requirement.
- 根据客户需求量身定制

### MECHANICAL PARAMETERS 物理性能

Cell(mm)	Mono 125×125
电池片(mm)	单晶 125×125
Weight(kg)	20
重量(kg)	20
Dimensions(LxWxH)(mm)	1580×1062×45
尺寸(LxWxH)(mm)	1580×1062×45
Cable Length(mm)	≥900
线缆长度(mm)	≥900
Cable cross section size(mm <sup>2</sup> )	4
线缆截面大小	4
No. of cells and connections	96 (12x8)
电池片数量	96 (12x8)
No. of diodes	4
二极管数量	4
Packing configuration	20pcs/carton
包装	20pcs/carton

### WORKING CONDITIONS 工作条件

Maximum System Voltage	DC 1000V
峰值电压	DC 1000V
Operating Temp.	-40℃~+85℃
工作温度	-40℃~+85℃
Maximum Series Fuse (A)	10
最大保险系数(A)	10
Static loading	≥2400Pa
抗压	≥2400Pa
Grounding conductivity	≤0.1Ω
地表导电率	≤0.1Ω
NOCT	45±2℃
电池额定工作温度	45±2℃
Application Class	Class A
应用等级	A级
Insulation Resistance	≥100MΩ
绝缘电阻	≥100MΩ

### GUARANTEE 质量保证

10-year limited product warranty.

十年产品质保

Limited performance warranty: 10 years at 90% of the minimal rated power output, 25 years at 80% of the minimal rated power out

功率保证：输出功率 10 年内不低于额定功率的 90%，25 年内不低于额定功率的 80%

## STS-5M- (220-265) M-96

### MONO CRYSTALLINE SOLAR MODULES 单晶硅太阳能电池

#### ELECTRICAL PARAMETERS 电性能参数

TYPE 型号	STS-5M-220M-96	STS-5M-225M-96	STS-5M-230M-96	STS-5M-235M-96	STS-5M-240M-96	STS-5M-245M-96	STS-5M-250M-96	STS-5M-255M-96	STS-5M-260M-96	STS-5M-265M-96
Pmax(w) 功率	220	225	230	235	240	245	250	255	260	265
(Voc/V)开路电压	58	58	58.6	58.6	59.2	59.2	59.8	59.8	60.1	60.1
(Vmp/V)峰值电压	47.5	47.5	48.0	48.0	48.5	48.5	49.0	49	49.1	49.1
(Isc/A)短路电流	5.0	5.07	5.15	5.23	5.32	5.45	5.51	5.62	5.72	5.81
(Imp/A)峰值电流	4.63	4.74	4.79	4.89	4.95	5.05	5.10	5.2	5.3	5.4
Power Tolerance 公差	±3%									
$\alpha$ Isc $\alpha$ 温度系数	+0.06%/°C									
$\beta$ Voc $\beta$ 温度系数	-0.36%/°C									
$\gamma$ Pmp $\gamma$ 温度系数	-0.48%/°C									
STC 标准测试条件	AM1.5, 1000W/m <sup>2</sup> , 25°C									

#### I-V CURVE 曲线图

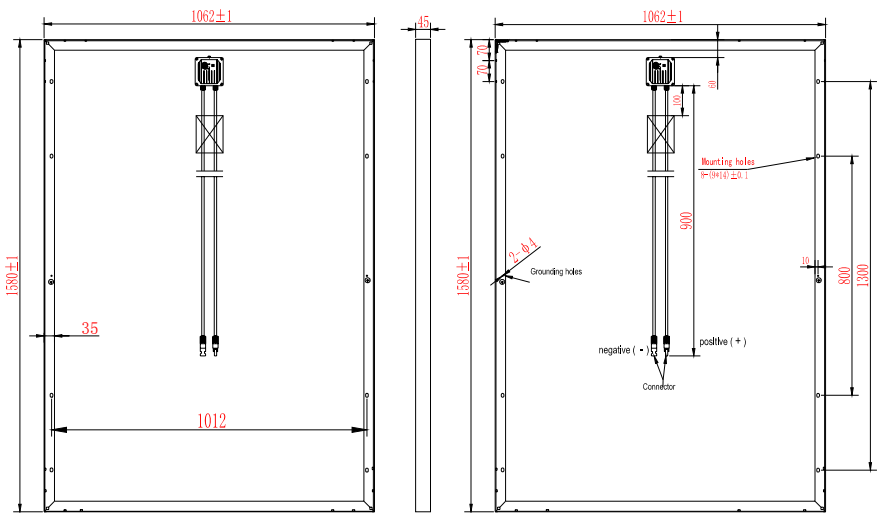
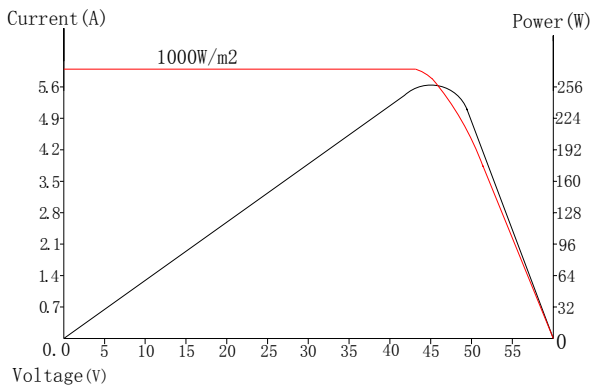

Zhejiang Jingshang New Energy Technology Inc.

浙江晶尚新能源科技有限公司

Add: Nanxun Industrial Park, Huzhou, Zhejiang, 313009 China

地址: 浙江省湖州市南浔工业园区

Tel: +86 572 3872111 Fax: +86 572 3872098

E-mail: sales@sts-pv.com Web: <http://www.sts-pv.com>