



MSM220-96M MSM225-96M MSM230-96M
 MSM235-96M MSM240-96M MSM245-96M
 MSM250-96M MSM255-96M MSM260-96M

Electrical Specifications

*STC : Irradiance 1000W/m², AM1.5 spectrum, module temperature 25°C

Model type	220-96M	225-96M	230-96M	235-96M	240-96M	245-96M	250-96M	255-96M	260-96M
Peak power (Pmax)	220W	225W	230W	235W	240W	245W	250W	255W	260W
Cell Efficiency	15.3%	15.7%	16.0%	16.3%	16.7%	17.0%	17.4%	17.7%	18.2%
Maximum power voltage (Vmp)	47.5V	47.5V	48V	48V	48.5V	48.5V	49.0V	49.0V	49.5V
Maximum power current (Imp)	4.64A	4.74A	4.80A	4.89A	4.95A	5.06A	5.11A	5.22A	5.30A
Open circuit voltage (Voc)	58.0V	58.0V	58.6V	58.6V	59.2V	59.2V	59.8V	59.8V	60.1V
Short circuit current (Isc)	5.0A	5.07A	5.15A	5.23A	5.32A	5.45A	5.51A	5.62A	5.72A
Power Tolerance	±3%								
Maximum system voltage	1000VDC								
Series fuse rating (A)	10								
Number of bypass diode	4								

Temperature Coefficients

Current Temperature Coefficient $\alpha(Isc)$ 0.03%/°C
 Voltage Temperature Coefficient $\beta(Voc)$ - 0.32%/°C
 Power Temperature Coefficient $\gamma(Pmax)$ -0.42%/°C

Mechanical Characteristics

Dimensions : 1580 x 1065 x 50mm
 (62.2x41.93x1.97 inch)
 Weight: 21.5 kg (47.4 lbs)
 Solar Cells: 96 cells in series(8x 12)
 Construction: High-transmission low-iron tempered glass , EVA, TPT
 Frame: Anodized aluminum is mainly for improving corrosion resistance. Color: silver

Output(Optional)

Cable LAPP(4 mm²)
 Lengths 900mm(-) and 900(+)
 Connector MC Plug Type IV

Module Warranty:

25-year limited warranty of 80% power output;
 10-year limited warranty of 90% power output;
 5-year limited warranty of materials and workmanship.

Note: This publication summarizes product warranty and Specifications which are subject to change without notice

Module Diagram

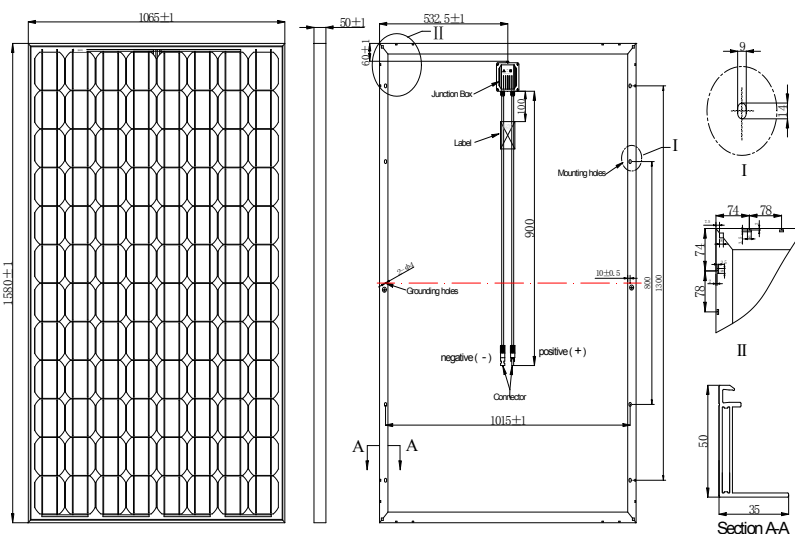

Electrical Performance

