

ELECTRICAL CHARACTERISTICS

Module Type	JHX-275S60	JHX-270S60	JHX-265S60	JHX-260S60	JHX-255S60
Maximum Power at STC (Pmax)	275W	270W	265W	260W	255W
Maximum Power Voltage (Vmp)	33.46V	33.06V	32.60V	32.19V	31.73V
Maximum Power Current (Imp)	8.221A	8.170A	8.130A	8.081A	8.041A
Open Circuit Voltage (Voc)	38.52V	38.46V	38.16V	38.11V	37.66V
Short Circuit Current (Isc)	8.771A	8.671A	8.601A	8.531A	8.470A
Module efficiency	16.9%	16.5%	16.2%	15.9%	15.6%
Maximum System Voltage	DC 1000V(TÜV) / DC 600V(UL)				
Operating Temperature	-40°C to +85°C				
Maximum Series Fuse Rating	15A				
Application Class	Class A				

STC: Irradiation 1000W/m², Module Temperature 25°C, AM=1.5 ; Power Measurement Tolerance:±3%

PHYSICAL CHARACTERISTICS

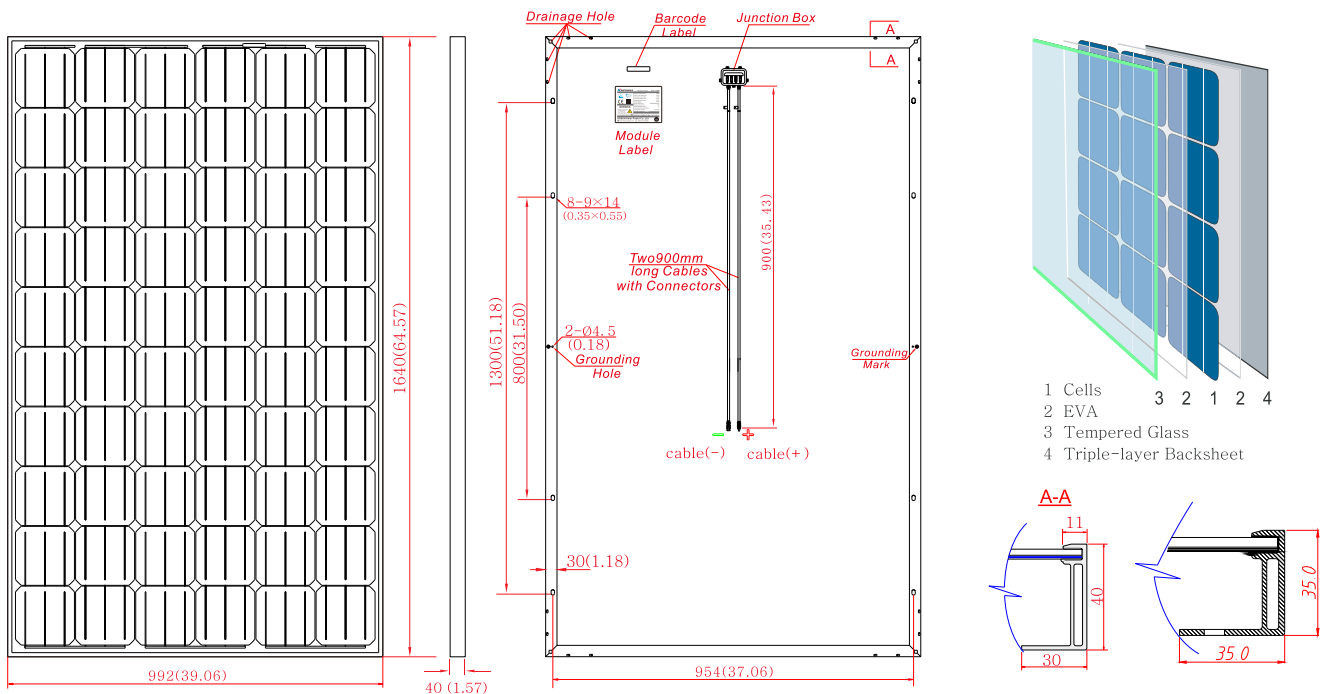

MECHANICAL DATA

Dimension	1640×992×40mm(64.57×39.06×1.57)
Cell Type	Mono Crystalline Silicon, 156mm × 156mm
Number of Cells	60 cells in series(10×6)
Weight	20.0kg±0.5kg
Front Glass	High Transparency Solar Glass3.2mm
Frame	Anodized Aluminium Alloy
Junction Box	TÜV: IP65 rated / IP67 rated,3/6 Diodes
Cable	Photovoltaic Technology 4.0mm ² , 900mm ,
Connector	MC-4 / DJ2011-4(SHIHE) Compatible

TEMPERATURE RATINGS

Nominal Operating Cell	47°C(±2°C)
Temperature(NOCT):	
Temperature Coefficient of Pmax	-0.48%/°C
Temperature Coefficient of Voc	-0.34%/°C
Temperature Coefficient of Isc	0.05%/°C

NOCT:Irradiation 800W/m²,ambient temperature 20°C,wind speed 1m/s

Current-Voltage & Power-Voltage Curve
JHX-250S60 (cell temperature:25°C)

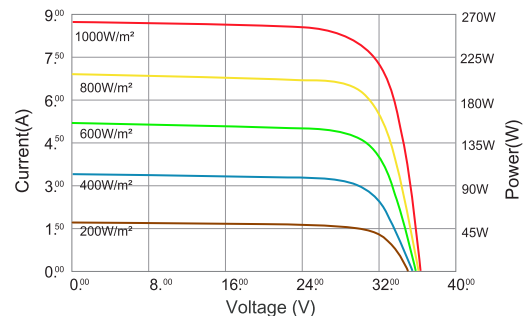

PACKING CONFIGURATION

Container	40HC	40HC
Pieces per pallet	50 (40*30)	56 (35*35)
Pallets per container	14	14
Pieces per container	700	784

JHX-S60XXXW

Peak Power **255-275** wp



Guaranteed 0-5wp plus output tolerance ensures high return on investment



Module efficiency (up to 16.9%) through superior manufacturing technology

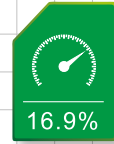

Module can bear snow loads up to 5400Pa and wind loads up to 2400Pa



Certified by the most reputable labs according to IEC:61215; IEC:61730-1/2 standards



Manufactured and certified according to International Quality and Environment Management System (ISO9001, ISO14001, ISO18000)



linear performance warranty

10 years product warranty

25 years power warranty

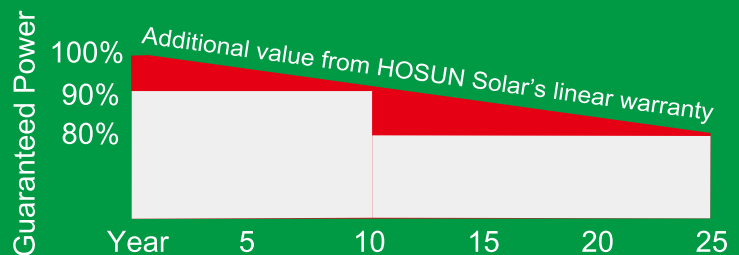

Superior Frame Design
Specially designed drainage holes and rigid construction prevent frames from deforming. Screwless frame design for a long term durability.



The new aluminum alloy (without mounting hole) is quicker in installment and better in protecting module, thus saving the mounting expense. It can help to avoid cracks on solar cells caused during the installment.