

MONO

ZJM

260W/255W/250W/245W/240W

CSE SOLAR
Power of the Future



High module conversion efficiency through superior manufacturing technology



Excellent performance under low light conditions (cloudy days, mornings and evenings)



Guarantee positive power tolerance



Module can bear snow loads up to 5400Pa and wind loads up to 3800Pa



Manufacturing facility certified by ISO 9001:2008, ISO 14001:2004



24-hour response service



Industry-leading Linear Warranty

12 year product warranty | 25 year linear power warranty

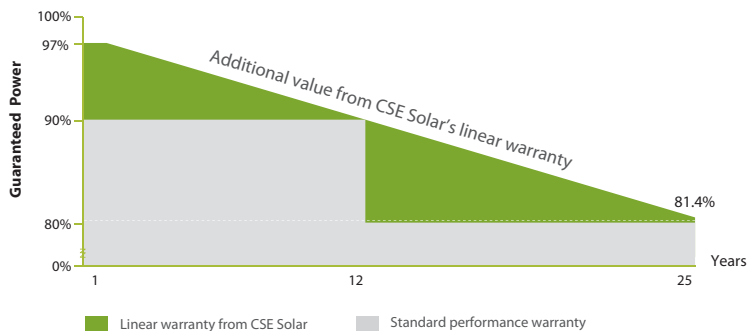

Dimensions of Module

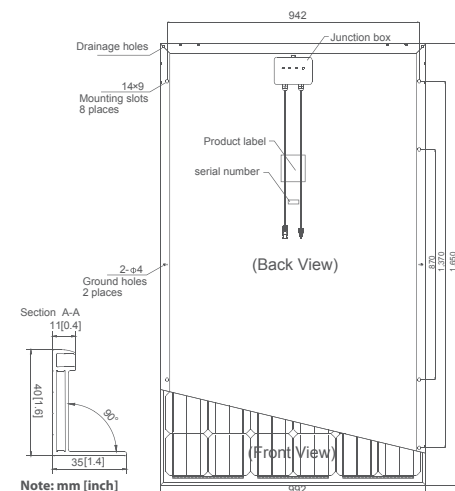

Electrical Characteristics	ZJM260W	ZJM255W	ZJM250W	ZJM245W	ZJM240W
Peak Power Watts- P_{MAX} (Wp)	260	255	250	245	240
Power Output Tolerance- P_{MAX} (%)	+3	+3	+3	+3	+3
Module Efficiency- η_m (%)	15.9	15.6	15.3	15.0	14.7
Maximum Power Voltage- V_{mp} (V)	30.9	30.8	30.5	30.4	30.3
Maximum Power Current- I_{mp} (A)	8.42	8.28	8.19	8.06	7.92
Open Circuit Voltage- V_{oc} (V)	37.6	37.5	37.5	37.4	37.3
Short Circuit Current- I_{sc} (A)	8.90	8.80	8.70	8.60	8.50
Operating Temperature Range (°C)	-40~+85				
Maximum System Voltage (V)	1000V DC (IEC) / 600V DC (UL)				
Maximum Series Fuse Rating (A)	20				

Values at Standard Test Conditions (STC):1000W/m² Irradiance, AM 1.5, Solar spectrum and 25°C module temperature.

NOCT	ZJM260W	ZJM255W	ZJM250W	ZJM245W	ZJM240W
Peak Power Watts- P_{MAX} (Wp)	184	180	175	171	168
Maximum Power Voltage- V_{mp} (V)	27.3	27.2	26.9	26.8	26.7
Maximum Power Current- I_{mp} (A)	6.74	6.60	6.51	6.38	6.29
Open Circuit Voltage- V_{oc} (V)	34.8	34.7	34.7	34.6	34.5
Short Circuit Current- I_{sc} (A)	7.39	7.29	7.19	7.09	7.02

NOCT: open circuit module operation temperature at 800W/m² irradiance, 20°C ambient temperature, 1m/s wind speed.

Mechanical Data

Solar Cells	Monocrystalline 156*156 mm (6 inches)
Cells Orientation	60 cells (6*10)
Module Dimension	1650*992*40 mm (64.96*39.06*1.57 inches)
Weight	19kg (41.89 lbs)
Front Glass	3.2 mm (0.13 inches) tempered glass
Frame	Anodized aluminum alloy
Junction Box	IP 67 rated
Cable / Connector	Solar cable: 4.0mm ² (0.006 inches ²), 900mm (35.4 inches), MC4

Temperature Characteristics

Nominal Operating Cell Temperature (NOCT)	(45±2) °C
Temperature Coefficient of P_{MAX}	(-0.47±0.05) %/°C
Temperature Coefficient of V_{oc}	(-0.34) %/°C
Temperature Coefficient of I_{sc}	(0.45±0.01) %/°C

Packing Configuration

Container	20' GP	40' GP	40' HQ
Pieces per Pallet	46	46	56
Pallets per Container	6	14	14
Pieces per Container	276	644	784

Current-Voltage & Power-Voltage Curve

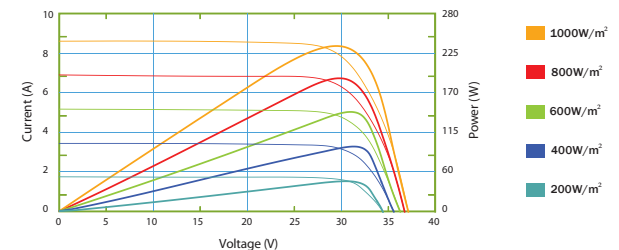

Caution: Read the instruction manual entirely before using the product. Specifications are subject to change without further notice.