

72 CELL

POLYCRYSTALLINE MODULE 280W-325W

72 CELL

POLYCRYSTALLINE MODULE 280W-325W

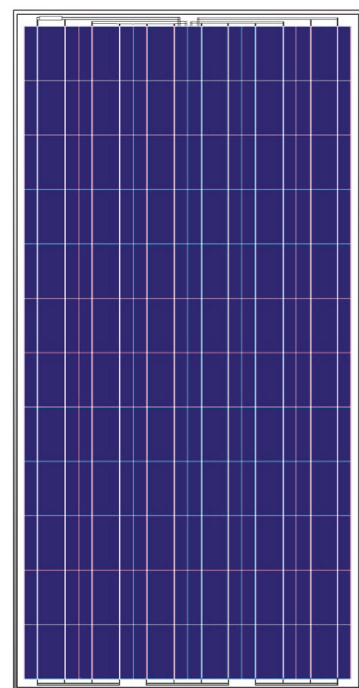

PRODUCT OVERVIEW+APPLICATION

- on-grid residential roof-tops
- on-grid commercial/industrial roof-top solar power stations
- Other off-grid applications
- In a large project, this cell solar module can help you save cost in labor and installation.

SOLAR MODULE ADVANTAGES

- Snow/Wind load
- Positive tolerance
- 25-year progressive warranty
- 10-year product warranty
- Slef-cleaning glass
- PID Resistant

MECHANICAL PARAMETERS

cell(mm)	poly 156X156
Weight(kg)	24
Dimensions(LxWxH)	1950x990x50/1957X992X50(TUV)
Cable Length(mm)	900MM
Cable cross section size(mm ²)	4
No.of cells and connections	60(10x6)
Frame	anodised aluminium alloy
Packing configutation	25/21pcs/carton

WORKING CONDITIONS

Maximum System voltage	DC1000(TUV)
Operating Temp.	-45°C+80°C
Junction Box	IP65/IP67 Reted
Static Loading	≤5400Pa
Maximum Serise Fuse(A)	15A
NOCT	47±2°C
Application Class	Class A
Test Standard	IEC61215/61730

GUARANTEE

5-year limited product warranty

Limited performance warranty: 10year at 90% of the minimal rated power output, 25years at 80% of the minimal rated power output

ZHEJIANG Yueyang Industry&Trade CO.,LTD.

Headquarter add: 29F, Jintong Mansion, Headquarter Center, Yongkang City, Zhe jiang Province, China

Telephone: +86 0579 87201232 Mail: Sales@yyopto.com

总部地址：浙江永康总部中心金同大厦29楼
联系电话：+86 0579 87201232 邮箱：Sales@yyopto.com
WWW.YYOPTO.COM



Specifications subject to technical changes 04.2014 Yinghe Solar Recycle

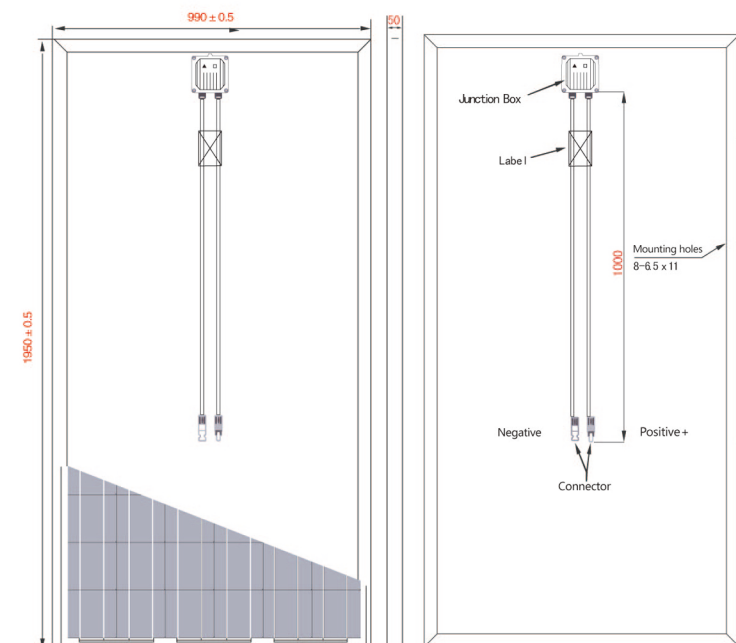

I-V CURVE

Output under different irradiation and the correlation between isc/voc/pmax and temperature map

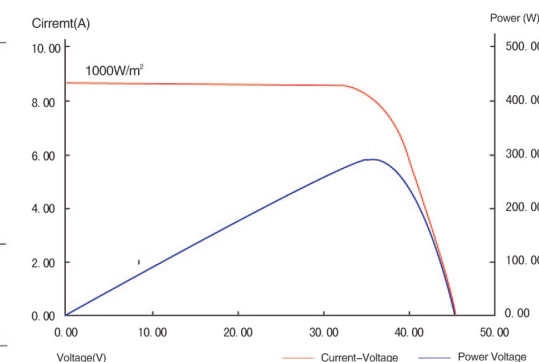

ELECTRICAL PARAMETERS

TYPE	HLSP-280P	HLSP-285P	HLSP-290P	HLSP-295P	HLSP-300P	HLSP-305P	HLSP-310P	HLSP-315P	HLSP-320P
Rated Maximum Power at STC(W)	280W	285W	290W	295W	300W	305W	310W	315W	320W
Maximim Power Voltage(Vmp/P)	36	36	36	36.5	36.8	37	37	37.2	37.2
Maximum Power Current(Imp/A)	7.78	7.92	8.05	8.08	8.152	8.24	8.37	8.46	8.61
Open Circuit Voltage(Voc/v)	44.6	44.6	44.6	45.2	46.09	46.3	46.3	46.55	46.55
Short Circuit Current(Isc/a)	8.4	8.55	8.55	8.58	8.66	8.75	8.88	8.97	9.12
Power Tolerance	0 to +3%								
Current temperature coefficient(ISC)	0.04%/°C								
Voltage temperature coefficient(Voc)	-0.30%/°C								
Power temperature coefficient(Pmp)	-0.39%/°C								

ZHEJIANG Yueyang Industry&Trade CO.,LTD.

Headquarter add: 29F, Jintong Mansion, Headquarter Center, Yongkang City, Zhe jiang Province, China

Telephone: +86 0579 87201232 Mail: Sales@yyopto.com

总部地址：浙江永康总部中心金同大厦29楼
联系电话：+86 0579 87201232 邮箱：Sales@yyopto.com
WWW.YYOPTO.COM



Specifications subject to technical changes 04.2014 Yinghe Solar Recycle