

# CT-HS275M 255-275 Watt MONO SOLAR PANEL

0/+3% Tolerance

ISO9001:2008、ISO14001:2004、OHSAS18001  
IEC61215、IEC61730

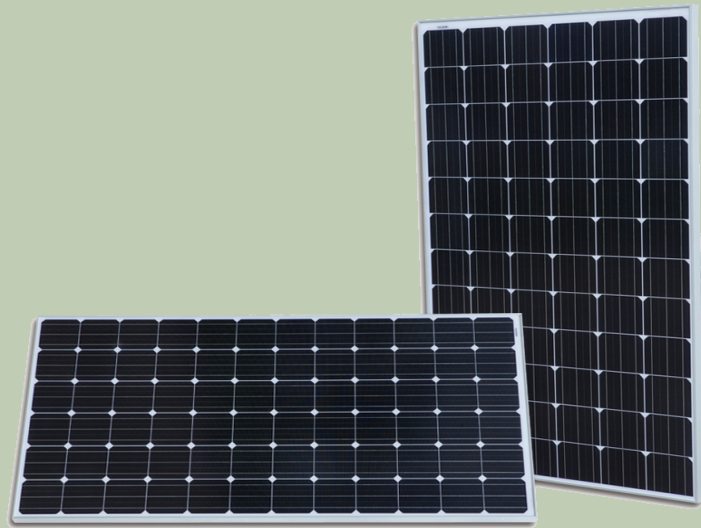

## MODULE FEATURE



High efficiency:

Strict quality control to make module efficiency up to 16.8%



Low light performance

High transparent low iron tempered glass and effective cells to make modules can be used at low light condition



Load Capacity

The whole module passed 2400Pa of wind load and 5400Pa of snow load capacity



Harsh environment adaptability

Passed the test of salt spray resistance by TUV

## Industrial Liner Warranty

10 years products warranty ,25years power guaranty

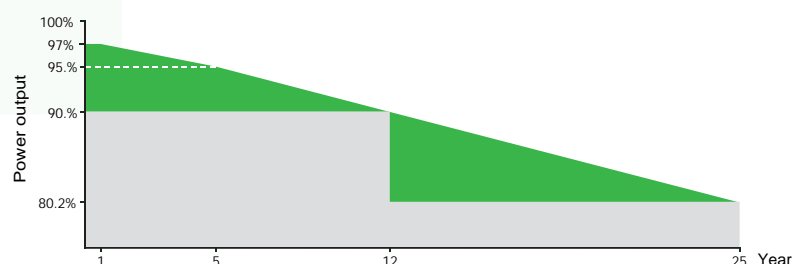

## Product Appearance

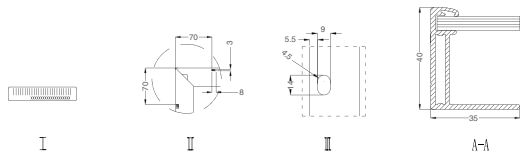
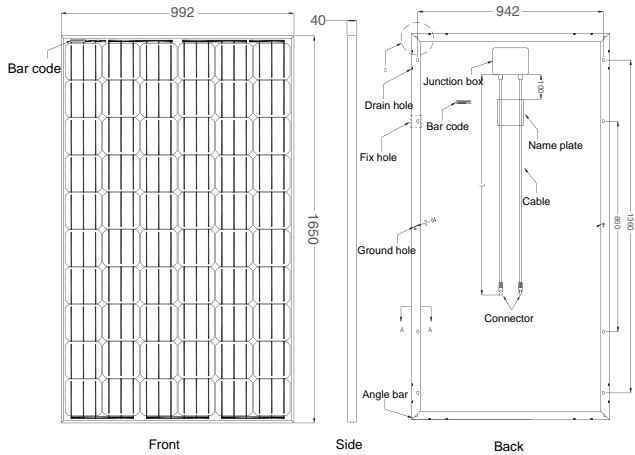

Power measurement tolerance:  $\pm 3\%$

## Liner Graph

Current, voltage and power voltage

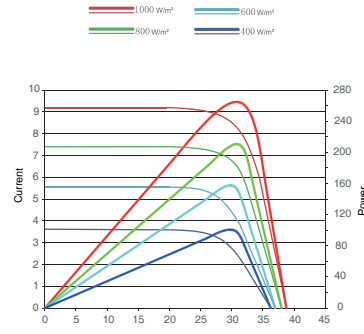

Temperature coefficient

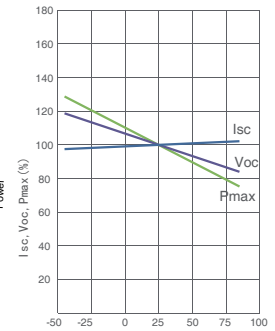

## Physical Data

Cell Tech.	mono 156*156(6in.)
No. of Cells	60 (6×10)
Module Size	1650×992×40mm (65.00×39.05×1.57 in.)
Module Weight	19.0kgs/41.9lb
Front Glass	3.2mm ,high transparent,low iron,tempered
Frame	Anodized aluminum alloy
Junction Box	IP67
Connector	4.0mm2/900mm

## Electrical Data

Module	CH-HS255M		CH-HS260M		CH-HS265M		CH-HS270M		CH-HS275M	
	STC	NOCT	STC	NOCT	STC	NOCT	STC	NOCT	STC	NOCT
Maximum Power (Pmax)	255Wp	189Wp	260Wp	193Wp	265Wp	197Wp	270Wp	201Wp	275Wp	205Wp
Maximum Power Voltage(Vmpp)	30.8V	28.6V	30.9V	28.7V	31.2V	29.0V	31.4V	29.3V	31.6V	29.6V
Maximum Power Current(Imp)	8.28A	6.60A	8.42A	6.71A	8.50A	6.78A	8.60A	6.85A	8.70A	6.93A
Open Circuit Voltage(Voc)	37.8V	35.0V	37.9V	35.1V	38.2V	35.4V	38.4V	35.6V	38.5V	36.0V
Short circuit Current(Isc)	8.96A	7.21A	9.10A	7.32A	9.19A	7.39A	9.28A	7.45A	9.40A	7.54A
Module Efficiency at STC(%)	15.58%		15.89%		16.19%		16.50%		16.80%	
Operating Temperature	-40°C~+85°C									
Maximum System Voltage	1000VDC (IEC)									
Maximum Series Fuse Rate	15A									
Power Tolerance	0~+3%									
Temperature coefficients of Pmax	-0.41%/°C									
Temperature coefficients of Voc	-0.29%/°C									
Temperature coefficients of Isc	0.04%/°C									
NOCT	45±2°C									

STC: Irradiance 1000W/m<sup>2</sup> Cell Temperature 25°C AM=1.5

NOCT: Irradiance 800W/m<sup>2</sup> Ambient Temperature 20°C AM=1.5

Wind Speed 1m/s