

240-260 Watt

MONO CRYSTALLINE MODULE 72x(156mmx130mm)

www.risenenergy.com
THE POWER OF RISING VALUE

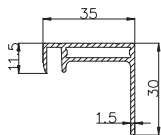

Electrical Characteristics

Model	Pm(Wp)	Tolerance	Vm(V)	Im(A)	Voc(V)	Isc(A)
SYP240M	240W	+3%	35.4	6.78	44.2	7.54
SYP245M	245W	+3%	35.7	6.87	44.6	7.64
SYP250M	250W	+3%	36.0	6.95	45.0	7.73
SYP255M	255W	+3%	36.2	7.05	45.2	7.84
SYP260M	260W	+3%	36.4	7.15	45.4	7.95

Valued at STC (AM 1.5, 1000W/m², 25°C)

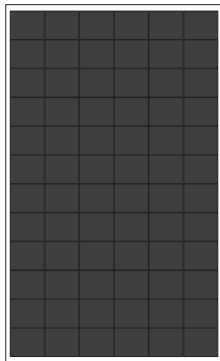
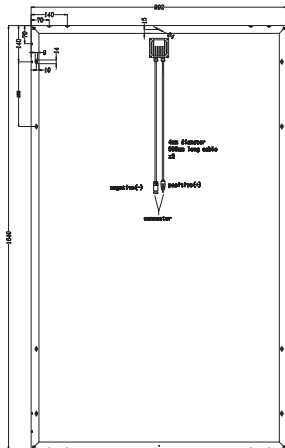

Specifications

- Number of mono crystalline solar cell 72pcsx(156mmX130mm)
- Aluminum frame, dimension 1640x992x35mm
- Weight 18.5kg
- Temperature coefficient of VOC(β) = -0.39%/°C
- Temperature coefficient of ISC(α) = +0.033%/°C
- Temperature coefficient of Pmax = -0.44%/°C
- Bypass diodes to reduce loss in partial shadow
- IP65
- CE Standard
- Performance test data for each module