

# VPS PV MODULE

## 260~280watt

5inch 96cells  
Upgraded Warranty

**DuraFlex™**



5MA

### Electrical Characteristics

	SRP-265-5MA	SRP-270-5MA	SRP-275-5MA	SRP-280-5MA	Unit
Rated Power	265	270	275	280	W
Power Tolerance	(0,+4.99)	(0,+4.99)	(0,+4.99)	(0,+4.99)	W
Rated Maximum Power	269.99	274.99	279.99	284.99	W
Module Efficiency (ηm)	15.76%	16.06%	16.36%	16.66%	%
Open Circuit Voltage(Voc)	60.29	60.96	61.25	61.54	V
Short Circuit Current (Isc)	5.71	5.75	5.83	5.91	A
Maximum Power Voltage (Vmp)	49.73	50.78	51.36	51.55	V
Maximum Power Current (Imp)	5.33	5.32	5.35	5.43	A
Maximum System Voltage	1000 (TUV), 600 (UL)				V
Maximum Series Fuse Rating	10				A

STC: Irradiance 1000 W/m<sup>2</sup>, module temperature 25°C, AM=1.5;  
Power measurement tolerance: +/-3%

### Temperature Characteristics

Pmax Temperature Coefficient	-0.43 %/°C
Voc Temperature Coefficient	-0.35 %/°C
Isc Temperature Coefficient	+0.04 %/°C
Operating Temperature	-40~+85 °C
Nominal Operating Cell Temperature (NOCT)	45±2 °C

### Packing Configuration

Container	20'GP	40'GP	40'HC
Pieces per pallet	N.A	N.A	26
Pallets per container	N.A	N.A	28
Pieces per container	N.A	N.A	728

### Current-Voltage & Power-Voltage Curve (SRP-260-5MA)

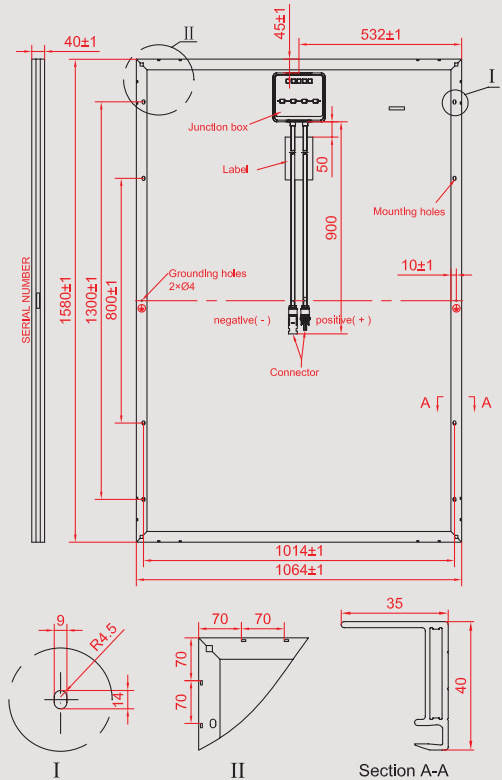
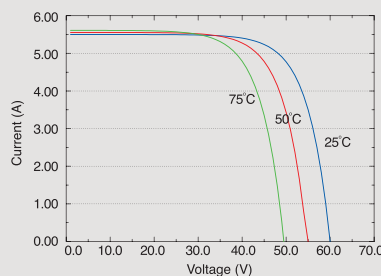
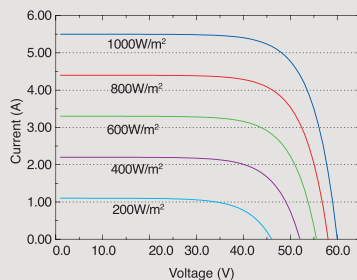

\* All Dimensions in mm

\* The above drawing is a graphical representation of the product.

### Mechanical Specifications

External Dimensions	1580 x 1064 x 40 mm
Weight	20.0kg
Solar Cells	Monocrystalline 125 x 125mm (96pcs)
Front glass	3.2 mm tempered glass, low iron
Frame	Anodized/ Electrophoretic aluminum alloy
Junction Box	IP65/IP67
Output Cables	4.0 mm <sup>2</sup> , symmetrical lengths 900mm
Connector	MC4 Compatible
Maximum Snow Load	550kg/m <sup>2</sup>
Maximum Wind Load	200km/h
Hailstone Impact Test	80km/h for 25mm ice ball