

# LINUO POWER SOLAR MODULES

Shandong Linuo Photovoltaic Hi-tech Co., Ltd.  
Add: No. 30766 East Jingshi Road, Jinan 250103, China.  
Tel: +86-531-88729696 / 88729106 / 88729770  
E-mail: pv@linuo.com  
Web: www.linuopower.com

## LN300(36)P-4 (310-325W)

Poly / 4 Busbar / 72pcs

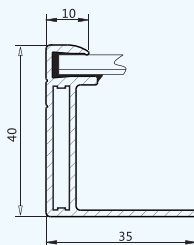
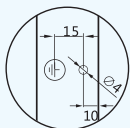
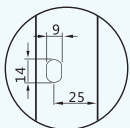
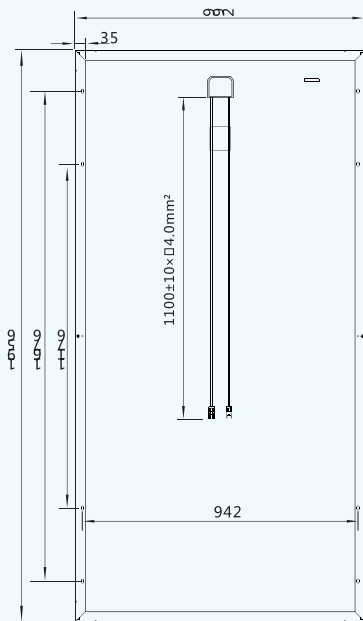
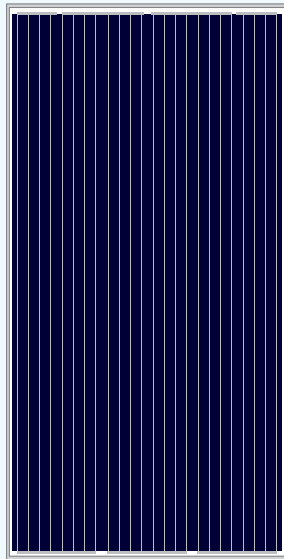

### Key Features

- Power output : Positive tolerance of up to 5W
- 100%EL 2 times-inspection ensures modules are defect free
- 25 year irrevocable warranty insurance-Solarsafe
- Anti-reflective and self-cleaning surface reduces power loss from dirt and dust
- Certified to withstand increased snow loads of up to 5400Pa and wind loads of up to 2400Pa
- High performance and power output in low solar irradiation
- High salt and ammonia resistance certified by TUV Nord
- Top-Ranking in STS Long-term Test

### Comprehensive Certificates

- IEC61215, IEC61730, UL1703,
- TUV, UL, PV Cycle, JET, INMETRO, CEC, MCS, CE, IEC
- ISO9001:2008
- ISO14001:2004
- OHSAS 18001:1999

### Superior Warranty

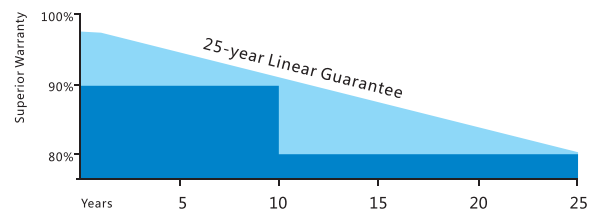

### 25-year Linear Power Output Warranty

In the first year of warranty, the peak power of poly-crystalline module should be no less than 97.5% of the rated power (Pmax.) and 96.5% for mono-crystalline module. At the end of the 25th year, power of modules should be at least 80% of rated power. The annual decline in performance is 0.70% maximum for poly-crystalline modules and 0.68% for mono-crystalline modules.

# LINUO POWER

# SOLAR MODULES

Shandong Linuo Photovoltaic Hi-tech Co., Ltd.  
 Add: No. 30766 East Jingshi Road, Jinan 250103, China.  
 Tel: +86-531-88729696 / 88729106 / 88729770  
 E-mail: pv@linuo.com  
 Web: www.linuopower.com

## LN300(36)P-4 (310-325W)

Poly / 4 Busbar / 72pcs

### Electrical Parameters@STC

Pmax (W)	Umpp (V)	Impp (A)	Uoc (V)	Isc (A)	FF	Module Efficiency	Max System Voltage	Max Series Fuse
310	37.13	8.35	44.99	8.97	76.83%	15.98%	1000V	15A
315	37.37	8.43	45.04	9.08	77.03%	16.23%	1000V	15A
320	37.52	8.53	45.17	9.16	77.35%	16.49%	1000V	15A
325	37.75	8.61	45.30	9.26	77.48%	16.75%	1000V	15A

### Temperature Coefficient

Temperature Cycling Range : -40°C ~ +85°C  
 Norminal Operating Cell Temperature : 46±2 °C  
 Temperature Coefficient of Isc : 0.044%/°C  
 Temperature Coefficient of Voc : -0.317%/°C  
 Temperature Coefficient of Pmax : -0.423%/°C

### Mechanical Data

Module Dimension : 1956×992×40mm  
 Weight : 23.5kg  
 Snow/Wind Load : 5400/2400 Pa  
 Number of Cells : 72pcs  
 Thickness of Glass : 4.0mm  
 Junction Box: IP67, 3 Diodes  
 Connector: MC4 Compatible, IP67

### Guarantee

10-year warranty on materials & workmanship  
 25-year linear power output warranty

### Packaging Configuration

Modules Per Pallet: 27pcs  
 Modules Per 40' HQ : 594pcs

### 310W Poly Module I-V Curve

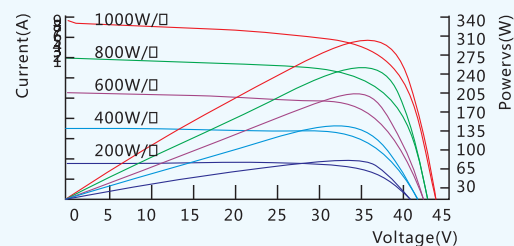
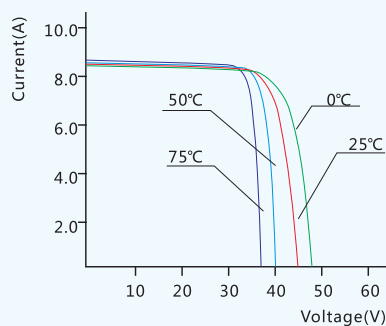

STC: Irradiance 1000W/m<sup>2</sup>    Temperature 25°C    AM=1.5  
 NOCT: Irradiance 800W/m<sup>2</sup>    Temperature 20°C    Wind Speed 1m/s



Specifications subject to technical changes and tests, Linuo Power reserves the right of final interpretation

To create value to customers