

Polycrystal Solar Cell Modules
HTM265/270/275/280
PA-60

Reliable Quality

0~+3% positive tolerance output warranty
 EL full inspection for twice effectively eliminates defects of products
 Optimize module current profile, improve system-side power generation



Module Characteristics



5 Busbar Photovoltaic Cells

5 busbar solar cell adopts new technology to improve the efficiency of modules, offers a better aesthetic appearance, making it perfect for rooftop installation



High Output Power

Polycrystalline 60-cell module achieves a power output up to 280W



Anti-PID Characteristics

Ensure large-scale production polycrystal module pass PID test



Low-light Performance

Advanced glass and surface texturing allow for excellent performance in low-light environments



Load Capacity

Entire module certified to withstand high wind loads (2400 Pascal) and snow loads (5400 Pascal)



Harsh Environment Adaptation

High salt mist and ammonia resistance certified by TUV NORD

Industry-leading Linear Quality Warranty

10-year material technology quality warranty•25-year linear quality warranty

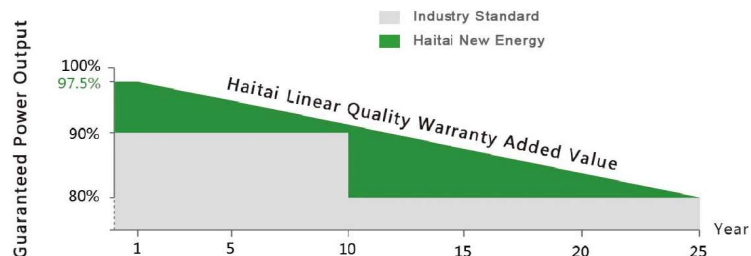

Module Dimensions(mm)

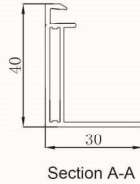
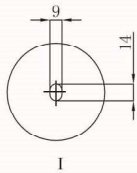
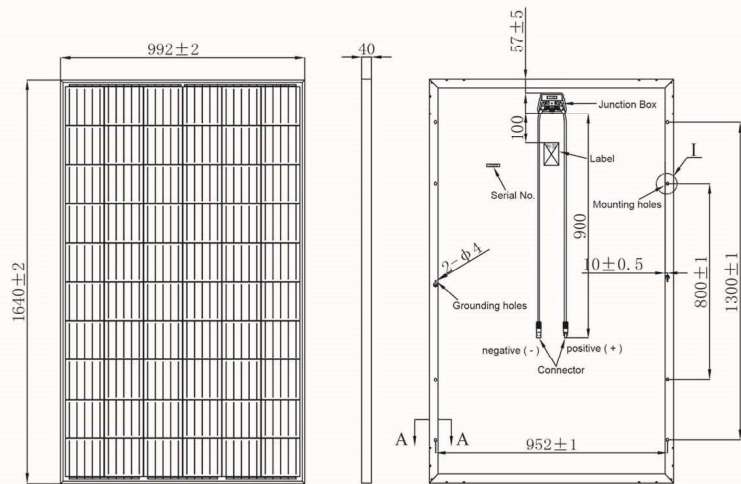

I-V Curve

Current-Voltage Curve (280W)

Power-Voltage Curve (280W)

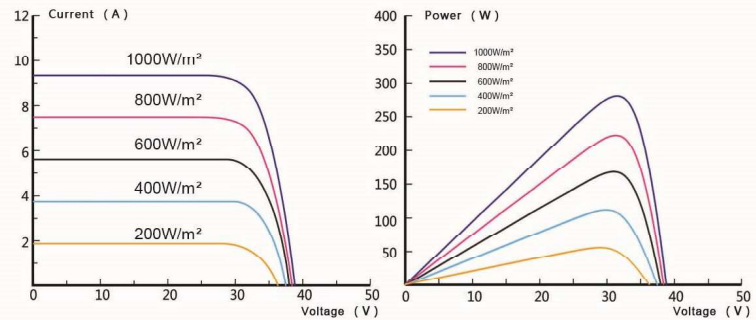

Structure Parameter

Cell Type	156.75x156.75mm Polycrystal
Cell Orientation	60 (6x10)
Module Dimensions	1640x992x40mm
Weight	18.5kg
Front Cover	3.2mm high transmittance, reinforced glass
Back Sheet	Anti-aging film
Frame Material	Anodized aluminum alloy
Junction Box	Protection class IP67
Cable	4.0mm ² photovoltaic special cable
Connector	MC4 compatible connector

Packaging Capacity

Each box capacity: 26 pcs

Container load capacity per 40 feet: 728 pcs

Electric Characteristics

Module Type	HTM265PA-60		HTM270PA-60		HTM275PA-60		HTM280PA-60	
	STC	NOCT	STC	NOCT	STC	NOCT	STC	NOCT
Test Conditions								
Maximum Output Power(P _m)	265W	195W	270W	200W	275W	203W	280W	207W
Maximum Power Voltage(V _{mp})	30.93V	29.00V	31.15V	29.37V	31.40V	29.52V	31.75V	29.79V
Maximum Power Current(I _{mp})	8.57A	6.73A	8.67A	6.81A	8.76A	6.88A	8.82A	6.95A
Open-circuit Voltage(V _{oc})	37.98V	35.85V	38.19V	36.24V	38.55V	36.51V	38.91V	36.97V
Short-circuit Current(I _{sc})	9.10A	7.22A	9.17A	7.26A	9.23A	7.31A	9.30A	7.36A
Module Conversion Efficiency(STC)	16.29%		16.60%		16.90%		17.21%	
Maximum System Voltage	1000V							
Operating Temperature	-40°C~+85°C							
Temperature Coefficient(P _m)	-0.394%/°C							
Temperature Coefficient(V _{oc})	-0.307%/°C							
Temperature Coefficient(I _{sc})	0.04%/°C							
Cell Rated Operating Temperature(NOCT)	45±2°C							

STC : ☀️ Light intensity 1000W/m² 🌡️ Environment temperature : 25°C 🌬️ Air quality : AM1.5
 NOCT : ☀️ Light intensity 800W/m² 🌡️ Environment temperature : 20°C 🌬️ Air quality : AM1.5 🌀 Wind speed : 1m/s