

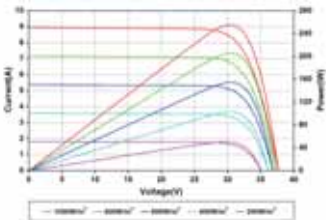

## Futuresolar Standard 60Cells Poly Solar Panel

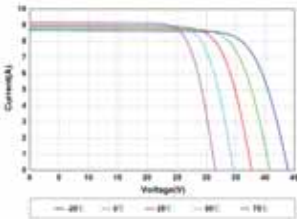

Current-Voltage and Power-Voltage Curves at Different Irradiances



Current-Voltage Curves at Different Temperatures

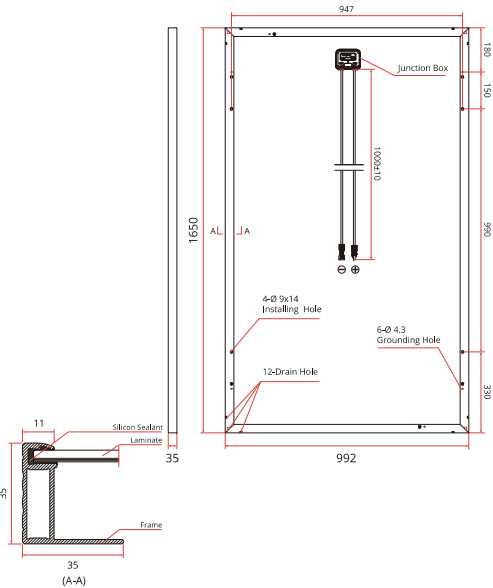

ELECTRICAL CHARACTERISTICS	AT STC							
Nominal Power ( $P_{max}$ )	240W	245W	250W	255W	260W	265W	270W	275W
Open Circuit Voltage ( $V_{oc}$ )	37.7V	37.9V	38.0V	38.1V	38.2V	38.3V	38.4V	38.5V
Short Circuit Current ( $I_{sc}$ )	8.57A	8.66A	8.75A	8.83A	8.90A	8.98A	9.06A	9.15A
Voltage at Nominal Power ( $V_{mp}$ )	29.9V	30.1V	30.3V	30.5V	30.7V	30.9V	31.1V	31.3V
Current at Nominal Power ( $I_{mp}$ )	8.03A	8.14A	8.26A	8.37A	8.47A	8.58A	8.69A	8.79A
Module Efficiency (%)	14.75	15.06	15.37	15.67	15.98	16.29	16.60	16.90
Operating Temperature	-40°C to +85°C							
Maximum System Voltage	1000V DC							
Fire Resistance Rating	Class C (IEC61730)							
Maximum Series Fuse Rating	15A							

STC: Irradiance 1000W/m<sup>2</sup>, Cell temperature 25°C, AM1.5