



## PV Module S6-60



**High Efficiency PV Modules**

### Strengths

- Positive power tolerance
- High Efficiency Mono Crystalline Modules
- TUV Certifications:
  - EN IEC 61215 : 2005
  - EN IEC 61730-1 : 2004 / 2007
  - EN IEC 61730-2 : 2004 / 2007
- Qualified for Extended Mechanical Load test up to 5400 Pascal : EN IEC 61215
- Withstands heavy loading due to snow & ice; Has higher safety margin for storm weather and gale winds
- UL Certification: ANSI / UL 1703 (USA & Canada)
- California Energy Commission Listed

**Product Guarantee :** 5 years

**Limited Power Warranty :** 90% @ 12 Years  
80% @ 25 Years

### Typical Electrical Characteristics

		S6-60						
Type		225	230	235	240	245	250*	
Max Power	Pmp (W)	225	230	235	240	245	250*	
Power Tolerance	(W)	+0 to 4.9 Wp or ± 2.5%						
Max Power Voltage	Vmp(V)	28.63	29.24	29.48	29.60	29.80	30.01	
Max Power Current	Imp (A)	7.93	7.87	8.00	8.12	8.25	8.33	
Open Circuit Voltage	Voc (V)	37.50	37.44	37.44	37.50	37.50	37.54	
Short Circuit Current	Isc (A)	8.52	8.49	8.52	8.58	8.73	8.76	
Electrical parameters tolerance		±5%						
Max System Voltage (Europe / USA)	VDC	1000/600						
Number, type and arrangement of cells		60, Mono-Crystalline, 10 x 6 Matrix						
Cell Size		6" x 6" / 156 x 156 mm						
No. of By-pass Diodes		3						
Max Series Fuse	(A)	15						
Pm Temperature Co-efficient (γ)	(%/°C)	-0.45						
Isc Temperature Co-efficient (α)	(%/°C)	+0.035						
Voc Temperature Co-efficient (β)	(%/°C)	-0.365						
NOCT at STC	(°C)	45±1						

### Mechanical Characteristics

Junction Box		Tyco
Type of connector		Tyco
Dimensions (L x W x Th)	mm	1657 x 987 x 42
Weight	Kg	19.0
No. of Drain Holes in Frame		12
Glass Type and Thickness		3.2 mm Thick, Low iron, Tempered

### Packing Configuration

Packing Configuration	24 Modules in each pallet
1 * 20 Ft	144 Modules
1 * 40 Ft STD	336 Modules
1 * 40 Ft HQ	672 Modules

### Absolute Ratings

Operating Temperature	(°C)	-40 ~ +85
Storage Temperature	(°C)	-40 ~ +85

NOTE: The data presented may change due to further improvements in the product.  
\* Approved for IEC standards only.

# PV Module S6-60

## Typical I-V Curves

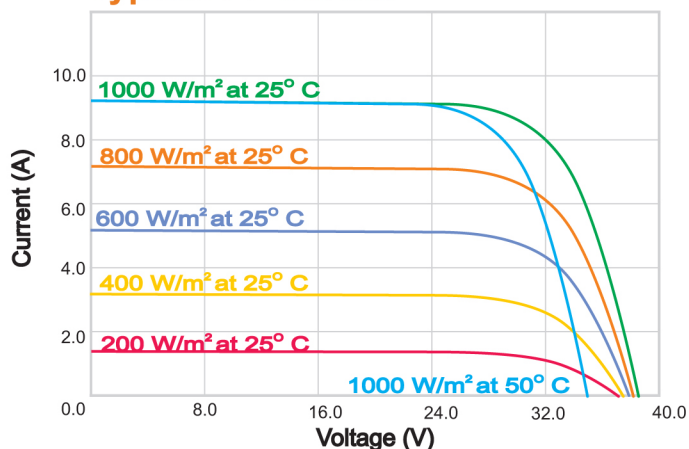

Current/voltage dependence on irradiance and module temperature. These I-V curves indicate the effect of temperature and light intensity on module Performance.

## Dimensions

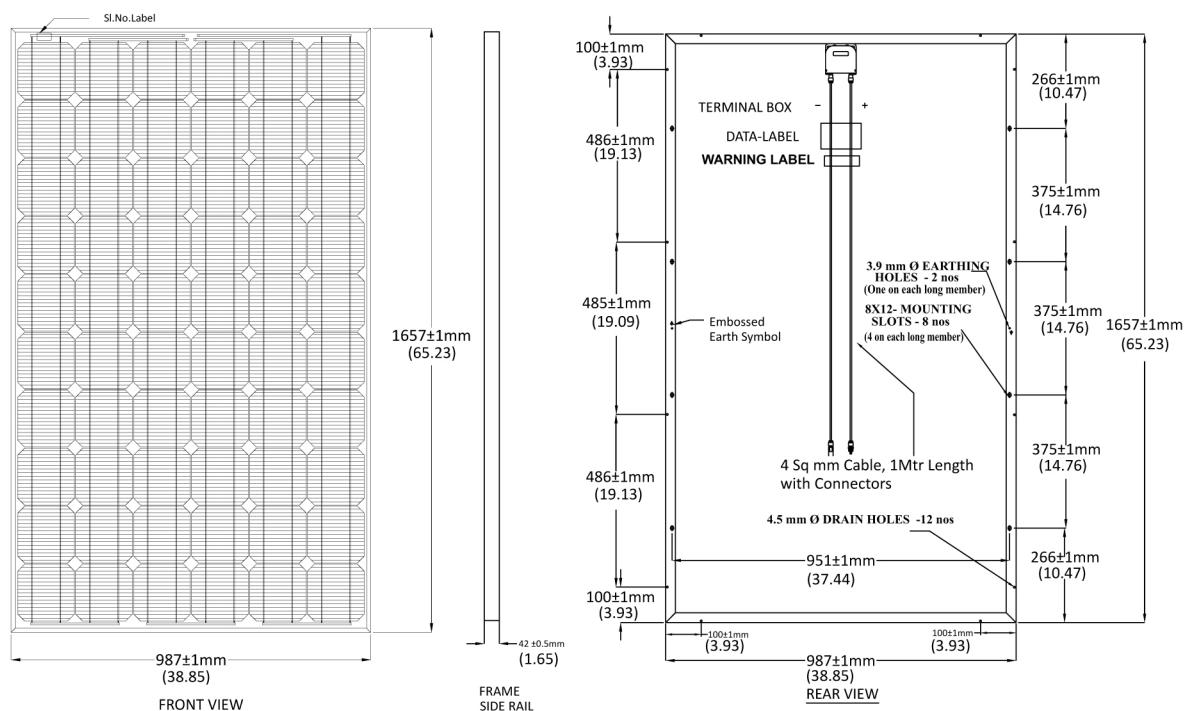

Dimensions given in Parentheses are in inches

## PV Module Products

- M6-72 Family Series (305Wp to 125Wp) : M6-72, M6-60, M6-54 & M6-36 - Certified for IEC Standards  
M6-60: Certified for UL (USA & Canada) Standard; M6-72: Certification for UL (USA & Canada) is in Progress
- S6-60 Family Series (250Wp to 120Wp) : S6-60, S6-54 & S6-36 - Certified for IEC Standards  
S6-60 - Certified for UL (USA & Canada) Standard
- S6-72 Family Series (300Wp to 285Wp) : Certification for IEC & UL (USA & Canada) Standards
- S5-96 Family Series (250Wp to 75Wp) : S5-96, S5-72, S5-60, S5-54 & S5-36 - Certified for IEC Standards



# SILICON LEAF

Renewable Energy - An ISO 9001 : 2015 Certified Company