

LINK ENERGY

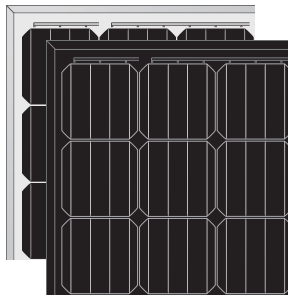

▲ Mono is the future ▲

MARS 60-280W
260 - 290W
MONOCRYSTALLINE

With the first Monocrystalline power plant being built 30 years ago, and continuing to run to date, this is why we are an advocate of monocrystalline solar technology. Link Energy selected Monocrystalline as its primary product due to its longevity effectiveness and better return of investment.

▲ PID Resistance : eliminating the possibility of Potential Induced Degradation

4 Bus Bar : improves the efficiency of the panels and better appearance

Highest efficiency up to 17.11%

Certified to withstand increased snow loads of up to 5400Pa

Good pressure resistance and able to bear 2400Pa wind load

Outstanding efficiency in low light conditions

Sorted by Amperage, this reduces losses and maximises output ▲

Mechanical Details

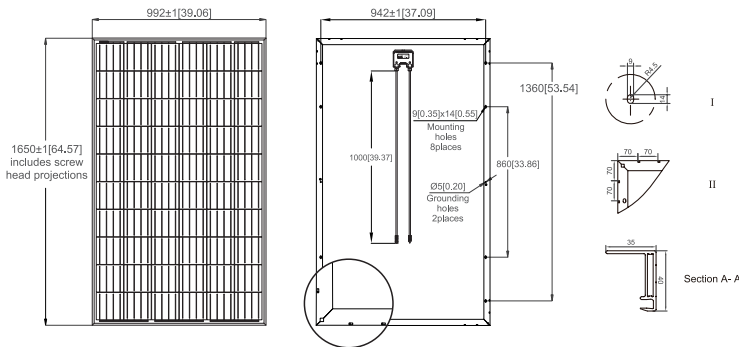

Dimensions in brackets are in inches.
Un-bracketed dimensions are in millimeters.
Unit: mm [in.]

DATA (STC)*

ELECTRICAL DATA (STC*)

Peak Power Watts- P_{MAX} (Wp)	260	265	270	275	280
Maximum Power Voltage- V_{MPP} (V)	31.80	31.90	32.00	32.10	32.20
Maximum Power Current- I_{MPP} (A)	8.20	8.32	8.44	8.57	8.70
Open Circuit Voltage- V_{OC} (A)	37.90	38.00	38.10	38.20	38.30
Short Circuit Current- I_{SC} (A)	8.87	8.96	9.06	9.15	9.33
Module Efficiency η_m (%)	15.9	16.2	16.5	16.8	17.1

* STC: Irradiance 1000 W/m², Cell Temperature 25°C, Air Mass AM1.5.

MECHANICAL DATA

Solar cells	Monocrystalline 156.75 × 156.75 mm (6 inches)
Cell orientation	60 cells (6 × 10)
Module dimensions	1650 × 992 × 35/40 mm (65.0 × 39.1 × 1.4/1.6 inches)
Weight	18.6 kg (41 lb)
Glass	Tempered Glass, Thickness: 3.2(mm)
Frame	Black / Silver
Backsheet	Black / White
J-Box	IP67
Cables	Product Brand: Zhejiang Jiaming Tianheyuan Photovoltaics Technology Co., Ltd. Product Model: PV1-F, 1×4.0 mm ² , 1800 V DC, -40 to +90°C
Connector	Product Brand: MC Product Model: 32.0016P0001-UR (female cable coupler MC4) 32.0017P0001-UR (male cable coupler MC4)

I-V Curves

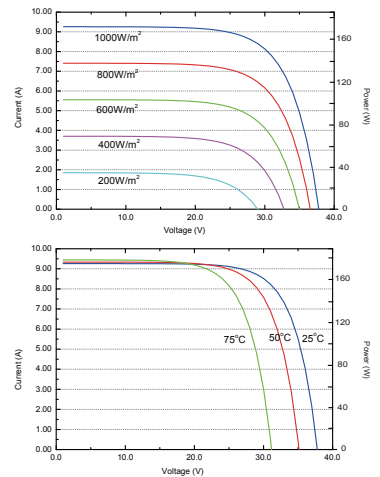

10

10 Years
Product Warranty

25

25 Years
Performance Warranty

Linear Performance Warranty

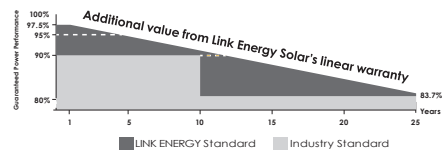

MAXIMUM RATINGS

Operational Temperature	-40~+85°C
Maximum System Voltage	1000V DC (IEC)
Max Series Fuse Rating	15A

TEMPERATURE RATINGS

Nominal Operating Cell Temperature (T_{NOCT})	44°C (± 2°C)
Temperature Coefficient of P_{MAX}	- 0.39%/°C
Temperature Coefficient of V_{OC}	- 0.29%/°C
Temperature Coefficient of I_{SC}	0.05%/°C



POWERARK SOLAR Pty Ltd
Unit CB/391 Park Rd,
Regents Park NSW 2143
www.link-energy.com.au
(02) 9643 2492