

## BYD's Dream All Human Hope

Changing human dependence on non-renewable energy as the starting point, with three green dreams of electric vehicle, energy storage station and solar farm, BYD looks forward to helping more countries and people to get rid of fossil energy over consumption crisis and environmental pollution, and strive to leave offspring a beautiful and clean world to live in.



In the daytime, solar panels capture solar energy like plants. At night, energy storage station transports the stored energy, like solar energy, wind energy, tidal energy, to thousands of families smoothly.

The electric vehicle, shuttling on the streets and lanes, is of zero emission, zero pollution.

Is this a dream?

This is the green dream of BYD and even all human beings.

Is this a dream?

No. We are already seeing it approaching us.

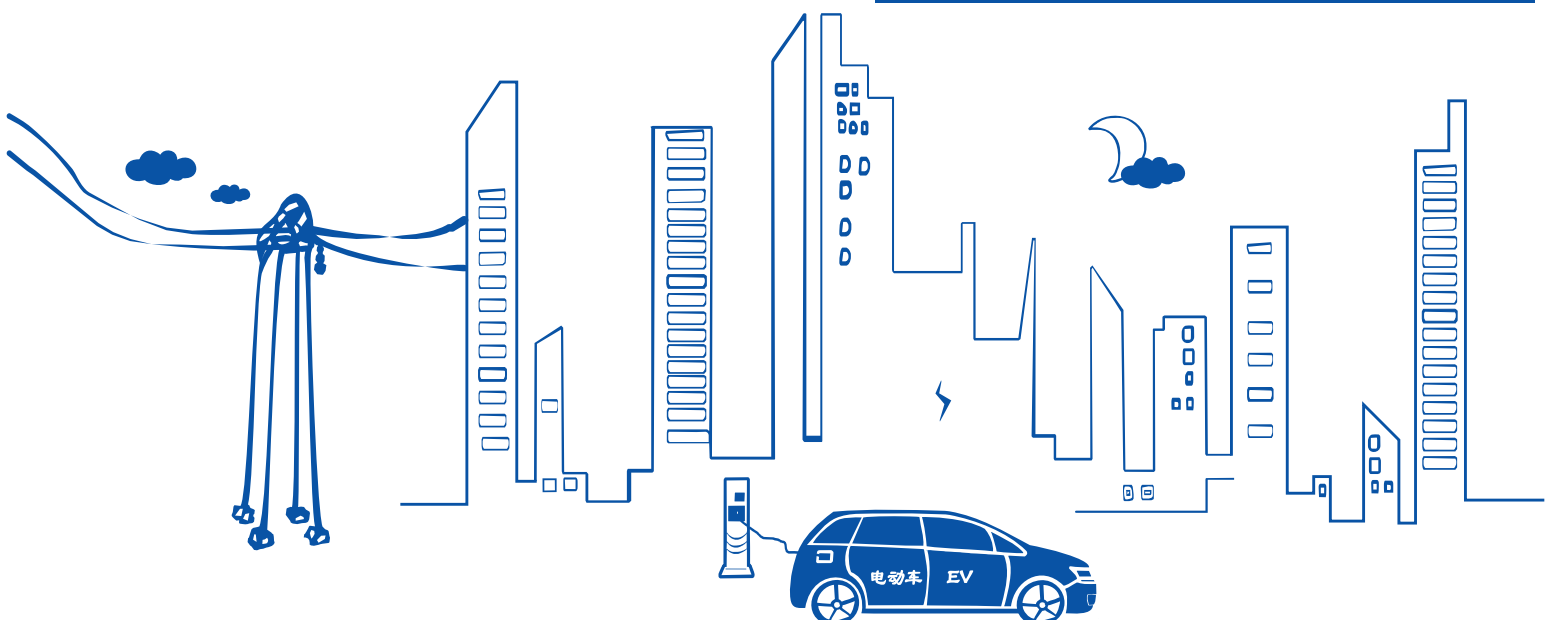



21.8%

Average cell efficiency up to 21.8%  
Excellent optical performance

0-5W

Power tolerance 0-5W  
Reliability for output performance

10  
Years

10 years for product  
25 years linear Warranty

Grid

Residential roof top systems  
On/Off-grid commercial systems  
On/Off-grid utility systems

3<sup>rd</sup>

Design loads: 3600 Pa for positive  
(downward) and 1600 Pa for  
negative (upward)

Safety factors  $\gamma_m$ : 1.5

Certification

IEC61215-1(ed.1)  
IEC61215-1-1(ed.1)  
IEC61215-2(ed.1)  
IEC61730-1(ed.2)  
IEC61730-2(ed.2)

# BYD Monocrystal Silicone Modules

**BYD M6K-36-5BB 355W-375W**

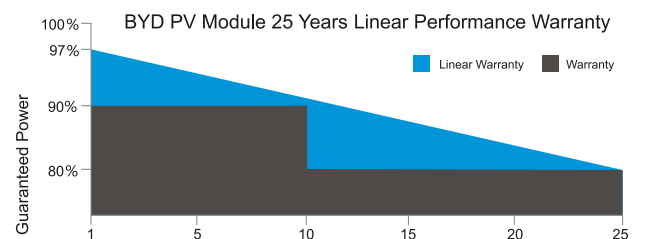

# BYD M6K-36-5BB 355W-380W

The country of manufacture is China

## Mechanical Properties

Cell Type	156.75mm*156.75mm
Number of Cells	72pcs ( 6*12 )
Dimension	1962mm*992mm*35mm
Weight	22.1Kg
Front/Glass	3.2mm tempered glass with AR Coating
Frame	Anodized aluminum alloy
Junction Box	IP67(3 Diodes)
Cable Type	4.0mm <sup>2</sup> 1200mm
Connector	PV-ZH202B

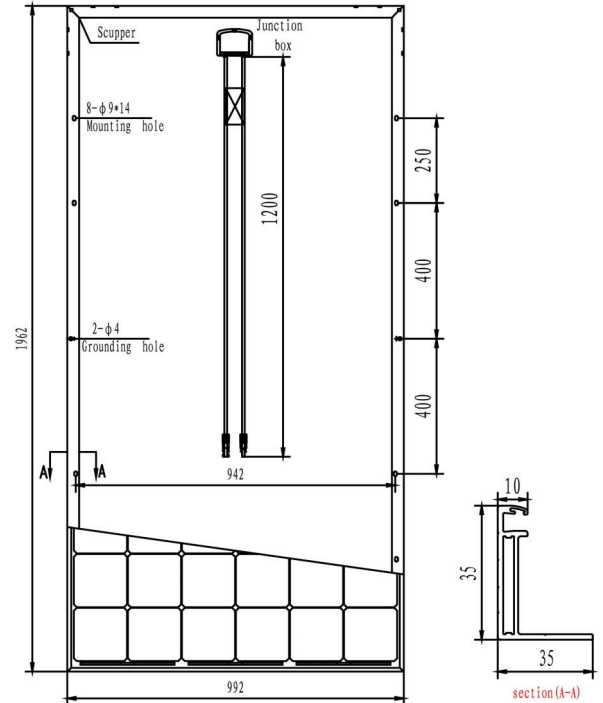

## Temperature Coefficient

Temp. Coeff. of Pmax (TK Pmax)	-0.343%/°C
Temp. Coeff. of Voc (TK Voc)	-0.257%/°C
Temp. Coeff. of Isc (TK Isc)	0.04%/°C

## Packing Information

Packing Type	40' HQ
Piece/Pallet	30
Pallet/Container	22
Piece/Container	660

## Electrical Properties

Module Type	BYD355M6K-36	BYD360M6K-36	BYD365M6K-36	BYD370M6K-36	BYD375M6K-36	BYD380M6K-36	BYD385M6K-36
Open Circuit Voltage (Voc) (V)	47.97 V±5%	48.3 V±5%	48.63 V±5%	48.96 V±5%	49.29 V±5%	49.62 V±5%	49.95 V±5%
Short Circuit Current (Isc) (A)	9.47 A±5%	9.53 A±5%	9.59 A±5%	9.65 A±5%	9.71 A±5%	9.77 A±5%	9.83 A±5%
MPP Voltage (Vmp)(V)	39.38 V	39.71 V	40.04 V	40.37 V	40.7 V	41.03 V	41.36 V
MPP Current (Imp) (A)	9.02 A	9.07 A	9.12 A	9.17 A	9.22 A	9.27 A	9.32 A
Module Efficiency (%)	18.24%	18.50%	18.75%	19.01%	19.27%	19.52%	19.78%
Operating Temperature (°C)	-40°C~+85°C						
Maximum System Voltage (V)	1500 (VDC)						
Maximum Series Fuse Rating (A)	15 A						
Fire safety	Class C						
Power tolerance	0-5W						

\* Under Standard Test Conditions (STC) of irradiance of 1000 W/m<sup>2</sup>, spectrum AM 1.5 and cell temperature of 25°C.

## NOCT

Peak Power(Pmax)	260Wp	264Wp	268Wp	271Wp	275Wp	279Wp	282Wp
Open Circuit Voltage (Voc) (V)	44.3 V	44.6 V	44.9 V	45.2 V	45.5 V	45.8 V	46.1 V
Short Circuit Current (Isc) (A)	7.66 A	7.71 A	7.76 A	7.81 A	7.86 A	7.90 A	7.95 A
MPP Voltage (Vmp)(V)	36.5 V	36.8 V	37 V	37.3 V	37.6 V	37.8 V	38.08 V
MPP Current (Imp) (A)	7.13 A	7.18 A	7.23 A	7.27 A	7.32 A	7.36 A	7.41 A

# BYD COMPANY LIMITED.

ADD: Yan An Road, Kuichong, Longgang, 518119 Shenzhen, PEOPLE'S REPUBLIC OF CHINA