

Perc Mono PV Module

Mono



158.75mm

DHM60X 310W-325W

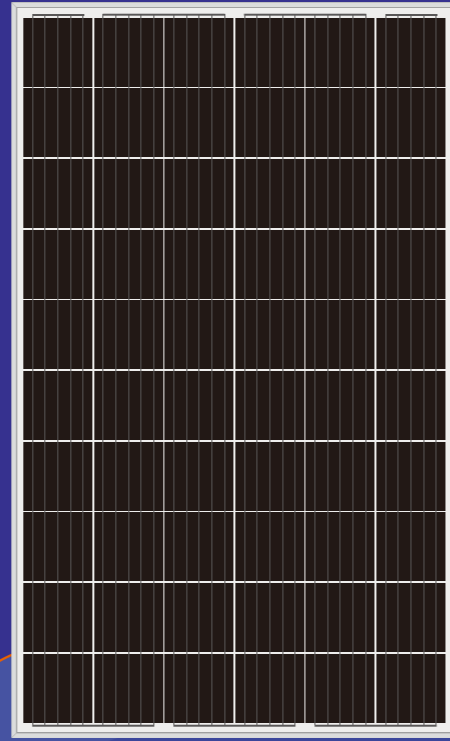

QUALITY GUARANTEE

LINEAR POWER OUTPUT GUARANTEE

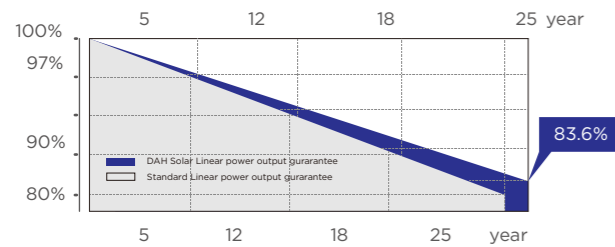

10 years 10-year material & technology warranty

25 years 25-year linear power output warranty

0~+5W

Positive Tolerance

19.48%

Max Module Eff.(%)

PRODUCT PERFORMANCE ADVANTAGE

- Select Grade A crystalline silicon solar cells, high-power output with cost-effective
- Preferred packaging materials and strict process technology, excellent PID free performance
- Certified by dust-sand,salt-mist, ammonia etc. weather resistance tests, strong environmental adaptability
- Larger size of light receiving area, higher solar panel power, lower system cost

Perc Mono PV Module DHM60X 310W-325W

Design

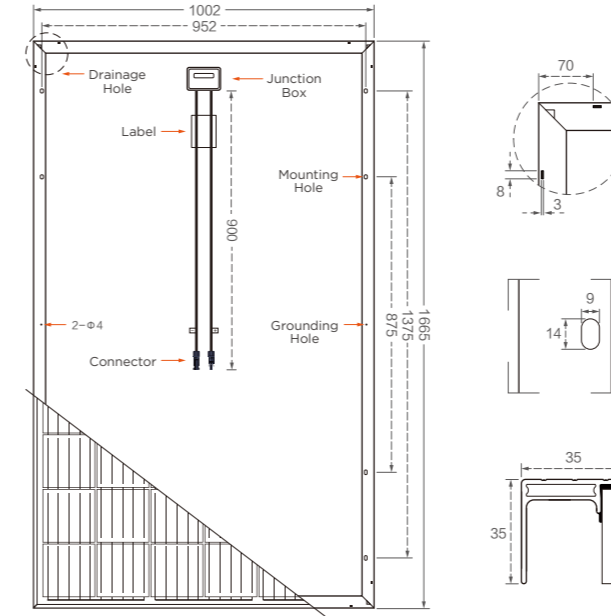

Mechanical Specification

Cells Type	Mono 158.75×158.75mm
Weight	19kg
Dimension (L×W×T)	1665×1002×35mm
Output Cables	Length 900mm, 4.0mm ²
No.of Cells	60(6×10)
Glass	3.2mm High Transmission, Antireflection Coating
Junction box	IP68, 3 Bypass Diodes
Connector	QC4 or MC4 compatible
Packing	30pcs/pallet, 400pcs/20GP, 910pcs/40HQ

Operating Parameters

Maximum system voltage	1000V/1500V DC
Operating Temperature	-40 ~ +85℃
Maximum series fuse rating	16A
Snow load, frontside	5400Pa
Wind load, backside	2400Pa
Nominal operating cell temperature	45℃±2℃
Application level	Class A

Electrical Characteristics(STC)

Module Type	DHM60X-310W-5BB	DHM60X-315W-5BB	DHM60X-320W-5BB	DHM60X-325W-5BB
Maximum Power (Pmax)	310W	315W	320W	325W
Open-circuit Voltage (Voc)	40.3V	40.5V	40.7V	40.9V
Maximum Power Voltage (Vmp)	33.0V	33.2V	33.4V	33.6V
Short-circuit Current (Isc)	9.89A	9.98A	10.07A	10.16A
Maximum Power Current (Imp)	9.40A	9.49A	9.59A	9.68A
Module Efficiency (%)	18.58%	18.88%	19.18%	19.48%
Power Tolerance	0~+5W			
Temperature Coefficient of Isc	0.048%/℃			
Temperature Coefficient of Voc	-0.28%/℃			
Temperature Coefficient of Pmax	-0.37%/℃			
Standard Test Environment	Irradiance 1000w/m ² , Cell temperature 25℃, Spectrum AM1.5			

Electrical Characteristics(NOCT)

Module Type	DHM60X-310W-5BB	DHM60X-315W-5BB	DHM60X-320W-5BB	DHM60X-325W-5BB
Maximum Power (Pmax)	231W	235W	239W	242W
Open-circuit Voltage (Voc)	37.4V	37.6V	37.8V	38.0V
Maximum Power Voltage (Vmp)	31.0V	31.2V	31.4V	31.6V
Short-circuit Current (Isc)	8.20A	8.33A	8.44A	8.54A
Maximum Power Current (Imp)	7.49A	7.56A	7.62A	7.66A
Standard Test Environment	Irradiance 800w/m ² , Cell temperature 20℃, Spectrum AM1.5, Wind speed 1m/s			



Top Runner of Smart PV Module

Factory Address: No.358 Tianhe Road, Luyang Industrial Park, Hefei City, Anhui, China
Office Address: Floor 1-3, 6#A, Gongtuo Xinglu Industrial Park, Hefei City, Anhui, China
Email: dhsolar@dh-solar.cn **Tel:** +86-551-65176633



Top Runner of Smart PV Module

Factory Address: No.358 Tianhe Road, Luyang Industrial Park, Hefei City, Anhui, China
Office Address: Floor 1-3, 6#A, Gongtuo Xinglu Industrial Park, Hefei City, Anhui, China
Email: dhsolar@dh-solar.cn **Tel:** +86-551-65176633