

\* V means 1500V module

HT72-156M-MC  
HT72-156M(V)-MC

Shanghai Aerospace Automobile  
Electromechanical Co., Ltd.  
website: www.ht-saae.com



Factory :  
Lianyungang ShenZhou New Energy Co., Ltd.  
Turkey HT Solar Energy Joint Stock Company

NEW

POWER OUTPUT

**375W / 380W**  
**385W / 390W / 395W**



- Module efficiency: 20.0%
- No. of Cells: 144 (6 × 24)
- Weight: 23.0kg
- Dimensions: 1967mm × 992mm × 40mm



• (Optional)  
Design of Water  
Leakage Trough

Monocrystalline  
196.75 × 78.375mm



Half cut cell technology can reduce the internal power loss and improve component overall power. Excellent heat dissipation avoids hot spot production.



MBB The optimized number and width of main gate lines, Maximize the light receiving area of components and Reduce component power consumption

10Ys  
Products  
Warranty



Designed for high voltage systems of up to 1500 VDC, increasing the string length of solar systems and saving on BoS costs

25Ys  
Warranty on  
power output



All the modules are sorted and packaged by amperage, reducing mismatch losses and maximizing system output.

EL

Microcrack resistant Double glass structure enhance reliability, triple EL tested of high quality control.

5W

Positive tolerance  
0/+5w guaranteed



Entire module certified to with stand extreme wind (2400 Pa) and snow loads (5400 Pa)

PID

PID Resistant

Comprehensive and first-rate certification system

IEC61215: 2016, IEC61730: 2016 Latest Standard  
ISO9001, ISO14001 and OHSAS18001,  
meeting the highest international standards  
Strict quality control



IEC 61215  
IEC 61730  
Regular Production  
Surveillance  
www.tuv.com

## Engineering Drawing

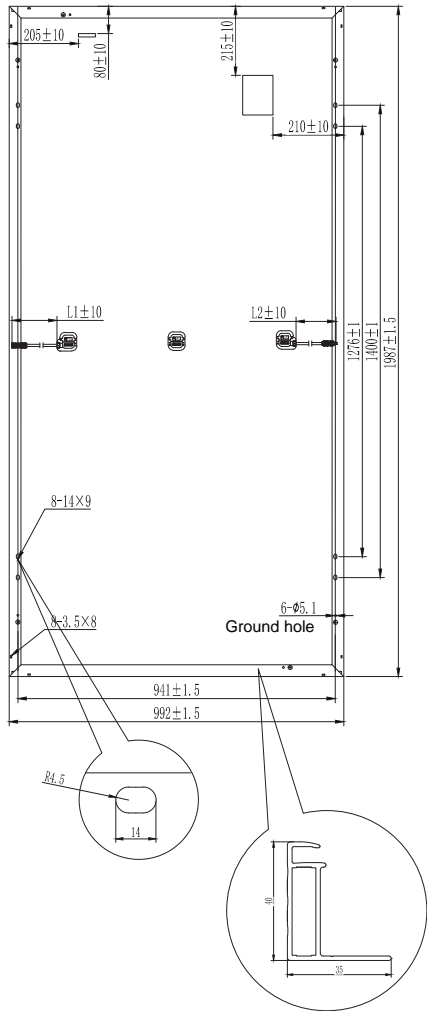

## Electrical Characteristics

Module	HT72-156M-MC / HT72-156M(V)-MC				
Maximum Power at STC (Pmax)	375W	380W	385W	390W	395W
Open-Circuit Voltage (Voc)	48.4V	48.6V	48.8V	49V	49.2V
Short-Circuit Current (Isc)	10.17A	10.26A	10.35A	10.44A	10.53A
Optimum Operating Voltage (Vmp)	40.2V	40.4V	40.6V	40.8V	41V
Optimum Operating Current (Imp)	9.34A	9.42A	9.5A	9.57A	9.64A
Module Efficiency	19.02%	19.28%	19.53%	19.79%	20.04%
Power Tolerance	0 ~ +5W				
Maximum System Voltage	1000V / 1500V DC (IEC)				
Maximum Series Fuse Rating	15A				
Operating Temperature	-40 °C to +85 °C				

\*STC: Irradiance 1000W/m<sup>2</sup>, module temperature 25, AM=1.5  
 Optional black frame or white frame module according to customer requirements

## NOCT

Module	HT72-156M-MC / HT72-156M(V)-MC				
Maximum Power	278W	281W	285W	289W	293W
Open Circuit Voltage (Voc)	45.7V	45.9V	46.1V	46.3V	46.5V
Short Circuit Current (Isc)	8.21A	8.28A	8.36A	8.43A	8.5A
Maximum Power Voltage (Vmp)	38V	38.2V	38.4V	38.6V	38.7V
Maximum Circuit Current (Imp)	7.32A	7.36A	7.42A	7.49A	7.57A
NOCT	45°C ± 2°C				

\*NOCT: Irradiance 800W/m<sup>2</sup>, ambient temperature 20°C, wind speed 1 m/s

## Mechanical Characteristics

Solar Cells	Monocrystalline 156.75 x 78.375mm
No. of Cells	144 (6 x 24)
Dimensions	1987mm x 992mm x 40mm
Weight	23.0kg
Front Glass	High transmission tempered glass
Frame	Anodized aluminium alloy
Junction Box	IP67
Cable	4mm <sup>2</sup> (IEC)
Connectors	MC4 / MC4 Compatible
Packaging Configuration	26pcs / box, 572pcs / 40'HQ Container

## Temperature Characteristics

Temperature Coefficient of Pmax	γ (Pm)	-0.39%/K
Temperature Coefficient of Voc	β (Voc)	-0.29%/K
Temperature Coefficient of Isc	α (Isc)	0.049%/K

## I-V Curves

Current-Voltage & Power-Voltage Curve

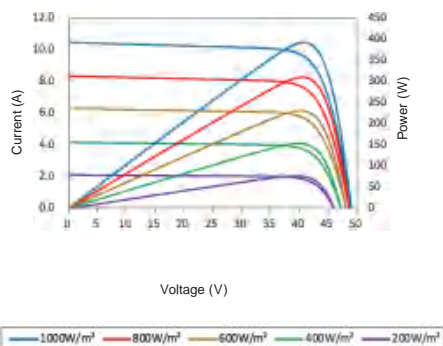

## Warranty

10-year product warranty  
 25-year warranty on power output  
 Specific information is referred to the product quality guarantee

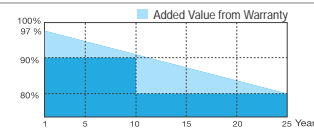

## Information Box