



Solar Modules MONOCRYSTALLINE



OPTIONAL:

WHITE BACKSHEET
or
BLACK BACKSHEET

M Series

300 W ▪ 305 W ▪ 310 W

- High efficiency, high safety, high reliability
- Highly transparent self-cleaning glass
- Resistant to environmental influences: Passed salt mist & ammonia test
- 5-busbar-technology
- German warranty



M Series

Electrical data under STC (Standard Test Conditions: 1000 W/m², 25 °C, AM 1.5)

| Parameter | Symbol | 300 W | 305 W | 310 W |
|-------------------------------|-----------|---------|---------|---------|
| Rated power | P_{max} | 300 W | 305 W | 310 W |
| Sorting limits of performance | | 0/+5 W | 0/+5 W | 0/+5 W |
| Voltage | U_{MPP} | 32.23 V | 32.42 V | 32.67 V |
| Open circuit voltage | U_{OC} | 39.65 V | 39.86 V | 40.08 V |
| Current | I_{MPP} | 9.31 A | 9.41 A | 9.49 A |
| Short-circuit current | I_{SC} | 9.84 A | 9.93 A | 10.01 A |
| Efficiency | | 18.37 % | 18.67 % | 18.97 % |

Temperature data

| | | |
|---------------------------------|----------------|------------|
| Power temperature coefficient | $T_k(P_{MPP})$ | -0.43 %/K |
| Voltage temperature coefficient | $T_k(U_{OC})$ | -0.325 %/K |
| Current temperature coefficient | $T_k(I_{SC})$ | 0.04 %/K |

Further information

| | |
|------------------------------------|----------------------------------------------------------------------------------------------------------|
| Number of cells | 60 monocrystalline cells |
| Max. system voltage | 1000 V |
| Reverse current loading capability | 15 A |
| Front cover | 3.2 mm (0.13 inches) tempered glass |
| Weight | 18.6 kg |
| Module connection | Junction Box protection class Ip67 4.0 mm ² , cable length approx.: 900 mm, MC4 compatible |
| Snow load | 5400 Pa $\hat{=}$ 550 kg/m ² |

12-year product warranty, 25-year linear performance warranty according to our additional warranty conditions for solar power modules of the "M" product series, which we will gladly send you.

Subject to technical modifications with corresponding follow-up certifications. Errors excepted. Illustration similar.

Packaging Specifications

Truck

| | |
|--------------------------|----------------|
| Dimension pallet (L/W/H) | 169/112/114 cm |
| Weight pallet | approx. 603 kg |
| Modules per pallet | 30 |
| Modules per truck | 900 |

Shipment

| | |
|--------------------------------|----------------|
| Dimension pallet (L/W/H) | 169/112/114 cm |
| Weight pallet | approx. 603 kg |
| Modules per pallet | 30 |
| Modules per container [40' HC] | 840 |

Certifications

UNI 9177 - class 1 fire behaviour



Module performance

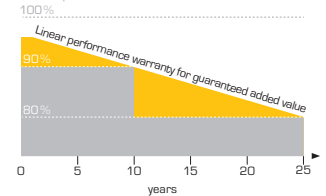

■ Linear performance warranty
■ Standard tiered warranty

M Series

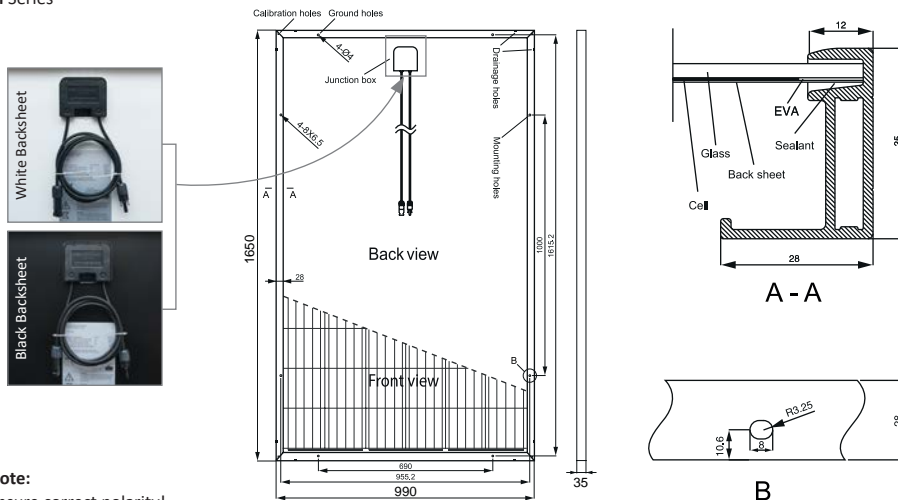

Note:
Ensure correct polarity!

Your specialist dealer:

SF Solar Fabrik GmbH & Co. KG

Im Gewerbegebiet 12
63831 Wiesen
Germany

Phone: +49 (0)6096 9 700-790
Fax: +49 (0)6096 9 700-728
Mail: info@solar-fabrik.de
Web: www.solar-fabrik.de