

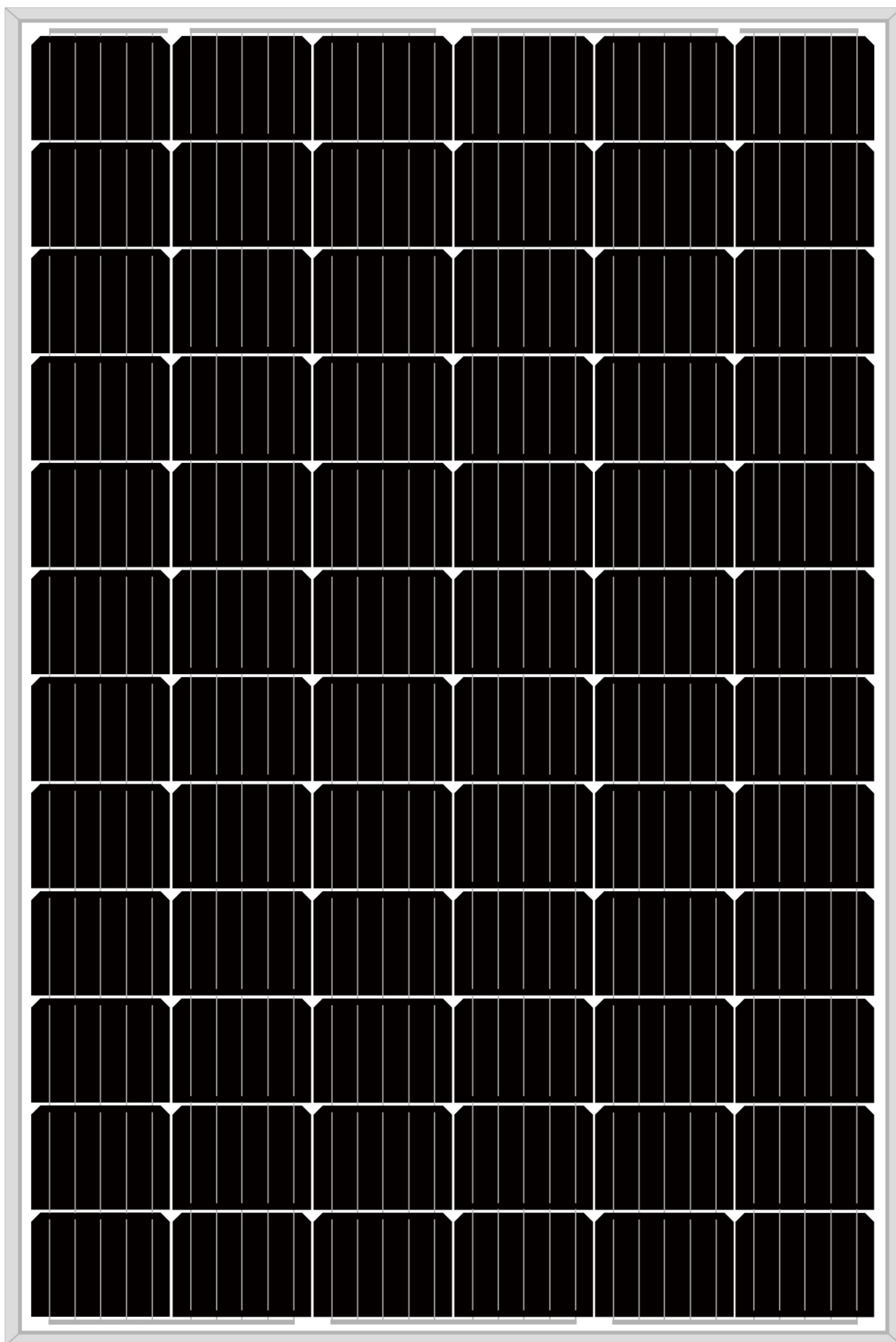

195~275 Watt



*BLACK FRAME/BLACK BACK-SHEET PRODUCTS ARE AVAILABLE UPON REQUEST

MANAGEMENT SYSTEM



ISO 9001: Quality management system



ISO 14001: Standard for environmental management system



OHSAS 18001: International standard for occupational health and safety assessment system

PRODUCT CERTIFICATES



WARRANTY

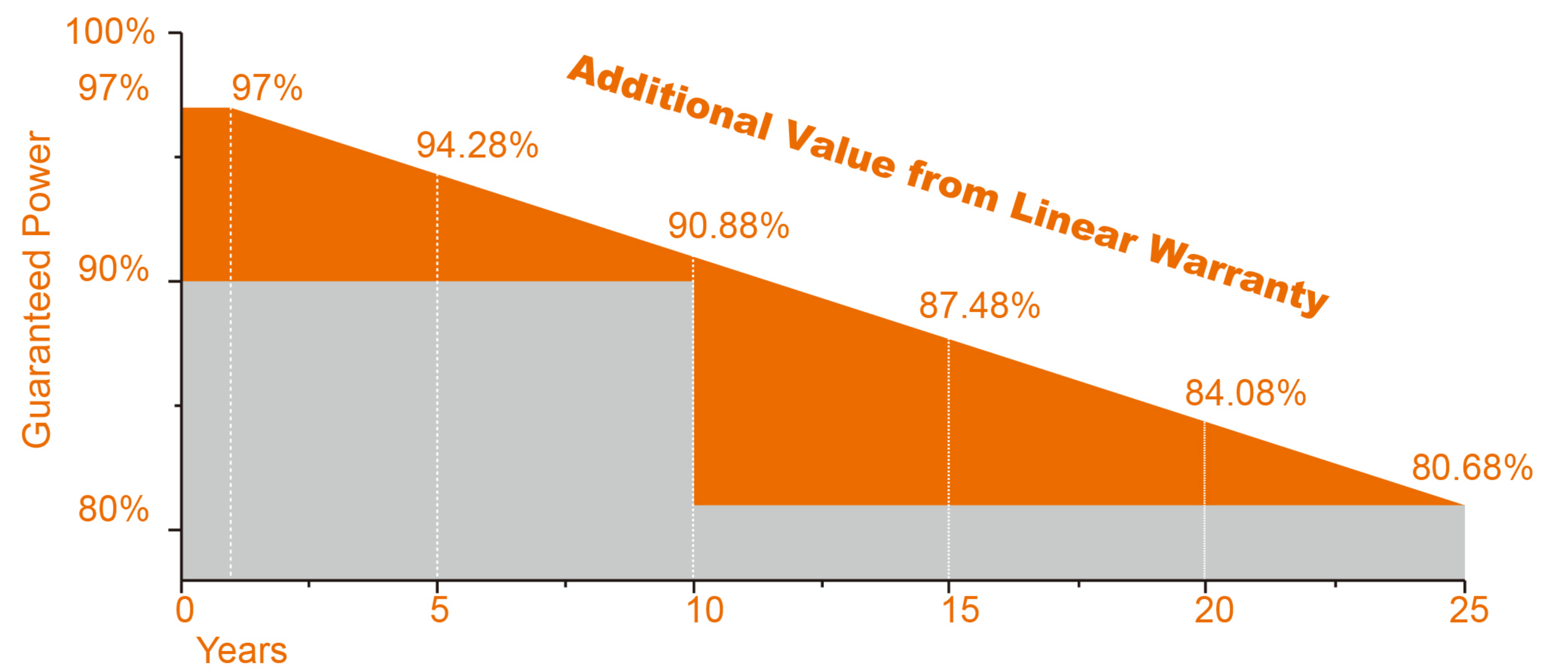

12 Years
Material & Craft
Quality
assurance

12 Years
90% Output
Power
guarantee

25 Years
80% Output
Power
guarantee

Safety



Safety for salt mist corrosion
(IEC61701, tested in TUV)

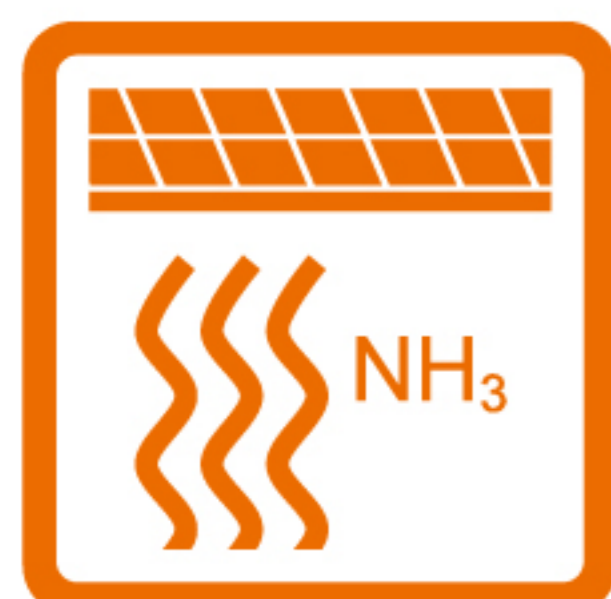

Safety for ammonia corrosion
(IEC62716, tested in TUV)



Safety for fire risk
(Class A, tested in TUV)

Key



High stability of the aluminium
frame



High quality junction box and
connector systems



100% inspection, to guarantee
the reliability of solar systems

Technology



Using high efficiency mono
solar cells



Excellent performance in
low-light environments



High transmissivity, low-iron
tempered glass.

Electrical Characteristics (STC)

Module Type	SKT195M6-24	SKT200M6-24	SKT205M6-24	SKT210M6-24	SKT215M6-24	SKT220M6-24
Maximum Power- Pmax(W)	195	200	205	210	215	220
Open Circuit Voltage - Voc(V)	44.7	45.1	45.2	45.3	45.5	45.8
Short- Circuit Current - Isc(A)	5.77	5.89	6.02	6.15	6.24	6.35
Voltage at Pmax -Vmp(V)	36.5	36.7	36.8	36.9	37.2	37.4
Current at Pmax - Imp(A)	5.34	5.45	5.57	5.69	5.78	5.88
Module Efficiency -ηm (%)	14.78	15.16	15.54	15.92	16.30	16.67

Module Type	SKT225M6-24	SKT230M6-24	SKT235M6-24	SKT240M6-24	SKT245M6-24	SKT250M6-24
Maximum Power- Pmax(W)	225	230	235	240	245	250
Open Circuit Voltage - Voc(V)	45.1	45.2	45.3	45.5	45.8	46.2
Short- Circuit Current - Isc(A)	6.62	6.75	6.88	6.97	7.07	7.18
Voltage at Pmax -Vmp(V)	36.7	36.8	36.9	37.2	37.4	37.6
Current at Pmax - Imp(A)	6.13	6.25	6.37	6.45	6.55	6.65
Module Efficiency -ηm (%)	15.33	15.67	16.01	16.35	16.69	17.03

Module Type	SKT255M6-24	SKT260M6-24	SKT265M6-24	SKT270M6-24	SKT275M6-24
Maximum Power- Pmax(W)	255	260	265	270	275
Open Circuit Voltage - Voc(V)	46.6	47.0	47.4	47.8	48.2
Short- Circuit Current - Isc(A)	7.29	7.40	7.51	7.62	7.73
Voltage at Pmax -Vmp(V)	37.8	38.0	38.2	38.3	38.5
Current at Pmax - Imp(A)	6.75	6.85	6.96	7.06	7.16
Module Efficiency -ηm (%)	17.37	17.81	18.15	18.49	18.83

STC: Irradiance 1000W/m², Cell Temperature 25°C, Air Mass 1.5

Power Tolerance(W)	(0, +4.99)
Maximum System Voltage(V)	1000
Maximum Series Fuse Rating (A)	20
Operating Temperature	-40~+85°C

Mechanical Specifications

Module Type	SKT250~275M6-24	SKT225~245M6-24	SKT195~220M6-24
External Dimensions	1480×992×35mm	1330×992×35mm	1160×992×35mm
Weight	17kg	15kg	13kg
Mono Solar Cells	117×156mm (72pcs)	104×156mm (72pcs)	90×156mm (72pcs)
Front Glass	3.2 mm tempered glass, low iron	3.2 mm tempered glass, low iron	3.2 mm tempered glass, low iron
Frame	Anodized aluminum alloy	Anodized aluminum alloy	Anodized aluminum alloy
Junction Box	IP67	IP67	IP67
Output Cables	4.0 mm ² , cable length:1000 mm	4.0 mm ² , cable length:1000 mm	4.0 mm ² , cable length:1000 mm
Connector	MC4 Compatible	MC4 Compatible	MC4 Compatible
Mechanical Load	5400 Pa	5400 Pa	5400 Pa

Packing Configuration

Module Type	SKT250~275M6-24	SKT225~245M6-24	SKT195~220M6-24
Carton Dimensions	1520×1110×1007mm	1370×1110×1007mm	1200×1110×1007mm
Pallet Dimensions	1530×1120×1140mm	1380×1120×1140mm	1210×1120×1140mm
Pallet Weight	570kg	510kg	450kg
Pieces per Pallet	30(5pcs/carton)	30(5pcs/carton)	30(5pcs/carton)

I-V Curve (SKT245M6-24)

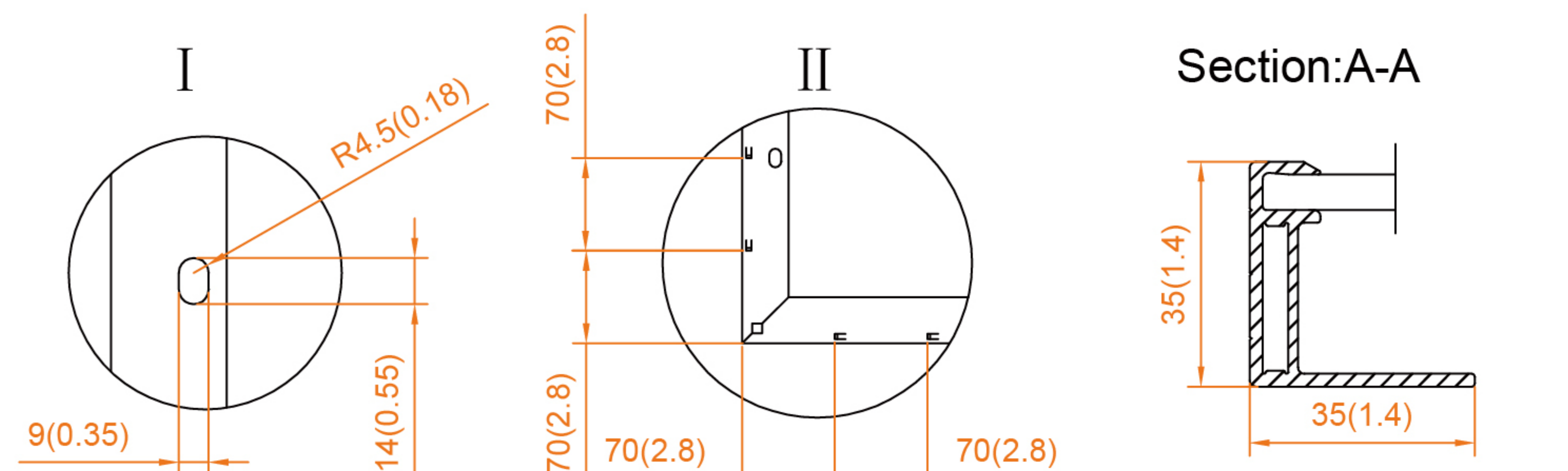
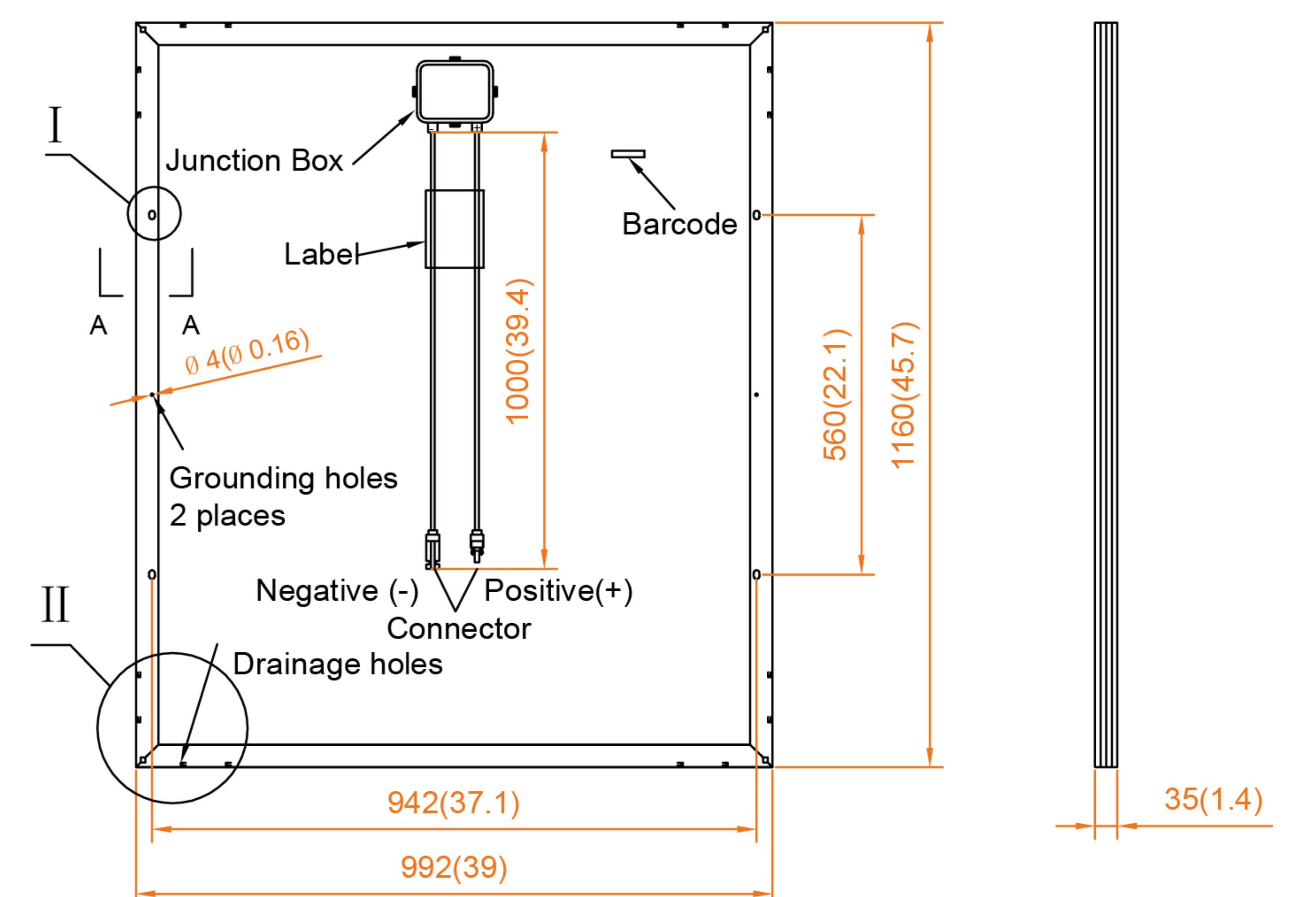
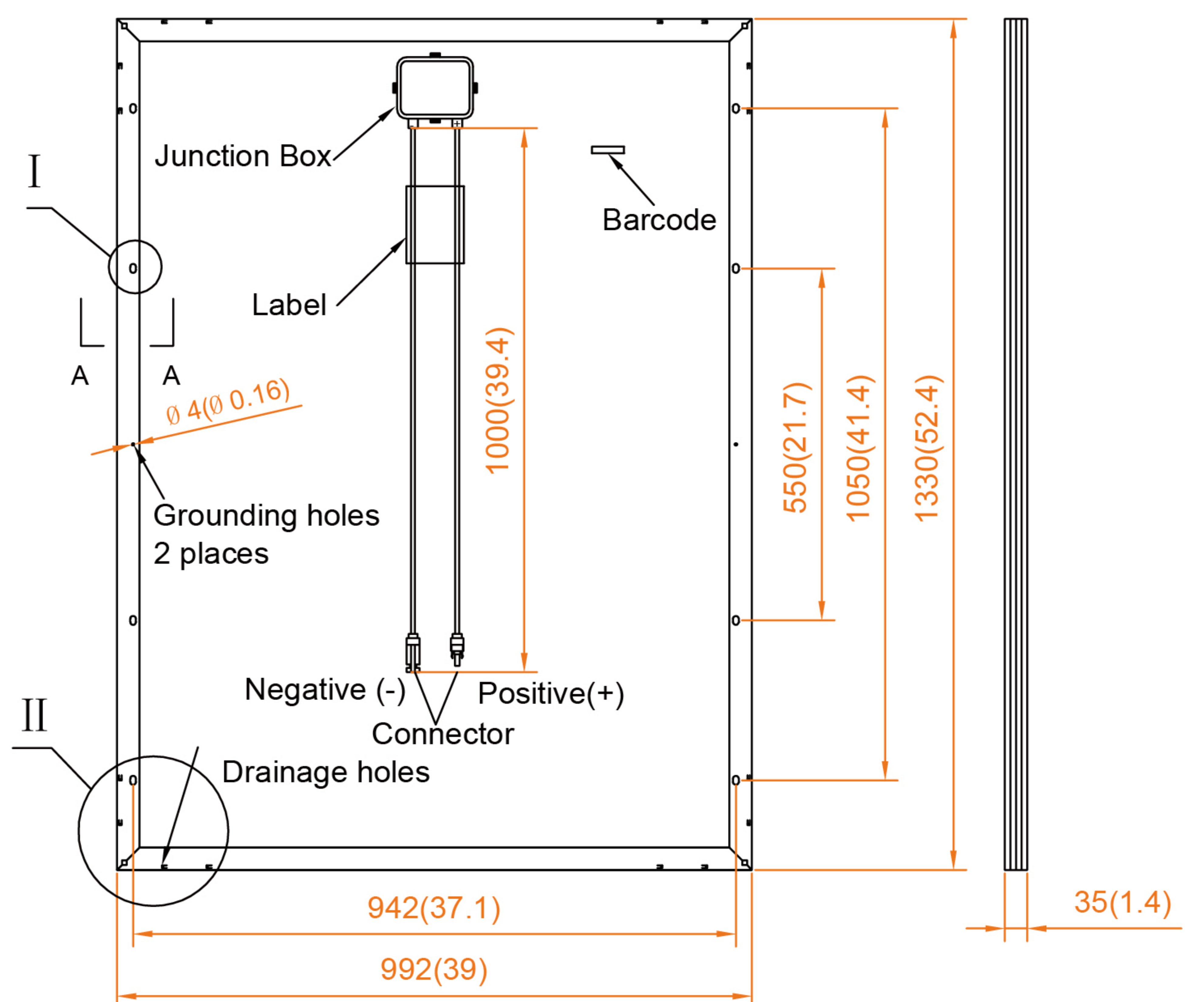
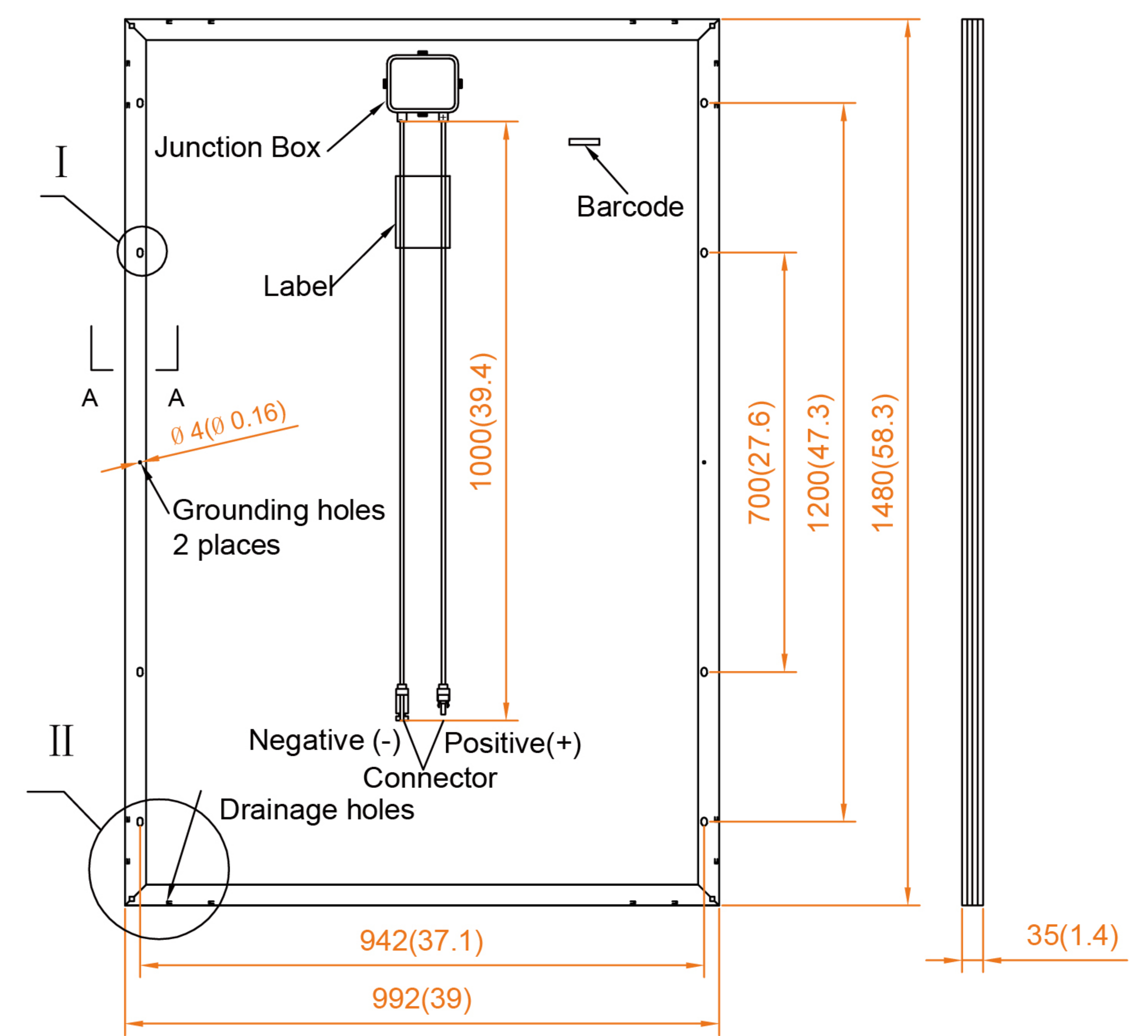
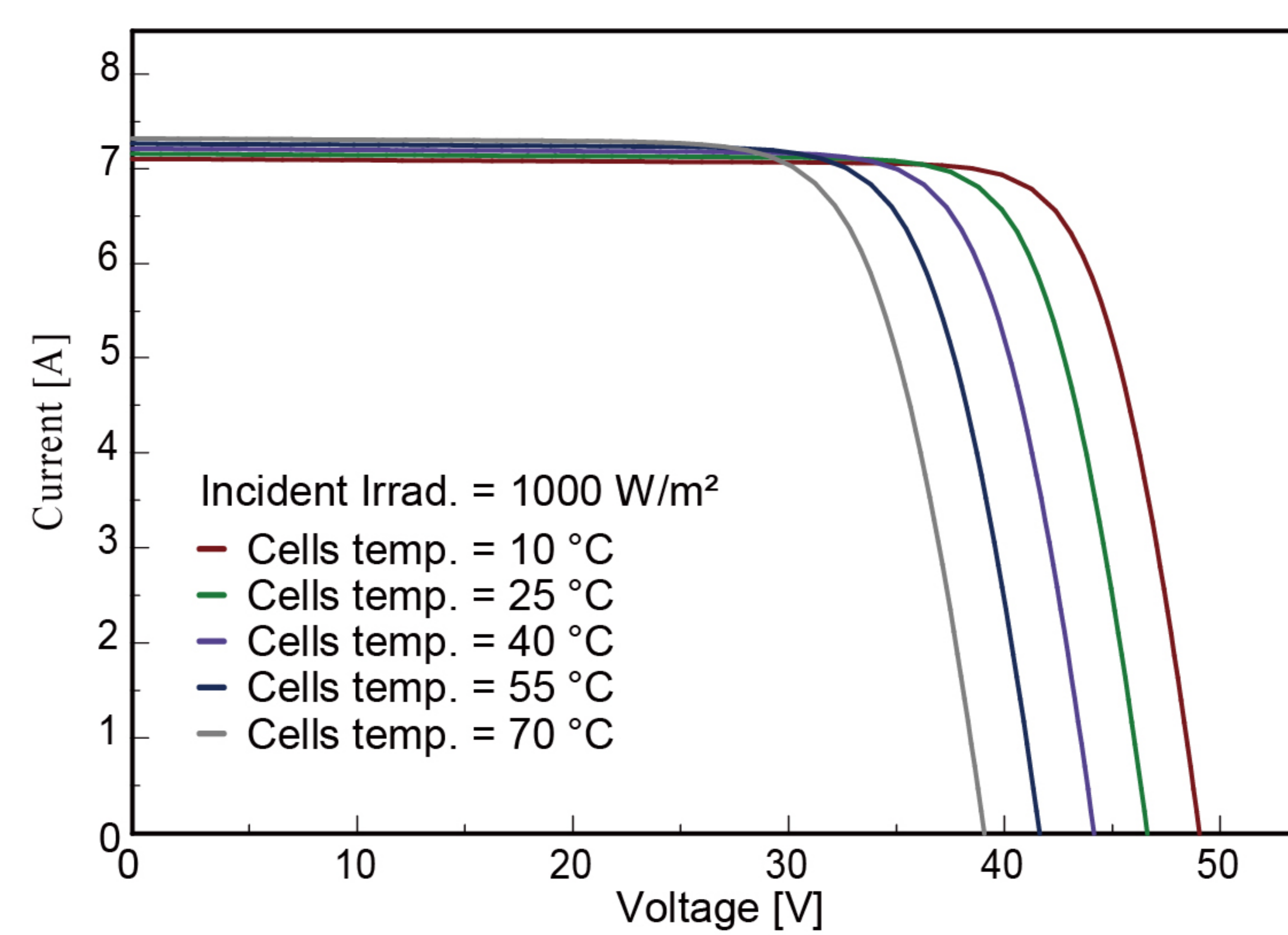
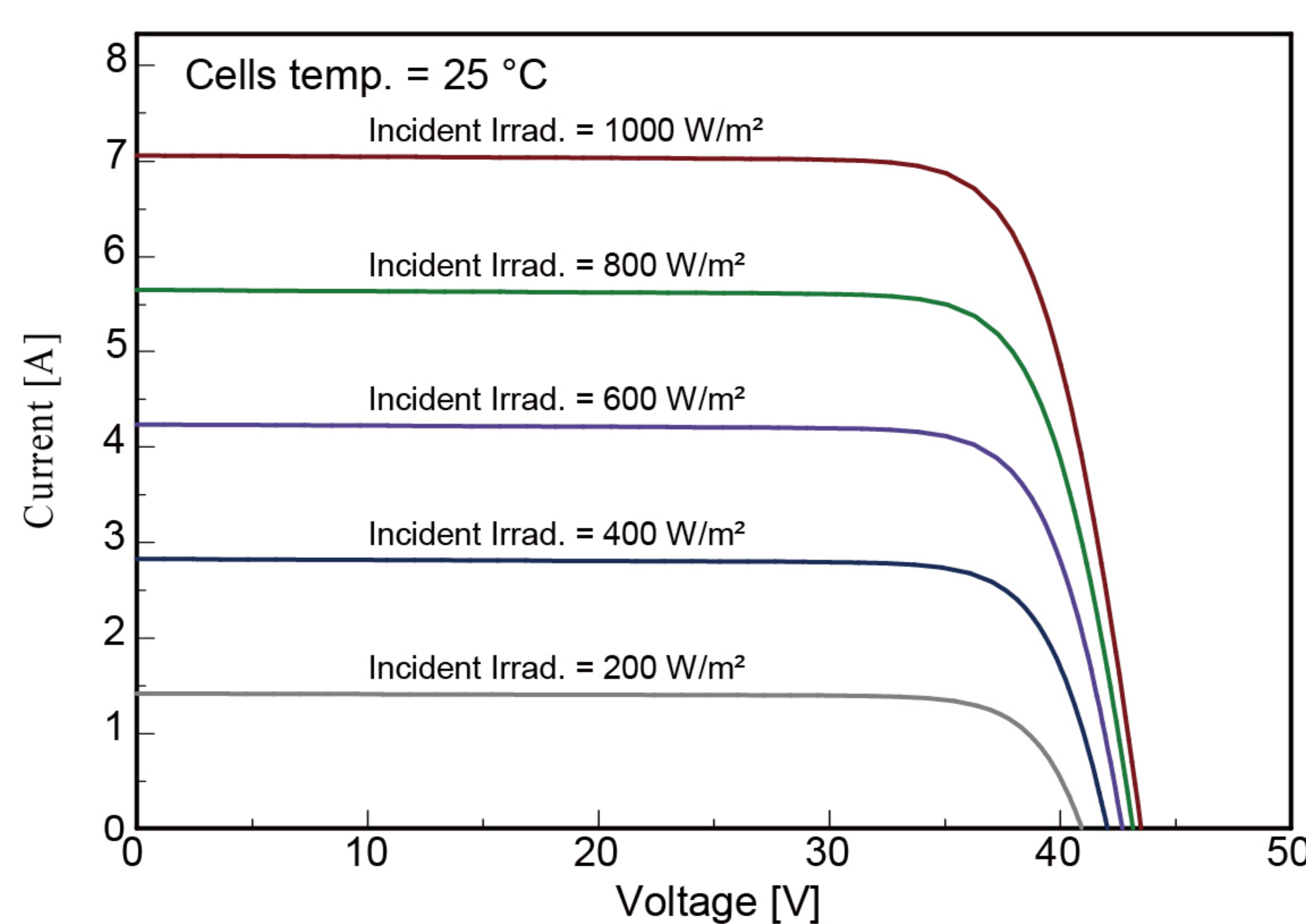

All Dimensions in mm(inch)
The above drawing is a graphical representation of the product.
For engineering quality drawings please contact SUNKET.

Specifications are subject to change without further notification SKT-EN-2019V1.0 © Copyright 2019 Sunket