



SOLESOLAR SP200W



0/+5 WP POSITIVE TOLERANCE



ROOFTOP AND OFF-GRID DESIGN



HIGH QUALITY

25 year linear performance warranty
10 year product warranty



The high voltage solar panels
designed for solar pumping



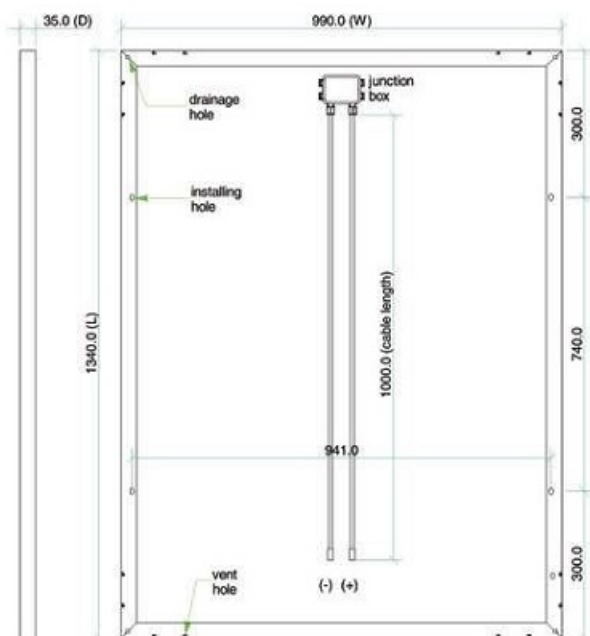

General characteristics

Cell	polycrystalline solar cell 156 x 104 mm
No. of Cells (Connections)	72 (6 x 12)
Panel Dimensions	1340 x 990 x 35 mm
Weight	14.5 kg
Connectors and Cables	Connectors and 1m cables

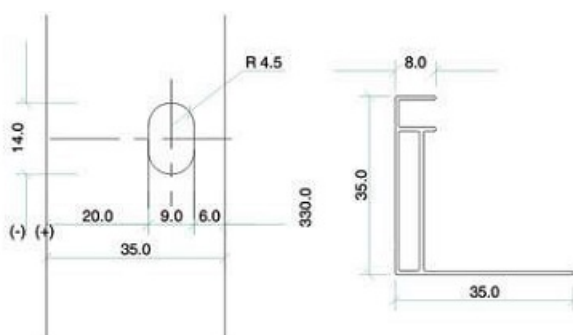

Thermal conditions

Normal Operating Cell Temperature 800W/m ² irradiance, 20°C, AM = 1.5	48°C ± 2°C
Power temperature coefficient	- 0.5%/K
Current temperature coefficient	0.035%/K
Voltage temperature coefficient	- 0.37 MV/K

Limits

Operating temperature	-40°C to + 85°C
Maximum system voltage	1000V DC

Electric performance at STC *

Maximum Power	200 W
Power tolerance	0/+5 Wp
Maximum power voltage	35.8 V
Maximum power current	5.59 A
Open circuit voltage	44.0 V
Short circuit current	6.08 A

Standard Test Conditions : 1000W/m² irradiance, 25°C and AM = 1.5

High performance

25 25 Years
linear performance

10 10 Years
product warranty

