

Motive Battery

Energy Storage Battery

Reserve Battery

Motorcycle Battery



Energy Storage Battery-AGM-GEL Technology-TNG Series

TNG12-120

(12V 120Ah)

GENERAL FEATURES

- ◆ Oxygen recombination technology: maintenance-free, no need to add water or acid
- ◆ The patent grid alloy: less gassing, low self-discharge, excellent corrosion resistance
- ◆ Special paste formula: additives for deep discharge, long cycle life
- ◆ High quality AGM separator: extend cycle life and prevent micro short circuit
- ◆ The patent Nano silica electrolytes, extend cycle life and improve the deep discharge performance
- ◆ ABS container: increase the strength of battery (Flame-retardant ABS UL94-V0 is optional)

Dimension

Unit:mm

Length	406±2mm	/	15.98inch
Width	173±2mm	/	6.81inch
Container Height	209±3mm	/	8.23inch
Total Height	233±3mm	/	9.17inch

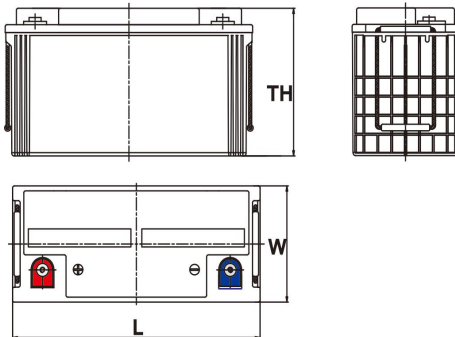

Application

- ◆ Renewable energy system
- ◆ Hybrid solar power system
- ◆ Uninterrupted Power Supply (UPS)
- ◆ Communications and electric equipment
- ◆ Emergency lighting equipment
- ◆ Fire alarm and security systems
- ◆ Robots, control equipment, and other factory automation equipment
- ◆ Emergency power supply (EPS)
- ◆ Various power toy and hobby equipment
- ◆ Lighting equipment

Terminal

Unit:mm

Terminal Type: I7

Weight

38.3kg 84.44lbs

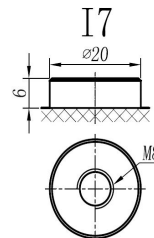

This document is subject to change without prior notification

Motive Battery

Energy Storage Battery



Reserve Battery

Motorcycle Battery

TNG12-120

Specificaion

Nominal Voltage	12V	
Rated Capacity(25°C)	127Ah	20hr Rate(1.80V/cell)
	120Ah	10hr Rate(1.80V/cell)
	103Ah	5hr Rate(1.75V/cell)
	96Ah	3hr Rate(1.70V/cell)
	73Ah	1hr Rate(1.60V/cell)
Container Material	ABS (Flame-retardant ABS UL94-V0 is optional)	
Operating Temperature Range	Discharge	-20 ~ +50°C
	Charge	0 ~ +40°C
	Storage	-15 ~ +40°C
Capacity Effected by Temperature	40°C / 104°F	106%
	25°C / 77°F	100%
	0°C / 32°F	86%
	-10°C / 14°F	65%
Charge Voltage	Float Voltage	2.25 -2.30V/cell@25°C, Tem. Coefficient: -3mV/cell/°C
	Equalize Voltage	2.35 -2.40V/cell@25°C, Tem. Coefficient: -3mV/cell/°C
	Cycle Voltage	2.40 -2.50V/cell@25°C, Tem. Coefficient: -5mV/cell/°C
Max Charging Current	36A (0.3C)	
Max. Discharge Current (5S)	1300A	
Internal Resistance	4mΩ	
Self Discharge	<3%, TN series stored at 25 °C require a supplementary charge every six months, the charging interval would shrink when the ambient temperature went higher	

Discharge Performance

Constant Current Discharge Table (25°C/77°F) Unit: A

F.V/Time	5min	10min	15min	20min	30min	45min	1h	2h	3h	4h	5h	6h	8h	10h	20h
1.85V/cell	201.5	158.4	134.7	112.7	89.6	68.7	56.59	35.99	28.49	23.29	18.80	16.30	13.30	11.31	6.310
1.80V/cell	270.5	202.4	162.7	133.2	105.7	80.0	63.39	39.29	30.69	24.79	20.10	17.50	14.10	12.01	6.371
1.75V/cell	304.9	222.4	177.8	143.3	109.7	83.0	66.29	40.79	31.19	25.39	20.60	18.00	14.30	12.11	6.432
1.70V/cell	335.8	242.4	189.8	150.6	114.2	86.2	68.38	42.39	32.09	26.09	21.20	18.40	14.50	12.21	6.555
1.65V/cell	370.2	261.6	201.8	160.0	120.5	88.4	70.68	43.59	33.49	26.99	21.80	18.80	14.70	12.51	6.637
1.60V/cell	408.4	284.0	215.8	170.4	127.1	92.1	73.18	45.09	34.49	27.79	22.49	19.20	14.90	12.61	6.677

Constant Power Discharge Table (25°C/77°F) Unit: W

F.V/Time	5min	10min	15min	20min	30min	45min	1h	2h	3h	4h	5h	6h	8h	10h	20h
1.85V/cell	201.5	158.4	134.7	112.7	89.6	68.7	56.59	35.99	28.49	23.29	18.80	16.30	13.30	11.31	6.180
1.80V/cell	270.5	202.4	162.7	133.2	105.7	80.0	63.39	39.29	30.69	24.79	20.10	17.50	14.10	12.01	6.240
1.75V/cell	304.9	222.4	177.8	143.3	109.7	83.0	66.29	40.79	31.19	25.39	20.60	18.00	14.30	12.11	6.300
1.70V/cell	335.8	242.4	189.8	150.6	114.2	86.2	68.38	42.39	32.09	26.09	21.20	18.40	14.50	12.21	6.420
1.65V/cell	370.2	261.6	201.8	160.0	120.5	88.4	70.68	43.59	33.49	26.99	21.80	18.80	14.70	12.51	6.500
1.60V/cell	408.4	284.0	215.8	170.4	127.1	92.1	73.18	45.09	34.49	27.79	22.49	19.20	14.90	12.61	6.540

□ 动力电池

■ 储能电池

□ 备用电池

□ 摩托车电池



储能电池-AGM-凝胶技术-TNG系列

TNG12-120

(12V 120Ah)

产品特点

- ◆ 阀控式免维护设计，寿命期间无需加水或加酸
- ◆ 专利稀土合金板栅，减少气体产生，自放电率低，抗腐蚀能力出众
- ◆ 特制组成配方，添加特殊试剂，增进深放电性能，延长循环寿命
- ◆ 高质量AGM隔板：防止微短路，延长循环寿命
- ◆ 纳米硅胶专利电解质，延长循环寿命，增进深放电性能
- ◆ ABS壳盖：电池外壳强度高（阻燃壳体UL94-V0可选）



产品应用

- ◆ 可再生能源系统
- ◆ 太阳能混合动力系统
- ◆ 不间断电源 (UPS)
- ◆ 通信及电力设备
- ◆ 应急照明系统
- ◆ 安防及火灾报警系统
- ◆ 机械自动化控制设备
- ◆ 应急电源 (EPS)
- ◆ 各式电动玩具及娱乐设施
- ◆ 照明设备

尺寸

单个尺寸

长	406±2mm / 15.98inch
宽	173±2mm / 6.81inch
高	209±3mm / 8.23inch
总高	233±3mm / 9.17inch

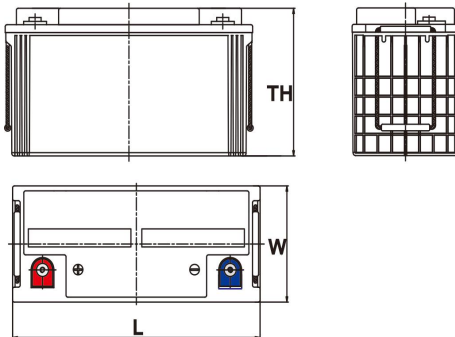

端子类型

单位:mm

端子类型 17

重量

38.3kg 84.44lbs

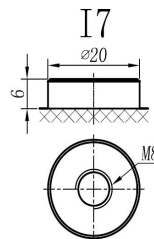

内容如有改动，恕不另行通知

动力电池

储能电池

备用电池

摩托车电池



规格书

TNG12-120

额定电压	12V	
容量(25°C)	127Ah	20hr Rate(1.80V/cell)
	120Ah	10hr Rate(1.80V/cell)
	103Ah	5hr Rate(1.75V/cell)
	96Ah	3hr Rate(1.70V/cell)
	73Ah	1hr Rate(1.60V/cell)
壳体材料	ABS (阻燃ABS壳体可选)	
使用温度范围	放电	-20 ~ +50°C
	充电	0 ~ +40°C
	储存	-15 ~ +40°C
不同温度下电 池容量系数	40°C / 104°F	106%
	25°C / 77°F	100%
	0°C / 32°F	86%
	-10°C / 14°F	65%
充电电压	浮充	2.25 -2.30V/单格@25°C, 温度补偿系数: -3mV/单格/°C
	均充	2.35 -2.40V/单格@25°C, 温度补偿系数: -3mV/单格/°C
	循环使用	2.40 -2.50V/单格@25°C, 温度补偿系数: -5mV/单格/°C
最大充电电流	36A (0.3C)	
最大放电电流(5S)	1300A	
电阻	4mΩ	
自放电	<3%, TN系列储存在25°C 时需每6个月进行一次补充充电, 环境温度更高时则充电间隔时间越短	

放电性能

恒电流放电表 (25°C/77°F) 单位: A															
F. V/Time	5min	10min	15min	20min	30min	45min	1h	2h	3h	4h	5h	6h	8h	10h	20h
1.85V/cell	201.5	158.4	134.7	112.7	89.6	68.7	56.59	35.99	28.49	23.29	18.80	16.30	13.30	11.31	6.310
1.80V/cell	270.5	202.4	162.7	133.2	105.7	80.0	63.39	39.29	30.69	24.79	20.10	17.50	14.10	12.01	6.371
1.75V/cell	304.9	222.4	177.8	143.3	109.7	83.0	66.29	40.79	31.19	25.39	20.60	18.00	14.30	12.11	6.432
1.70V/cell	335.8	242.4	189.8	150.6	114.2	86.2	68.38	42.39	32.09	26.09	21.20	18.40	14.50	12.21	6.555
1.65V/cell	370.2	261.6	201.8	160.0	120.5	88.4	70.68	43.59	33.49	26.99	21.80	18.80	14.70	12.51	6.637
1.60V/cell	408.4	284.0	215.8	170.4	127.1	92.1	73.18	45.09	34.49	27.79	22.49	19.20	14.90	12.61	6.677

恒功率放电表 (25°C/77°F) 单位: W															
F. V/Time	5min	10min	15min	20min	30min	45min	1h	2h	3h	4h	5h	6h	8h	10h	20h
1.85V/cell	201.5	158.4	134.7	112.7	89.6	68.7	56.59	35.99	28.49	23.29	18.80	16.30	13.30	11.31	6.180
1.80V/cell	270.5	202.4	162.7	133.2	105.7	80.0	63.39	39.29	30.69	24.79	20.10	17.50	14.10	12.01	6.240
1.75V/cell	304.9	222.4	177.8	143.3	109.7	83.0	66.29	40.79	31.19	25.39	20.60	18.00	14.30	12.11	6.300
1.70V/cell	335.8	242.4	189.8	150.6	114.2	86.2	68.38	42.39	32.09	26.09	21.20	18.40	14.50	12.21	6.420
1.65V/cell	370.2	261.6	201.8	160.0	120.5	88.4	70.68	43.59	33.49	26.99	21.80	18.80	14.70	12.51	6.500
1.60V/cell	408.4	284.0	215.8	170.4	127.1	92.1	73.18	45.09	34.49	27.79	22.49	19.20	14.90	12.61	6.540