

Motive Battery

Energy Storage Battery

Reserve Battery

Motorcycle Battery



Energy Storage Battery-AGM-GEL Technology-TNG Series

TNG12-230

(12V 230Ah)

GENERAL FEATURES

- ◆ Oxygen recombination technology: maintenance-free, no need to add water or acid
- ◆ The patent grid alloy: less gassing, low self-discharge, excellent corrosion resistance
- ◆ Special paste formula: additives for deep discharge, long cycle life
- ◆ High quality AGM separator: extend cycle life and prevent micro short circuit
- ◆ The patent Nano silica electrolytes, extend cycle life and improve the deep discharge performance
- ◆ ABS container: increase the strength of battery (Flame-retardant ABS UL94-V0 is optional)

Dimension

Unit:mm

Length 522±2mm / 20.55inch

Width 238±2mm / 9.37inch

Container Height 218±3mm / 8.58inch

Total Height 224±3mm / 8.82inch

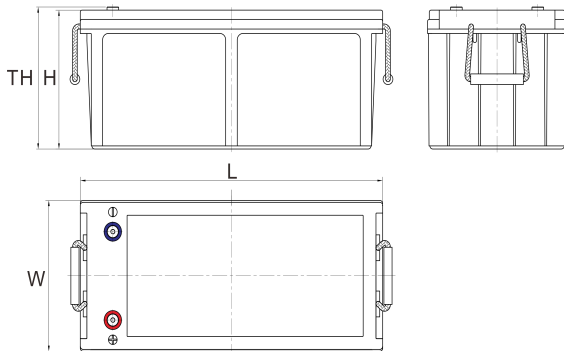

Application

- ◆ Renewable energy system
- ◆ Hybrid solar power system
- ◆ Uninterrupted Power Supply (UPS)
- ◆ Communications and electric equipment
- ◆ Emergency lighting equipment
- ◆ Fire alarm and security systems
- ◆ Robots, control equipment, and other factory automation equipment
- ◆ Emergency power supply (EPS)
- ◆ Various power toy and hobby equipment
- ◆ Lighting equipment

Terminal

Unit:mm

Terminal Type: I7

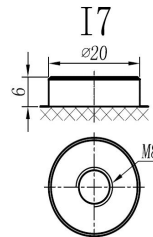

Weight

65.6kg 144.62lbs



This document is subject to change without prior notification

Motive Battery

Energy Storage Battery

Reserve Battery

Motorcycle Battery



TNG12-230

Specification

Nominal Voltage	12V	
Rated Capacity(25°C)	460Ah	20hr Rate(1.80V/cell)
	269Ah	10hr Rate(1.80V/cell)
	240Ah	5hr Rate(1.75V/cell)
	244Ah	3hr Rate(1.70V/cell)
	140Ah	1hr Rate(1.60V/cell)
Container Material	ABS (Flame-retardant ABS UL94-V0 is optional)	
Operating Temperature Range	Discharge	-20 ~ +50°C
	Charge	0 ~ +40°C
	Storage	-15 ~ +40°C
Capacity Effected by Temperature	40°C / 104°F	106%
	25°C / 77°F	100%
	0°C / 32°F	86%
	-10°C / 14°F	65%
Charge Voltage	Float Voltage	2.25 -2.30V/cell@25°C, Tem. Coefficient: -3mV/cell/°C
	Equalize Voltage	2.35 -2.40V/cell@25°C, Tem. Coefficient: -3mV/cell/°C
	Cycle Voltage	2.40 -2.50V/cell@25°C, Tem. Coefficient: -5mV/cell/°C
Max Charging Current	60A (0.3C)	
Max. Discharge Current (5S)	2250A	
Internal Resistance	2.6mΩ	
Self Discharge	<3%, TN series stored at 25 ° C require a supplementary charge every six months, the charging interval would shrink when the ambient temperature went higher	

Discharge Performance

Constant Current Discharge Table (25°C/77°F) Unit: A														
F.V/Time	10min	15min	20min	30min	45min	1h	2h	3h	4h	5h	6h	8h	10h	20h
1.85V/cell	314.1	270.8	230.8	174.6	131.7	108.4	69.1	69.1	53.1	43.2	36.0	31.3	25.4	21.8
1.80V/cell	388.0	318.6	266.0	202.5	153.2	121.4	75.3	75.3	58.2	46.7	38.6	33.6	26.9	23.0
1.75V/cell	426.2	340.7	282.3	213.4	159.0	127.0	78.2	78.2	59.8	47.9	39.7	34.5	27.4	23.3
1.70V/cell	464.6	363.8	297.8	221.6	165.3	131.1	81.3	81.3	61.5	49.1	40.6	35.2	27.8	23.5
1.65V/cell	501.3	386.8	317.5	230.8	169.4	135.4	83.6	83.6	64.2	50.8	41.7	36.0	28.4	23.9
1.60V/cell	537.4	413.7	335.7	243.7	176.6	140.3	86.3	86.3	66.1	52.3	42.9	36.8	28.9	24.2

Constant Power Discharge Table (25°C/77°F) Unit: W														
F.V/Time	10min	15min	20min	30min	45min	1h	2h	3h	4h	5h	6h	8h	10h	20h
1.85V/cell	314.1	270.8	230.8	174.6	131.7	108.4	69.1	53.12	43.23	35.99	31.28	25.41	21.76	11.884
1.80V/cell	388.0	318.6	266.0	202.5	153.2	121.4	75.3	58.18	46.68	38.63	33.58	26.91	23.02	11.999
1.75V/cell	426.2	340.7	282.3	213.4	159.0	127.0	78.2	59.79	47.94	39.67	34.50	27.37	23.25	12.115
1.70V/cell	464.6	363.8	297.8	221.6	165.3	131.1	81.3	61.51	49.09	40.59	35.19	27.83	23.48	12.346
1.65V/cell	501.3	386.8	317.5	230.8	169.4	135.4	83.6	64.16	50.82	41.74	35.99	28.40	23.94	12.461
1.60V/cell	537.4	413.7	335.7	243.7	176.6	140.3	86.3	66.11	52.31	42.89	36.80	28.86	24.17	12.576

动力电池

储能电池

备用电池

摩托车电池



储能电池-AGM-凝胶技术-TNG系列

TNG12-230

(12V 230Ah)

产品特点

- ◆ 阀控式免维护设计，寿命期间无需加水或加酸
- ◆ 专利稀土合金板栅，减少气体产生，自放电率低，抗腐蚀能力出众
- ◆ 特制组成配方，添加特殊试剂，增进深放电性能，延长循环寿命
- ◆ 高质量AGM隔板：防止微短路，延长循环寿命
- ◆ 纳米硅胶专利电解质，延长循环寿命，增进深放电性能
- ◆ ABS壳盖：电池外壳强度高（阻燃壳体UL94-V0可选）

尺寸

单个尺寸

长	522±2mm / 20.55inch
宽	238±2mm / 9.37inch
高	218±3mm / 8.58inch
总高	224±3mm / 8.82inch

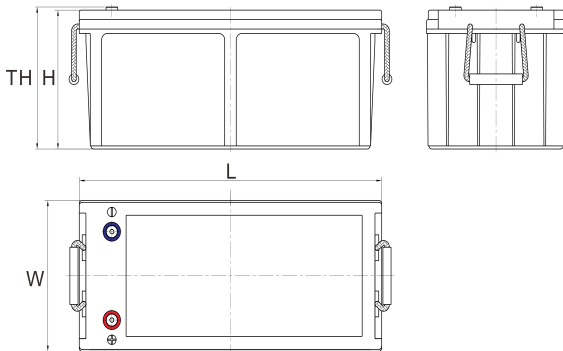

产品应用

- ◆ 可再生能源系统
- ◆ 太阳能混合动力系统
- ◆ 不间断电源 (UPS)
- ◆ 通信及电力设备
- ◆ 应急照明系统
- ◆ 安防及火灾报警系统
- ◆ 机械自动化控制设备
- ◆ 应急电源 (EPS)
- ◆ 各式电动玩具及娱乐设施
- ◆ 照明设备



端子类型

单位:mm

端子类型 I7

重量

65.6kg 144.62lbs

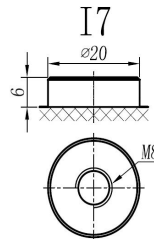

ISO9001 ISO14001 OHSAS18001

内容如有改动，恕不另行通知

动力电池

储能电池

备用电池

摩托车电池



规格书

TNG12-230

额定电压	12V
容量(25°C)	460Ah 20hr Rate(1.80V/cell)
	269Ah 10hr Rate(1.80V/cell)
	240Ah 5hr Rate(1.75V/cell)
	244Ah 3hr Rate(1.70V/cell)
	140Ah 1hr Rate(1.60V/cell)
壳体材料	ABS (阻燃ABS壳体可选)
使用温度范围	放电 -20 ~ +50°C
	充电 0 ~ +40°C
	储存 -15 ~ +40°C
不同温度下电 池容量系数	40°C / 104°F 106%
	25°C / 77°F 100%
	0°C / 32°F 86%
	-10°C / 14°F 65%
充电电压	浮充 2.25 ~ 2.30V/单格@25°C, 温度补偿系数: -3mV/单格/°C
	均充 2.35 ~ 2.40V/单格@25°C, 温度补偿系数: -3mV/单格/°C
	循环使用 2.40 ~ 2.50V/单格@25°C, 温度补偿系数: -5mV/单格/°C
最大充电电流	60A (0.3C)
最大放电电流(5S)	2250A
电阻	2.6mΩ
自放电	<3%, TN系列储存在25°C 时需每6个月进行一次补充充电, 环境温度更高时则充电间隔时间越短

放电性能

恒电流放电表 (25°C/77°F) 单位: A														
F.V/Time	10min	15min	20min	30min	45min	1h	2h	3h	4h	5h	6h	8h	10h	20h
1.85V/cell	314.1	270.8	230.8	174.6	131.7	108.4	69.1	69.10	53.12	43.23	35.99	31.28	25.41	21.757
1.80V/cell	388.0	318.6	266.0	202.5	153.2	121.4	75.3	75.31	58.18	46.68	38.63	33.58	26.91	23.023
1.75V/cell	426.2	340.7	282.3	213.4	159.0	127.0	78.2	78.18	59.79	47.94	39.67	34.50	27.37	23.253
1.70V/cell	464.6	363.8	297.8	221.6	165.3	131.1	81.3	81.29	61.51	49.09	40.59	35.19	27.83	23.483
1.65V/cell	501.3	386.8	317.5	230.8	169.4	135.4	83.6	83.59	64.16	50.82	41.74	35.99	28.40	23.944
1.60V/cell	537.4	413.7	335.7	243.7	176.6	140.3	86.3	86.35	66.11	52.31	42.89	36.80	28.86	24.174

恒功率放电表 (25°C/77°F) 单位: W														
F.V/Time	10min	15min	20min	30min	45min	1h	2h	3h	4h	5h	6h	8h	10h	20h
1.85V/cell	314.1	270.8	230.8	174.6	131.7	108.4	69.1	53.12	43.23	35.99	31.28	25.41	21.76	11.884
1.80V/cell	388.0	318.6	266.0	202.5	153.2	121.4	75.3	58.18	46.68	38.63	33.58	26.91	23.02	11.999
1.75V/cell	426.2	340.7	282.3	213.4	159.0	127.0	78.2	59.79	47.94	39.67	34.50	27.37	23.25	12.115
1.70V/cell	464.6	363.8	297.8	221.6	165.3	131.1	81.3	61.51	49.09	40.59	35.19	27.83	23.48	12.346
1.65V/cell	501.3	386.8	317.5	230.8	169.4	135.4	83.6	64.16	50.82	41.74	35.99	28.40	23.94	12.461
1.60V/cell	537.4	413.7	335.7	243.7	176.6	140.3	86.3	66.11	52.31	42.89	36.80	28.86	24.17	12.576