

Motive Battery  Energy Storage Battery

Reserve Battery  Motorcycle Battery



## Energy Storage Battery-Tubular GEL Technology-OPzV Series

# 80PzV800

(2V 800Ah)

### GENERAL FEATURES

- ◆ 20 years design life at floating condition
- ◆ Wide operating temperature range from -40°C to +60°C
- ◆ Tubular positive plate with prolonged cycle life
- ◆ Fumed silica gel electrolyte
- ◆ Lead calcium die case grid with improved corrosion resistance ability
- ◆ Low self-discharge rate and long shelf life
- ◆ Excellent deep discharge recovery capability



### Application

- ◆ Renewable energy system
- ◆ Hybrid solar power system
- ◆ Uninterrupted Power Supply ( UPS )
- ◆ Communications and electric equipment
- ◆ Emergency lighting equipment
- ◆ Fire alarm and security systems
- ◆ Control equipment, and other factory automation equipment
- ◆ Emergency power supply ( EPS )
- ◆ Lighting equipment

### Dimension

Unit:mm

Length	191±2mm	/	7.52inch
Width	210±2mm	/	8.27inch
Container Height	646±3mm	/	25.43inch
Total Height	681±3mm	/	26.81inch

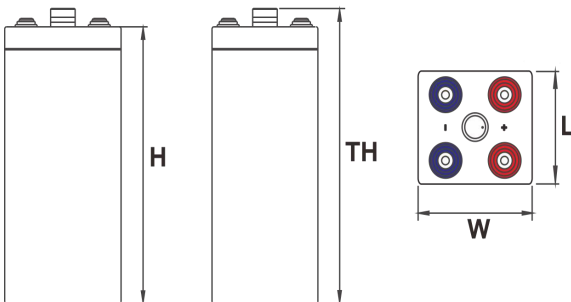

### Terminal

Unit:mm

Terminal Type I7

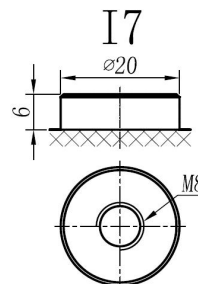

### Weight

64.5kg 142.2lbs



This document is subject to change without prior notification

Motive Battery  Energy Storage Battery

Reserve Battery  Motorcycle Battery



## 80PzV800

### Specification

<b>Nominal Voltage</b>	2V	
<b>Rated Capacity(25°C)</b>	848Ah	20hr Rate(1.80V/cell)
	800Ah	10hr Rate(1.80V/cell)
	691Ah	5hr Rate(1.75V/cell)
	622Ah	3hr Rate(1.70V/cell)
	454Ah	1hr Rate(1.60V/cell)
<b>Container Material</b>	ABS ( Fire-proofing ABS container available )	
<b>Operating Temperature Range</b>	<b>Discharge</b>	-20 ~ +50°C
	<b>Charge</b>	0 ~ +40°C
	<b>Storage</b>	-15 ~ +40°C
<b>Capacity Effected by Temperature</b>	40°C / 104°F	106%
	25°C / 77°F	100%
	0°C / 32°F	86%
	-10°C / 14°F	65%
<b>Charge Voltage</b>	<b>Float Voltage</b>	2.25 -2.30V/cell@25°C, Compensation Factor : -3mV/cell/°C
	<b>Equalize Voltage</b>	2.35 -2.40V/cell@25°C, Compensation Factor : -3mV/cell/°C
	<b>Cycle Voltage</b>	2.40 -2.50V/cell@25°C, Compensation Factor : -5mV/cell/°C
<b>Max Charging Current</b>	240A (0.3C)	
<b>Max. Discharge Current (5S)</b>	6400A	
<b>Internal Resistance</b>	0.5mΩ	
<b>Self Discharge</b>	<3%, TN series stored at 25 ° C require a supplementary charge every six months, the charging interval would shrink when the ambient temperature went higher	

### Discharge Performance

Constant Current Discharge Table (25°C/77°F) Unit: A

F.V/Time	10min	15min	30min	1h	2h	3h	5h	8h	10h	20h
1.85V/cell	545.5	518.5	446.4	356.4	236.2	183.2	126.1	87.89	74.91	39.70
1.80V/cell	671.7	627.6	520.5	401.4	259.3	199.2	135.1	94.09	80.01	42.40
1.75V/cell	794.8	702.7	554.6	418.4	267.3	203.2	138.1	95.70	81.31	43.09
1.70V/cell	891.9	766.8	587.6	434.4	273.3	207.2	140.1	96.90	82.21	43.57
1.65V/cell	957.0	809.8	610.6	446.4	279.3	211.2	142.1	98.10	83.01	43.99
1.60V/cell	1002.0	838.8	626.6	454.5	283.3	214.2	144.1	98.90	83.61	44.31

Constant Power Discharge Table (25°C/77°F) Unit: W

F.V/Time	10min	15min	30min	1h	2h	3h	5h	8h	10h	20h
1.85V/cell	1015.0	974.0	853.9	689.7	459.5	357.4	247.2	174.17	149.15	79.44
1.80V/cell	1227.2	1163.2	985.0	771.8	502.5	387.4	265.3	186.19	159.16	84.77
1.75V/cell	1426.4	1283.3	1039.0	798.8	513.5	394.4	270.3	189.19	161.16	85.84
1.70V/cell	1572.6	1380.4	1089.1	823.8	524.5	400.4	273.3	191.19	163.16	86.90
1.65V/cell	1658.7	1436.4	1121.1	841.8	532.5	406.4	276.3	193.19	164.16	87.44
1.60V/cell	1702.7	1465.5	1138.1	850.9	536.5	409.4	278.3	193.19	165.17	87.97

□ 动力电池

■ 储能电池

□ 备用电池

□ 摩托车电池



### 储能电池-管式胶体技术-OPzV系列

# 80PzV800

## (2V 800Ah)

### 产品特点

- ◆ 20年设计浮充寿命
- ◆ 使用温度区间宽广, 在-40°C至+60°C之间均可正常使用
- ◆ 管式正极板设计, 大大延长使用寿命
- ◆ 气象二氧化硅凝胶电解质
- ◆ 铅钙板栅显著提升抗腐蚀能力
- ◆ 自放电率低, 能够长时间放置保存
- ◆ 出色的深放电恢复能力



### 产品应用

- ◆ 不间断电源(UPS)
- ◆ 通信及电力设备
- ◆ 应急照明系统
- ◆ 安防及火灾报警系统
- ◆ 控制设备及其他工厂自动化设备
- ◆ 应急电源 (EPS)
- ◆ 照明设备

### 尺寸

单个尺寸

长	191±2mm
宽	210±2mm
高	646±3mm
总高	681±3mm

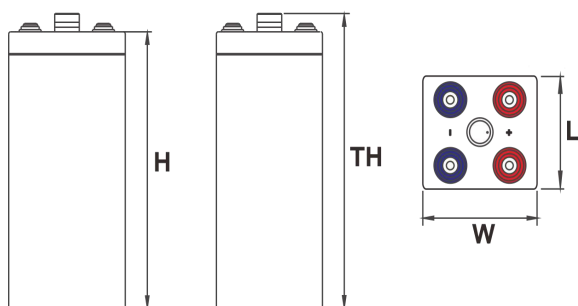

### 端子类型

单位:mm

端子类型 I7

### 重量

64.5kg 142.2lbs

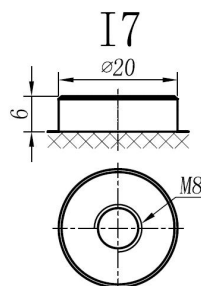

内容如有改动, 恕不另行通知

- 动力电池
- 储能电池
- 备用电池
- 摩托车电池



## 80PzV800

### 规格书

额定电压	2V	
容量(25°C)	848Ah	20hr Rate(1.80V/cell)
	800Ah	10hr Rate(1.80V/cell)
	691Ah	5hr Rate(1.75V/cell)
	622Ah	3hr Rate(1.70V/cell)
	454Ah	1hr Rate(1.60V/cell)
壳体材料	ABS (阻燃ABS壳体可选)	
使用温度范围	放电	-20 ~ +50°C
	充电	0 ~ +40°C
	储存	-15 ~ +40°C
不同温度下 电池容量系数	40°C / 104°F	106%
	25°C / 77°F	100%
	0°C / 32°F	86%
	-10°C / 14°F	65%
充电电压	浮充	2.25 -2.30V/单格@25°C, 补偿系数: -3mV/单格/°C
	均充	2.35 -2.40V/单格@25°C, 补偿系数: -3mV/单格/°C
	循环使用	2.40 -2.50V/单格@25°C, 补偿系数: -5mV/单格/°C
最大充电电流	240A (0.3C)	
最大放电电流 (5S)	6400A	
电阻	0.5mΩ	
自放电	<3%, TN系列储存在25°C时需每6个月进行一次补充充电, 环境温度更高时则充电间隔时间越短	

### 放电性能

恒电流放电表 (25°C/77°F) 单位: A										
F.V/Time	10min	15min	30min	1h	2h	3h	5h	8h	10h	20h
1.85V/cell	545.5	518.5	446.4	356.4	236.2	183.2	126.1	87.9	74.9	39.7
1.80V/cell	671.7	627.6	520.5	401.4	259.3	199.2	135.1	94.1	80.0	42.4
1.75V/cell	794.8	702.7	554.6	418.4	267.3	203.2	138.1	95.7	81.3	43.1
1.70V/cell	891.9	766.8	587.6	434.4	273.3	207.2	140.1	96.9	82.2	43.6
1.65V/cell	957.0	809.8	610.6	446.4	279.3	211.2	142.1	98.1	83.0	44.0
1.60V/cell	1002.0	838.8	626.6	454.5	283.3	214.2	144.1	98.9	83.6	44.3

恒功率放电表 (25°C/77°F) 单位: W										
F.V/Time	10min	15min	30min	1h	2h	3h	5h	8h	10h	20h
1.85V/cell	1015.0	974.0	853.9	689.7	459.5	357.4	247.2	174.2	149.1	79.4
1.80V/cell	1227.2	1163.2	985.0	771.8	502.5	387.4	265.3	186.2	159.2	84.8
1.75V/cell	1426.4	1283.3	1039.0	798.8	513.5	394.4	270.3	189.2	161.2	85.8
1.70V/cell	1572.6	1380.4	1089.1	823.8	524.5	400.4	273.3	191.2	163.2	86.9
1.65V/cell	1658.7	1436.4	1121.1	841.8	532.5	406.4	276.3	193.2	164.2	87.4
1.60V/cell	1702.7	1465.5	1138.1	850.9	536.5	409.4	278.3	193.2	165.2	88.0