

### GENERAL FEATURES

- **Long Service Life** - Thick plate design and efficient gas recombination yield a service life expectancy of up to 10 years in standby mode.
- **Low Internal Resistance** - Superb high-rate discharge characteristics ensure reliable performance in UPS and Telecom applications.
- **Maintenance-Free, Non-Spillable** - Proven VRLA technology guarantees safe operation without maintenance and 'non- restricted article' status for transportation.
- **Low Self-Discharge** - Lead-calcium alloy grids and use of high purity lead account for superior shelf-life characteristics permitting storage for extended periods of time.
- **Designed-In Reliability** - Cutting-edge manufacturing and process control combined with meticulous quality assurance procedures guarantee consistent and dependable performance

### PERFORMANCE SPECIFICATIONS

|  |                           |               |
|--|---------------------------|---------------|
| <b>Nominal Voltage</b>                             | 12V(6 cells)              |               |
| <b>Design Floating Life @25°C</b>                  | 12 Years                  |               |
| <b>Nominal Capacity @25°C</b>                      | 20 hour rate              | 38.00Ah       |
|  | 2.0A to 10.50V            |               |
|  | 10 hour rate              | 37.14Ah       |
|  | 3.91A to 10.50V           |               |
|  | 5 hour rate               | 32.54Ah       |
| <b>Internal Resistance</b>                         | 6.85A to 10.20V           |               |
|  | 3 hour rate               | 29.67Ah       |
|  | 10.41A to 9.90V           |               |
|  | 1 hour rate               | 23.03Ah       |
| <b>Energy Density (20-hr. rate)</b>                | 24.24A to 9.60V           |               |
|  | Full Charged Battery@25°C | <8mΩ          |
| <b>Specific Energy (20-hr. rate)</b>               | 86.41W-h/l                |               |
|  | 36.92W-h/kg               |               |
| <b>Shelf Life (nominal capacity at 20°C)</b>       | 1 Month                   | 97%           |
|  | 3 Months                  | 91%           |
|  | 6 Months                  | 83%           |
| <b>Max.Discharge Current@25°C</b>                  | 7 Min.                    | 120.0A        |
| <b>Max Short-Duration Discharge Current</b>        | 10 Sec                    | 380.0A        |
| <b>Standby Use Charge (Constant Voltage) @25°C</b> | Initial Charging Current  | Less than 12A |
|  | Voltage                   | 13.6-13.8V    |
| <b>Cycle Use Charge (Constant Voltage) @25°C</b>   | Initial Charging Current  | Less than 12A |
|  | Voltage                   | 14.6-14.8 V   |
| <b>Operating Temperature Range</b>                 | Charge                    | 0°C to 50°C   |
|  | Discharge                 | -20°C to 60°C |

### GENERAL FEATURES

mm

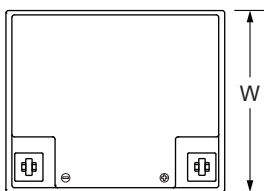

Unit: mm

|              |         |
|--------------|---------|
| Length       | 198±1   |
| Width        | 166±1   |
| Height       | 169±1   |
| Total Height | 169±1   |
| Weight(kg)   | 13.0±3% |

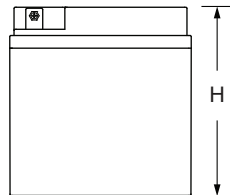
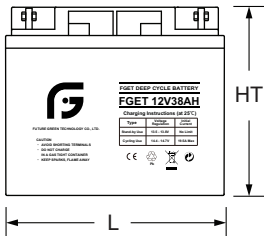

### TERMINALS

mm

- NB4: Heavy duty terminal posts with nut and bolt fasteners
- T6: Threaded insert w. 6 mm stud fastener

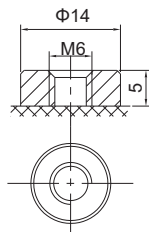
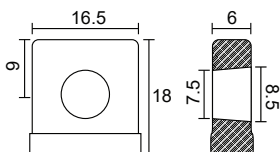

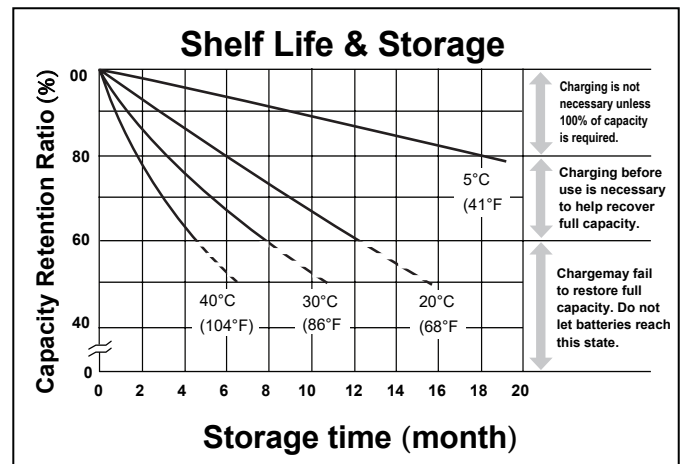
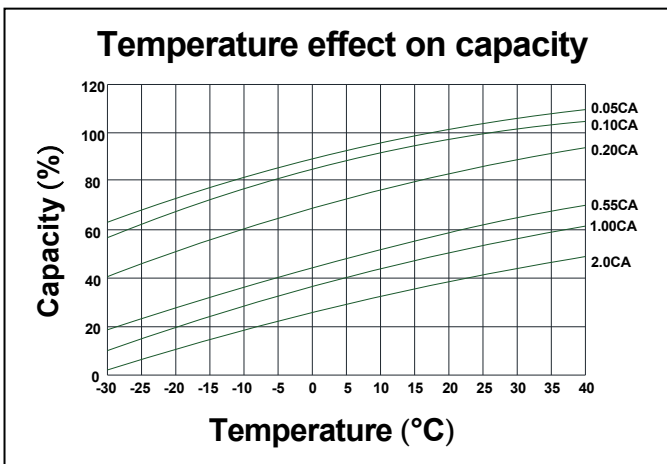
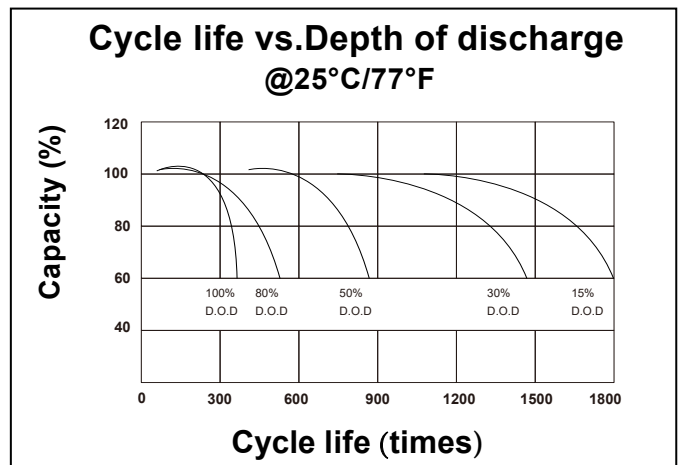
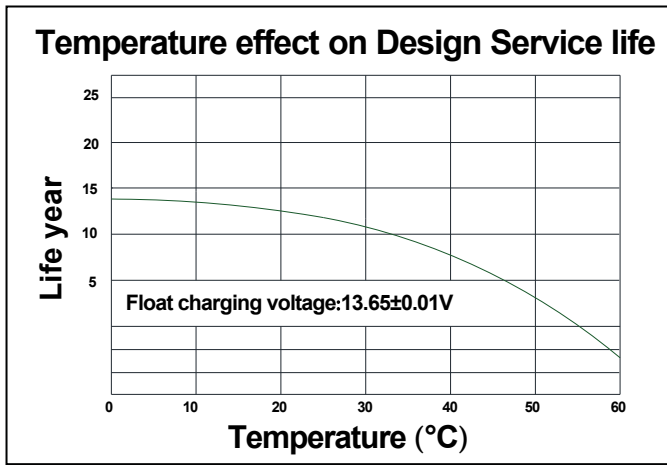
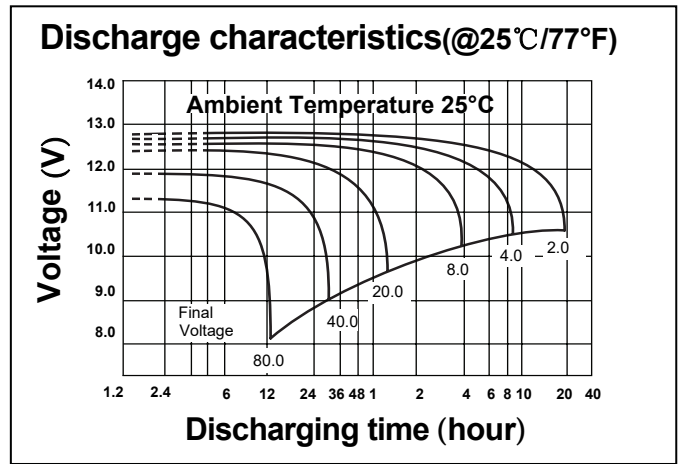
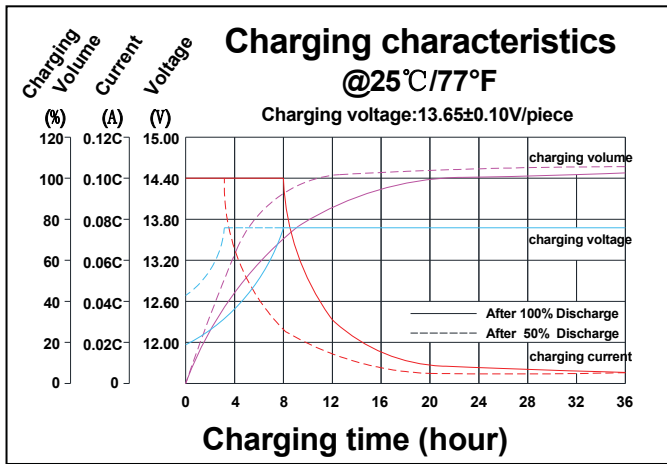

**CONSTANT CURRENT DISCHARGE RATINGS (Amperes at 25°C)**

| F.V/Time | 5MIN  | 10MIN | 15MIN | 30MIN | 1HR   | 2HR   | 3HR   | 4HR  | 5HR  | 8HR  | 10HR | 20HR |
|----------|-------|-------|-------|-------|-------|-------|-------|------|------|------|------|------|
| 1.60V    | 133.2 | 98.0  | 73.14 | 41.96 | 24.24 | 14.20 | 10.57 | 8.37 | 7.05 | 4.81 | 4.08 | 2.08 |
| 1.65V    | 128.3 | 94.73 | 70.95 | 41.08 | 23.79 | 13.96 | 10.41 | 8.25 | 6.97 | 4.76 | 4.04 | 2.06 |
| 1.70V    | 121.9 | 90.47 | 68.07 | 39.91 | 23.18 | 13.64 | 10.19 | 8.10 | 6.85 | 4.69 | 3.98 | 2.03 |
| 1.75V    | 113.3 | 84.77 | 64.21 | 38.33 | 22.35 | 13.20 | 9.90  | 7.89 | 6.69 | 4.59 | 3.91 | 2.00 |
| 1.80V    | 102.0 | 77.14 | 59.01 | 36.16 | 21.21 | 12.59 | 9.49  | 7.60 | 6.47 | 4.45 | 3.80 | 1.95 |
| 1.85V    | 86.71 | 66.73 | 51.84 | 33.08 | 19.59 | 11.72 | 8.90  | 7.17 | 6.14 | 4.25 | 3.65 | 1.88 |