

LPGS SERIES-TRUE Hybrid GEL Battery

LPGS2-1000 (2V1000AH)

Specification

Nominal Voltage	2V	
Nominal Capacity(10HR)	1000.0AH	
Dimensions	Length	475±3mm (18.70 inches)
	Width	175±2mm (6.89 inches)
	Container Height	328±3mm (12.91 inches)
	Total Height (with Terminal)	338±3mm (13.31 inches)
Approx Weight	Approx 60.4 kg (133.18lbs)	
Terminal	T11	
Container Material	ABS	
Rated Capacity	1036.0 AH/51.8A	(20hr, 1.80V/cell, 25°C/77°F)
	1000.0 AH/100.0A	(10hr, 1.80V/cell, 25°C/77°F)
	857.5 AH/171.5A	(5hr, 1.75V/cell, 25°C/77°F)
	756.3 AH/252.1A	(3hr, 1.75V/cell, 25°C/77°F)
	540.2 AH/540.2A	(1hr, 1.60V/cell, 25°C/77°F)
Max. Discharge Current	8000A (5s)	
Internal Resistance	Approx 0.54mΩ	
Operating Temp. Range	Discharge	-15~50°C (5~122°F)
	Charge	0~40°C (32~104°F)
	Storage	-15~40°C (5~104°F)
Nominal Operating Temp. Range	25±3°C (77±5°F)	
Cycle Use	Initial Charging Current less than 250.0A. Voltage 2.4V~2.5V at 25°C(77°F)Temp. Coefficient -5mV/°C	
	Standby Use No limit on Initial Charging Current Voltage 2.25V~2.3V at 25°C(77°F)Temp. Coefficient -3mV/°C	
Capacity affected by Temperature	40°C (104°F)	103%
	25°C (77°F)	100%
	0°C (32°F)	86%
Self Discharge	LPGS series batteries may be stored for up to 6 months at 25°C(77°F) and then a freshening charge is required. For higher temperatures the time interval will be shorter.	



Applications

- ◆ Tele-communication central station (wired or cellular)
- ◆ Power system communication, military communication, etc.
- ◆ Network communication including: data transmission, television signal transmission, etc.
- ◆ Uninterruptable Power System (UPS- for Telecom)



Constant Current Discharge (Amperes) at 25 °C (77°F)

F.V(Time)	10min	15min	20min	30min	45min	1h	2h	3h	4h	5h	6h	8h	10h	20h
1.85V/cell	1134.0	1000.1	900.1	744.5	590.4	477.2	296.9	238.7	188.5	162.1	138.8	111.8	95.3	50.7
1.80V/cell	1340.8	1136.0	1002.0	798.9	621.1	500.7	313.3	251.0	197.0	170.2	145.0	116.2	100.0	51.8
1.75V/cell	1512.1	1248.1	1080.1	846.0	653.1	504.2	326.2	252.1	203.5	171.5	148.5	118.3	100.8	52.5
1.70V/cell	1623.1	1332.0	1155.2	887.7	674.2	507.0	335.8	254.5	208.1	172.7	151.0	120.2	101.5	53.2
1.67V/cell	1683.5	1368.2	1155.2	909.3	692.5	520.7	340.9	256.3	210.2	173.8	152.3	121.0	102.2	53.3
1.60V/cell	1812.4	1446.2	1235.0	947.4	716.9	540.2	350.1	259.0	214.0	176.5	154.7	122.7	103.8	54.0

Constant Power Discharge (Watts) at 25 °C (77°F)

F.V(Time)	10min	15min	20min	30min	45min	1h	2h	3h	4h	5h	6h	8h	10h	20h
1.85V/cell	2132.0	1892.1	1710.6	1423.1	1135.4	921.7	576.5	464.6	368.8	318.5	273.5	221.3	189.2	100.5
1.80V/cell	2480.4	2118.9	1882.0	1513.7	1185.0	961.4	605.3	485.3	383.8	332.8	284.7	229.2	198.0	102.7
1.75V/cell	2753.4	2295.2	2005.4	1588.0	1236.8	964.8	628.2	488.2	395.6	334.0	290.5	233.0	199.3	104.2
1.70V/cell	2910.6	2421.9	2124.0	1653.5	1270.2	966.8	643.9	489.8	402.8	335.3	295.2	236.3	200.7	105.2
1.67V/cell	2987.5	2464.3	2106.4	1679.4	1296.7	987.1	651.3	491.2	406.2	336.6	297.0	237.5	201.7	105.5
1.60V/cell	3138.6	2553.2	2220.6	1732.0	1330.7	1015.6	664.4	496.2	411.6	340.7	300.5	240.2	204.7	106.7

Specifications subject to change without notice.

Dimensions

T11 Terminal

Unit: mm

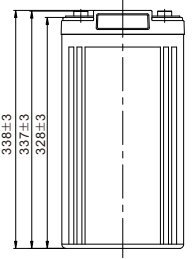
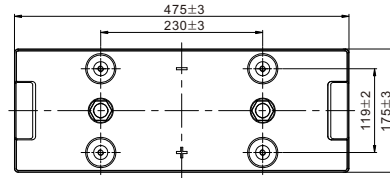
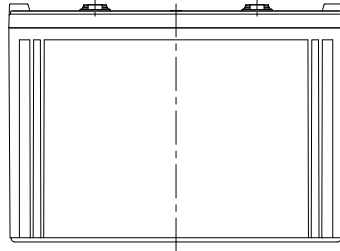
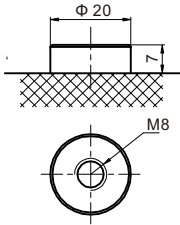

Discharge Characteristics

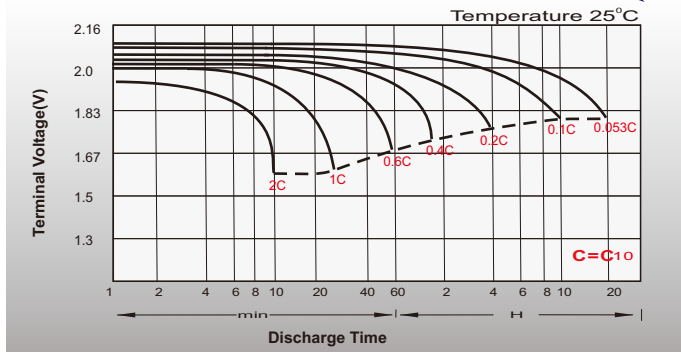

Float Charging Characteristics

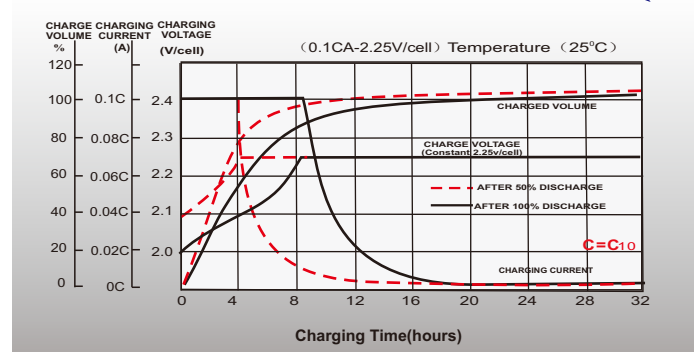

Temperature Effects in Relation to Battery Capacity

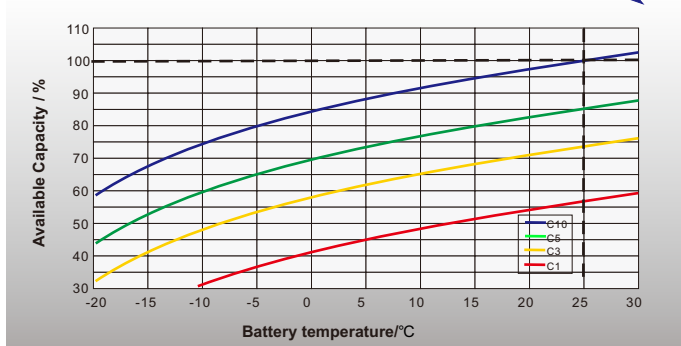

Effect of Temperature on Long Term Float Life

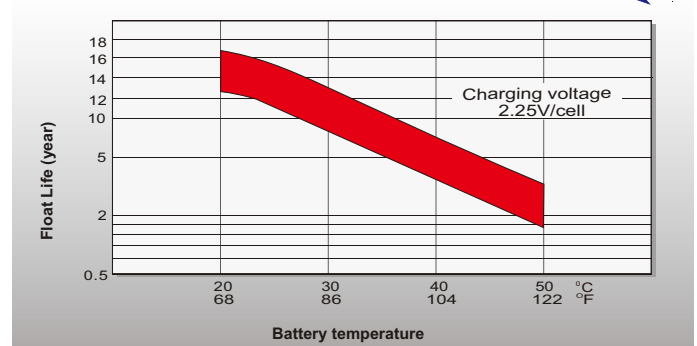

Cycle Life in Relation to Depth of Discharge

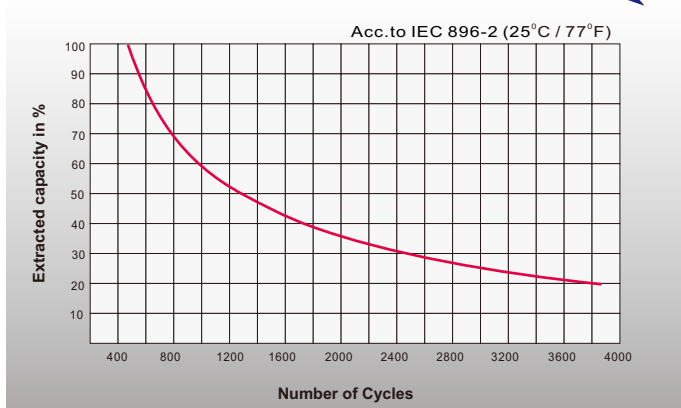

General Relation of Capacity VS. Storage Time

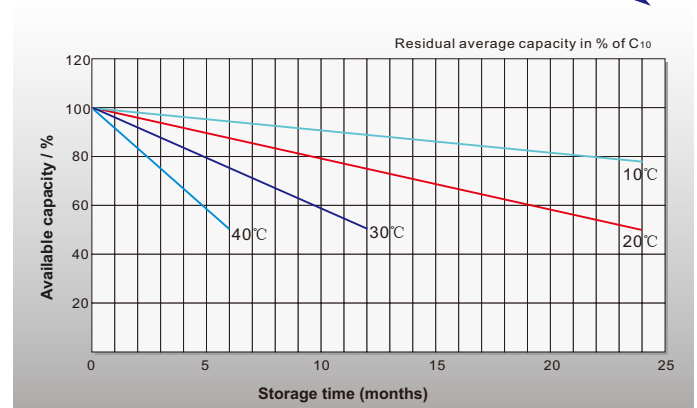

Sales Office

China sales office:

5th Floor, Xinbaohui Bldg., Nanhai Blvd.,
Nanshan, Shenzhen, China. 518052
Tel: +86-755-86036060 (100 lines)
Fax: +86-755-26067269
E-mail: export@leoch.com
Http://www.leoch.com

HongKong sales office:

Workshop C, 33/F, TML Tower,
No. 3 Hoi Shing Road, Tsuen Wan,
New Territories, Hong Kong
Tel: +852 35786666
Fax: +852 21170016
E-mail: sales.hk@leoch.com

Singapore sales office:

No. 1 Tech Park Crescent,
Singapore 638131
Tel: +65 68636078
Fax: +65 68636079
Email sales.sg@leoch.com
Http://www.leoch.com

North America sales office:

19751 Descartes, Unit A,
Foothill Ranch, CA 92610, USA
Tel: 949-588-5853
Fax: 949-588-5966
E-mail: sales@leoch.us
Http://www.leoch.us

Europe sales office:

9B Wheatstone Court. Waterwells
Business Park, Gloucester, GL2-2AQ,
UK United Kingdom
Tel: +44(0) 1452 729428 / 1452 729696
Fax: +44 (0)1452-690125
E-mail: Sales.Europe@leoch.com