

JYHY26000G(2V600AH) is GEL battery which is manufactured with colloidal Silicon and sulfuric acid .It's featured with low self-discharge ,strong ability to recover from deep discharging, good low temperature properties

JYHY26000G(2V600AH)胶体电池采用纳米级的二氧化硅硫酸胶体技术制造,具有自放电量小,过放电恢复能力强,低温性能好的特点

Performance Characteristics 基本特性

Nominal Voltage标准电压		2V
Number of cell 单格数		1
Capacity (25°C) 容量	100HR (7.2A, 1.85V)	720Ah
	20HR (31.8A, 1.8V)	636Ah
	10HR (60A, 1.8V)	600Ah
	1HR (58.8A, 1.6V)	352.8Ah
Approx. Weight 重量		37kg (81.57lbs) ±3%
Internal resistance 内阻 (Fully charged, 25°C)		Approx. 0.25mΩ
Capacity affected by temperature (10HR) 不同温度下的 10小时率容量	40°C	102%
	25°C	100%
	0°C	85%
	-15°C	65%
The self-discharge rate is less than 3% monthly at average 25°C. For higher temperature, the time interval will be shorter. 在常温25°C度的情况下,自放电率小于3%(每月), 储存温度越高,则存放时间会相应缩短		
Nominal operating temperature 标准使用温度		25°C ±3°C (77°F ±5°F)
Operating temperature range 使用温度范围	Discharge 放电温度: -15°C~50°C (5°F~122°F)	
	Charge 充电温度: -10°C~50°C (14°F~122°F)	
	Storage 储存温度: -20°C~50°C (-4°F~122°F)	
Charge (Constant Voltage) 充电电流/电压	Float 浮充使用:2.23~2.28V/77° F/(25°C)	
	Cycle 循环使用:2.38~2.42V/77° F/(25°C) Max Current 最大电流:120A	
Discharging current 77° F/(25°C):2400A (5S) 放电电流(25°C):2400A (5秒)		
Designed floating life(20°C) 设计浮充使用寿命		15~18 years

Certificate认证



Outer dimension(mm)电池尺寸

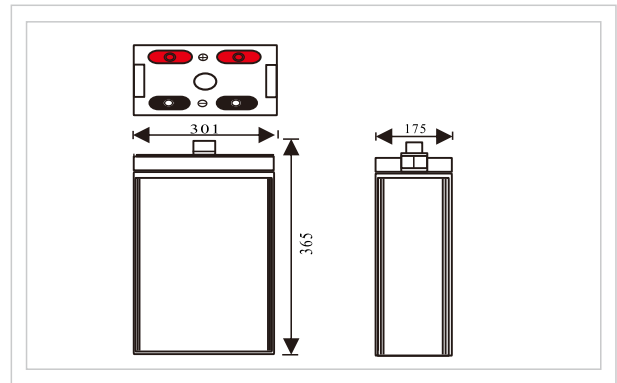

Terminal dimension(mm)端子尺寸

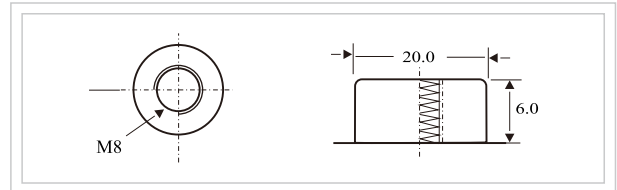

Battery Construtiion电池结构

Terminal material 端子	Copper 铜
Positive plate 正极板	Lead dioxide 二氧化铅
Negative plate 负极板	Lead 铅
Container 胶壳	ABS
Cover 胶盖	
Safety valve 安全阀	Rubber 橡胶
Separator 隔板	Fiberglass/PE 玻璃纤维/PE
Electrolyte 电解质	Colloidal silicon 硅溶胶

Constant Current (Amp) and Constant Power (Watt) Discharge Table at 25°C (77° F) 恒流放电与恒功率放电表

Time时间 F.V 终止电压	Time时间											
	30min	60min	2h	3h	4h	5h	6h	8h	10h	20h	24h	
1.60V	恒流(A)	540	360	219	156	125	109	94	73	61	32	28
	恒功率(W)	1010	684	423	306	246	215	184	146	122	64	56
1.65V	恒流(A)	529	355	218	155	125	108	93	73	61	32	28
	恒功率(W)	989	674	421	304	244	214	184	145	121	64	56
1.70V	恒流(A)	513	346	216	154	124	107	92	73	61	32	28
	恒功率(W)	959	656	417	302	243	212	182	144	121	64	56
1.75V	恒流(A)	500	339	213	153	123	107	92	72	61	32	27
	恒功率(W)	936	644	410	300	241	211	181	143	120	64	55
1.80V	恒流(A)	482	328	208	148	119	104	89	70	60	32	27
	恒功率(W)	902	624	400	291	234	204	175	139	119	63	55

