

JYHY220000G(2V2000AH) is GEL battery which is manufactured with colloidal Silicon and sulfuric acid .It's featured with low self-discharge ,strong ability to recover from deep discharging, good low temperature properties

JYHY220000G(2V2000AH)胶体电池采用纳米级的二氧化硅硫酸胶体技术制造,具有自放电小,过放电恢复能力强,低温性能好的特点

Performance Characteristics 基本特性

Nominal Voltage标准电压		2V
Number of cell 单格数		1
Capacity (25℃) 容量	100HR (24A, 1.85V)	2400Ah
	20HR (106A, 1.8V)	2120Ah
	10HR (200A, 1.8V)	2000Ah
	1HR (1176A, 1.6V)	1176Ah
Approx. Weight 重量		119kg (262.35lbs) ±3%
Internal resistance 内阻 (Fully charged, 25℃)		Approx. 0.05mΩ
Capacity affected by temperature (10HR) 不同温度下的 10小时率容量	40℃	102%
	25℃	100%
	0℃	85%
	-15℃	65%
The self-discharge rate is less than 3% monthly at average 25℃. For higher temperature, the time interval will be shorter. 在常温25℃度的情况下,自放电率小于3%(每月), 储存温度越高,则存放时间会相应缩短		
Nominal operating temperature 标准使用温度		25℃ ± 3℃ (77°F ± 5°F)
Operating temperature range 使用温度范围	Discharge 放电温度: -15℃~50℃ (5°F~122°F)	
	Charge 充电温度: -10℃~50℃ (14°F~122°F)	
	Storage 储存温度: -20℃~50℃ (-4°F~122°F)	
Charge (Constant Voltage) 充电电流/电压	Float 浮充使用: 2.23~2.28V/77° F/(25℃)	
	Cycle 循环使用: 2.38~2.42V/77° F/(25℃) Max Current 最大电流: 400A	
Discharging current 77° F/(25℃): 8000A (5S) 放电电流(25℃): 8000A (5秒)		
Designed floating life (20℃) 设计浮充使用寿命		15~18 years

Certificate 认证



Outer dimension(mm) 电池尺寸

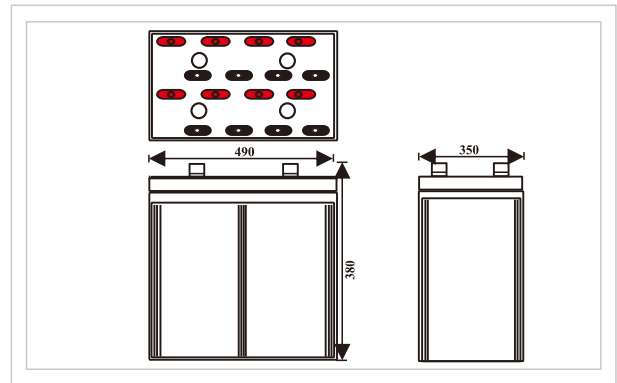

Terminal dimension(mm) 端子尺寸

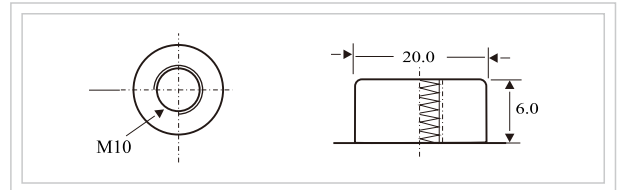

Battery Construtiion 电池结构

Terminal material 端子	Copper 铜
Positive plate 正极板	Lead dioxide 二氧化铅
Negative plate 负极板	Lead 铅
Container 胶壳	ABS
Cover 胶盖	
Safety valve 安全阀	Rubber 橡胶
Separator 隔板	Fiberglass/PE 玻璃纤维/PE
Electrolyte 电解质	Colloidal silicon 硅溶胶

Constant Current (Amp) and Constant Power (Watt) Discharge Table at 25℃ (77° F) 恒流放电与恒功率放电表

F.V 终止电压	Time 时间	30min	60min	2h	3h	4h	5h	6h	8h	10h	20h	24h
		1.60V	恒流(A)	1800	1200	730	520	418	364	312	244	204
	恒功率(W)	3366	2280	1410	1020	820	716	614	488	406	214	186
1.65V	恒流(A)	1764	1182	726	518	416	360	310	244	204	107	92
	恒功率(W)	3298	2246	1402	1014	814	712	612	484	404	214	186
1.70V	恒流(A)	1710	1152	720	514	412	358	308	242	202	106	92
	恒功率(W)	3198	2188	1390	1006	810	706	608	480	404	212	185
1.75V	恒流(A)	1668	1130	710	510	410	356	306	240	202	106	92
	恒功率(W)	3120	2146	1368	1000	804	702	602	478	400	212	184
1.80V	恒流(A)	1608	1094	692	494	398	346	296	232	200	105	91
	恒功率(W)	3006	2080	1334	970	780	680	584	464	398	210	183

