

**PERC MONO CRYSTALLINE-----HALF CELLS
BIFACIAL DOUBLE GLASS MODULE**

GH455M6-B72HSW-C

440 / 445 / 450 / 455



High application, patent protection frame



Technology

High module conversion efficiency through superior manufacturing technology



PID Free

Excellent PID resistance according to IEC TS 62804-1



Performance

High performance under low light conditions (Cloudy days, mornings and evenings)



Quality

Manufactured according to International Quality and Environmental Management Systems (ISO9001, ISO14001)



Value

Our vertically integrated business model allows for competitive pricing and great value

Superior Manufacturing-Quality Assurance



- TQC & SPC quality control systems
- Advanced cell sorting to avoid electric mismatch
- 100% twice EL tests

High ornamental value

The frame structure can replace the module embedded in the building structure, improve the beauty, and have good practicality

Insert block and groove design

Short bearing distance, good fixing effect, wide application range

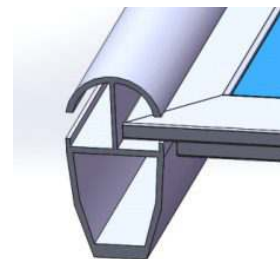

Tier 1



Warranty

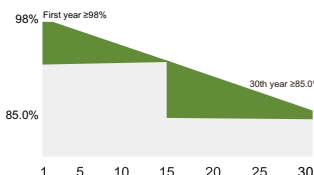

- 15 Years product warranty
- 30 Years power output warranty

Electrical Specifications

* STC irradiance of 1000W/m² spectrum AM 1.5 and cell temperature of 25°C

Module Type	Pm(W)	Tolerance	Imp(A)	Vmp(V)	Isc(A)	Voc (V)	Module Efficiency
GH440M6-B72HSW-C	440	0/+3%	10.84	40.60	11.26	49.97	19.64%
GH445M6-B72HSW-C	445	0/+3%	10.92	40.77	11.35	50.12	19.87%
GH450M6-B72HSW-C	450	0/+3%	11.01	40.91	11.43	50.27	20.10%
GH455M6-B72HSW-C	455	0/+3%	11.10	41.04	11.51	50.42	20.31%

Bifaciality:70%±10%

Bifacial Gain

		440W	445W	450W	455W
10%	Pm(STC)	484W	490W	495W	501W
20%	Pm(STC)	528W	534W	540W	546W
30%	Pm(STC)	572W	579W	585W	592W

Mechanical Data

Cell Type	P type Mono-crystalline
Cell Arrangement	144(6x24)
Module Structure	Glass / Glass
Glass Thickness	2.0mm +2.0mm
PV module classification	Class II
Junction Box Rating	IP 68
Cables(Positive/Negative)	4mm ² /(+)60mm;(-)275mm or Customized

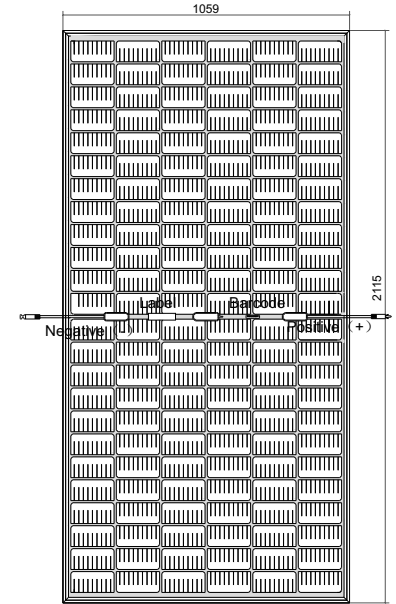

(Back side)

Note: mm

Maximum Ratings

Operating Temperature	-40°C to +85°C
Maximum System Voltage	1500V DC(IEC) 202B/MC4-Evo2 1000V DC(IEC) MC4
Maximum Series Fuse Rating	30A
Number of Diodes	3

Current-Voltage&Power-Voltage Curve(455W)

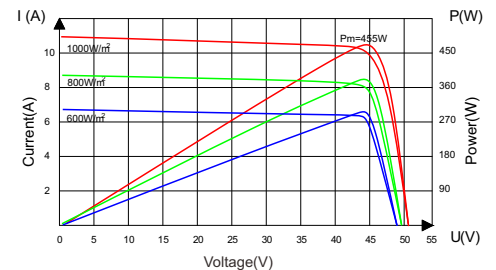

Packaging

Module Dimensions	2115x1059x12mm,4mm at edge
Weight	27.0kg
Container	40' HQ
Pieces per Pallet	34
Pieces per Container	680

Temperature Dependence of Isc, Voc, Pmax(°C)

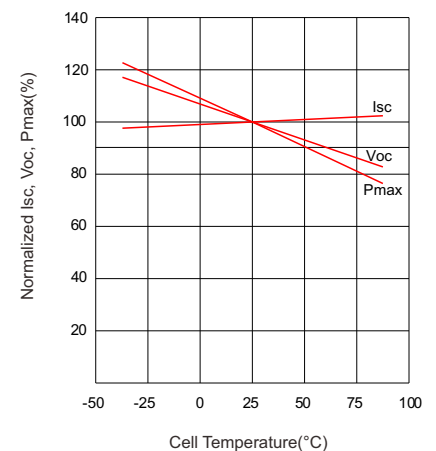

Temperature Characteristics

Temperature Coefficient of Isc	+0.0487%/°C
Temperature Coefficient of Voc	-0.256%/°C
Temperature Coefficient of Pmax	-0.328%/°C

Statement: Due to technological progress, product parameters will be adjusted accordingly; When signing the contract, the latest data of the company shall prevail.



Hengdian Group DMEGC Magnetics Co., Ltd.
Hengdian Industrial Zone, Dongyang City
Zhejiang Province, China 322118

Tel: 0086-579-8658-8825 Fax: 0086-579-8655-4845

Email: solar@dmegec.com.cn

www.chinadmegec.com www.dmegec.solar