

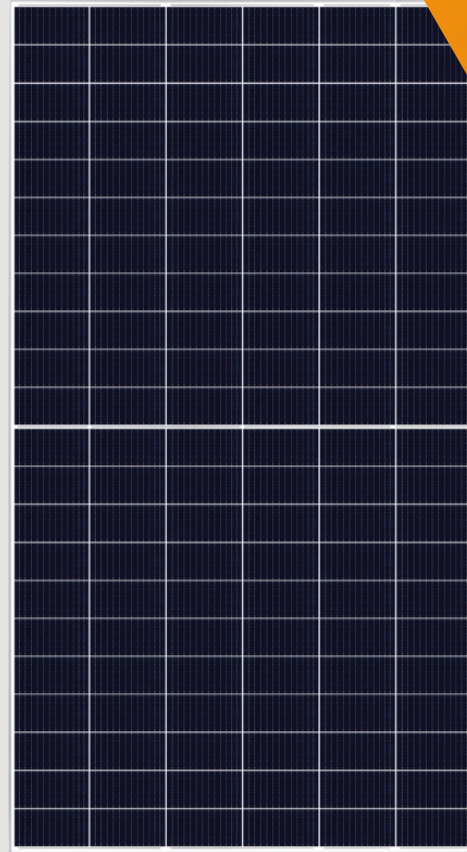

NPV132-9-675BN

- **132 CELL**
Mono TOPCON Module
- **1500VDC**
Maximum System Voltage
- **675-695Wp**
Power Output Range
- **22.4%**
Maximum Efficiency



KEY SALIENT FEATURES

- Global, bankable brand, with independently certified state-of-the-art automated manufacturing
- Industry leading lowest thermal co-efficient of power
- Industry leading 12 years product warranty
- Excellent low irradiance performance
- Excellent PID resistance
- Positive power tolerance of 0~+3%
- Dual stage 100% EL Inspection warranting defect-free product
- Module Imp binning radically reduces string mismatch losses
- Excellent wind load 2400Pa & snow load 5400Pa under certain installation method
- Comprehensive product and system certification
 - ◆ IEC61215:2016; IEC61730-1/-2:2016;
 - ◆ ISO 9001:2015 Quality Management System
 - ◆ ISO 14001:2015 Environmental Management System
 - ◆ ISO 45001:2018 Occupational Health and Safety Management System

HIGH PERFORMANCE N-TYPE TOPCON MONOCRYSTALLINE MODULE

LINEAR PERFORMANCE WARRANTY

12 year Product Warranty / 25 year Linear Power Warranty

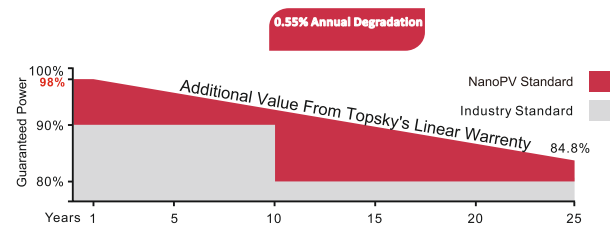

★ Please check the valid version of Limited Product Warranty which is officially released by NanoPV

Dimensions of PV Module Unit: mm

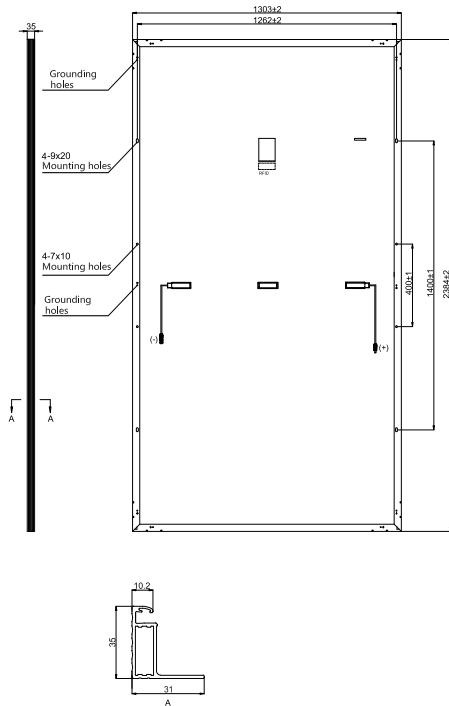

ELECTRICAL DATA (STC)

| Model Number | NPV132-9-675BN | NPV132-9-680BN | NPV132-9-685BN | NPV132-9-690BN | NPV132-9-695BN |
|-------------------------------|----------------|----------------|----------------|----------------|----------------|
| Rated Power in Watts-Pmax(Wp) | 675 | 680 | 685 | 690 | 695 |
| Open Circuit Voltage-Voc(V) | 47.36 | 47.55 | 47.74 | 47.93 | 48.12 |
| Short Circuit Current-Isc(A) | 17.96 | 18.02 | 18.08 | 18.14 | 18.20 |
| Maximum Power Voltage-Vmpp(V) | 39.52 | 39.70 | 39.88 | 40.06 | 40.24 |
| Maximum Power Current-Impp(A) | 17.09 | 17.14 | 17.18 | 17.22 | 17.27 |
| Module Efficiency (%) | 21.7 | 21.9 | 22.1 | 22.2 | 22.4 |

STC: Irradiance 1000 W/m², Cell Temperature 25°C, Air Mass AM1.5 according to EN 60904-3.
 ★ Module Efficiency (%): Round-off to the nearest number

ELECTRICAL DATA (NMOT)

| Model Number | NPV132-9-675BN | NPV132-9-680BN | NPV132-9-685BN | NPV132-9-690BN | NPV132-9-695BN |
|-------------------------------|----------------|----------------|----------------|----------------|----------------|
| Rated Power in Watts-Pmax(Wp) | 511.3 | 515.1 | 518.7 | 522.2 | 526.1 |
| Open Circuit Voltage-Voc(V) | 44.05 | 44.22 | 44.40 | 44.58 | 44.75 |
| Short Circuit Current-Isc(A) | 14.73 | 14.78 | 14.83 | 14.88 | 14.93 |
| Maximum Power Voltage-Vmpp(V) | 36.67 | 36.84 | 37.01 | 37.18 | 37.34 |
| Maximum Power Current-Impp(A) | 13.94 | 13.98 | 14.02 | 14.05 | 14.09 |

NMOT: Irradiance at 800 W/m², Ambient Temperature 20°C, Wind Speed 1 m/s.

MECHANICAL DATA

| | |
|--------------------|--|
| Solar cells | N-TYPE TOPCON Monocrystalline |
| Cell configuration | 132 cells (6×11+6×11) |
| Module dimensions | 2384×1303×35mm |
| Weight | 33.5kg |
| Superstrate | High Transmission, Low Iron, Tempered ARC Glass |
| Substrate | White Back-sheet |
| Frame | Anodized Aluminium Alloy, Silver Color |
| J-Box | Potted, IP68, 1500VDC, 3 Schottky bypass diodes |
| Cables | 4.0mm ² , Positive(+)350mm, Negative(-)230mm (Connector Included) |
| Connector | IP68 |

TEMPERATURE & MAXIMUM RATINGS

| | |
|---|-------------|
| Nominal Module Operating Temperature (NMOT) | 44°C±2°C |
| Temperature Coefficient of Voc | -0.25%/°C |
| Temperature Coefficient of Isc | 0.04%/°C |
| Temperature Coefficient of Pmax | -0.34%/°C |
| Operational Temperature | -40°C~+85°C |
| Maximum System Voltage | 1500VDC |
| Max Series Fuse Rating | 30A |
| Limiting Reverse Current | 30A |

PACKAGING CONFIGURATION

| | |
|--|----------------|
| | 40ft(HQ) |
| Number of modules per container | 558 |
| Number of modules per pallet | 31 |
| Number of pallets per container | 18 |
| Packaging box dimensions (LxWxH) in mm | 1320×1120×2515 |
| Box gross weight[kg] | 1090 |

CAUTION: READ SAFETY AND INSTALLATION INSTRUCTIONS BEFORE USING THE PRODUCT.
 ©2023 NanopV. All rights reserved. Contents included in this datasheet are subject to change without notice.
 No special undertaking or warranty for the suitability of special purpose or being installed in extraordinary surroundings is granted unless as otherwise specifically committed by manufacturer in contract document.

Contact US:

NanoPV Solar Inc.,
 103 Carnegie Center Dr.,
 Princeton,
 New Jersey - 08540,
 USA.
Email: info@nano-pv.com
Website: www.nano-pv.com

