

# Lithium Iron Phosphate(LiFePO<sub>4</sub>) Battery

## ALFP-48100(51.2V 100Ah)



### Features Of LiFePO<sub>4</sub> Battery

**Longer Cycle Life:** Offers up to 10 times longer cycle life and five times longer float/calendar life than lead acid battery, helping it minimize replacement cost and reduce total cost of ownership.

**Lighter Weight:** About 40% of the weight of a comparable lead acid battery. A 'drop in' replacement for lead acid batteries.

**Higher Power:** Delivers twice power of lead acid battery, even high discharge rate, while maintaining high energy capacity.

**Wider Temperature Range:** -20 ~ 60°C

**Superior Safety:** Lithium Iron Phosphate chemistry eliminates the risk of explosion or combustion due to high impact, overcharging or short circuit situation.



### Physical Dimension-mm

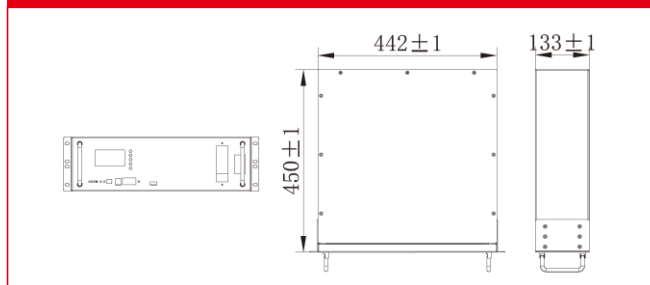

### Application

- Indoor/outdoor telecom base stations
- ETC
- UPS
- Household energy storage system
- Smart transportation backup power supply

### Specification

|                            |                                 |                                  |
|----------------------------|---------------------------------|----------------------------------|
| Electrical Characteristics | Nominal Voltage                 | 51.2V                            |
|                            | Nominal Capacity                | 100Ah                            |
|                            | Nominal Energy                  | 5120Wh                           |
|                            | Combination Method              | 16S1P                            |
|                            | Cycle Life                      | ≥3500 cycles @80%DOD @35°C       |
|                            | Months Self Discharge           | 1%/Month                         |
|                            | Efficiency of Charge            | ≥97%                             |
|                            | Efficiency of Discharge         | ≥98%                             |
| Standard Charge            | Recommended Charging Voltage    | 56.8V                            |
|                            | Recommended Charging Current    | 20A                              |
|                            | Max. Charging Voltage           | 57.6V                            |
|                            | Max. Charging Current           | 100A                             |
| Standard Discharge         | Recommended Discharging Current | 50A                              |
|                            | Max. Pulse Current              | 100A                             |
|                            | Discharge Cut-off Voltage       | 43.2V                            |
| Environmental              | Charge Temperature              | 0°C ~ 55°C                       |
|                            | Discharge Temperature           | -20°C ~ 60°C                     |
|                            | Storage Temperature             | 0°C ~ 40°C                       |
| Other                      | IP Class                        | IP30                             |
|                            | Plastic Case                    | Metal                            |
|                            | Dimensions ( in. /mm. )         | 442*133*450mm                    |
|                            | Weight ( lbs. /kg. )            | 45kg                             |
|                            | Others ( optional )             | Anti-theft function, LCD display |