

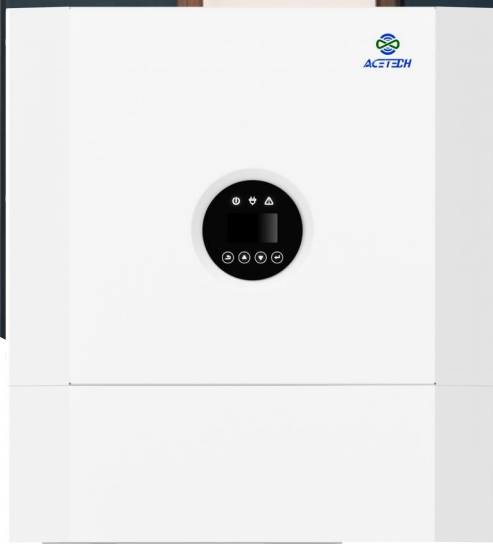

ACETECH

RESS P20

HYBRID INVERTER FOR RESIDENTIAL ENERGY STORAGE SYSTEM (LOW VOLTAGE)



KEY FEATURES



Hybrid Power Leverage



Supports PV, grid and battery power for home use. Power priority management to maximumly reduce electricity bills and backup critical loads.



High-Level Integration



DC coupled system. Shortens power conversion flow to get low power loss.



Highly Compatible With Self-designed Battery Energy Storage Systems



Deeply communicate and coordinate between inverter and battery, enhancing the system reliability considerably.



Multi-communication Capabilities



Supports RS485, CAN2.0, WIFI, and 4G communication.



Concise Human-machine Interface



Easily operated local LCD display and app. Quick status indicators.



Safe Design



Multiple protection and detection function provide a full safety guarantee.

COMPATIBLE BATTERY SYSTEM

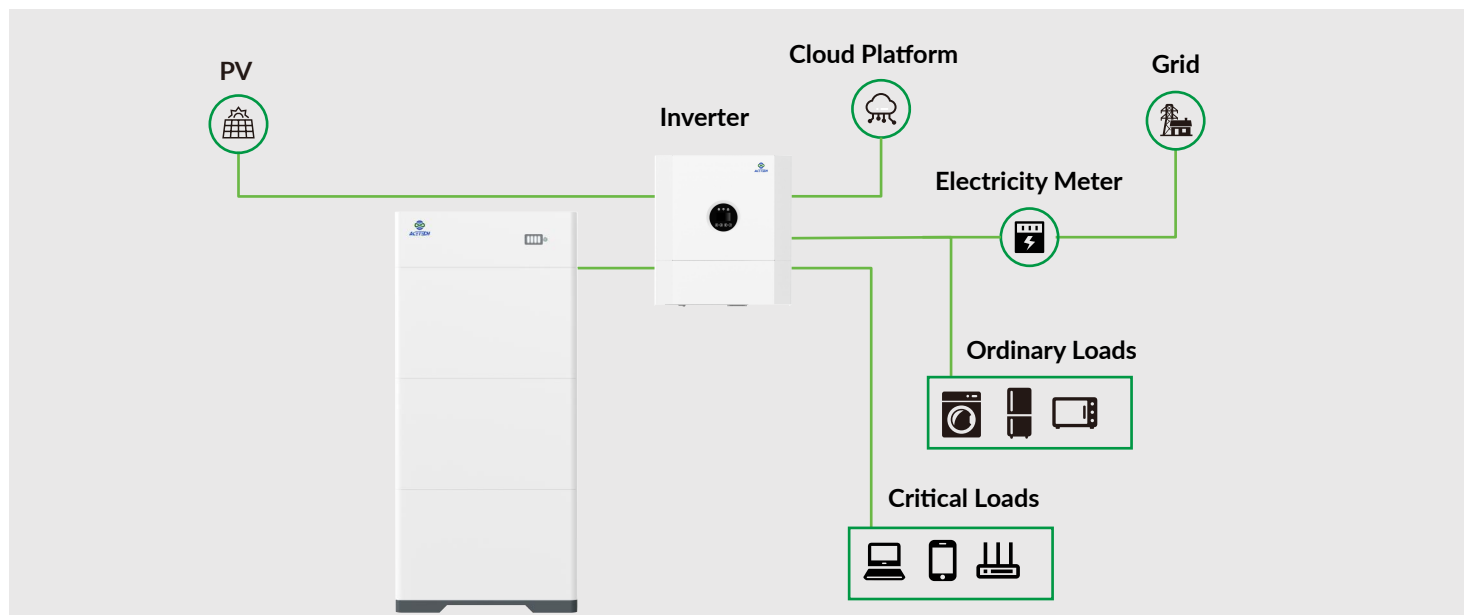

TECHNICAL DATA

Hybrid Inverter Model	RESS-1P-3.6K-L00	RESS-1P-5K-L00	RESS-1P-6K-L00	RESS-3P-8K-L00	RESS-3P-10K-L00
Output (On Grid)					
Rated Output Active Power	3680W	5000W ¹	6000W	8000W	10000W
Max. Output Apparent Power	7360VA	7360VA	7360VA	8800VA	11000VA
Rated AC Voltage		230V		400V	
AC Voltage Range		150~280V		320~480V	
AC Frequency Range			50 / 60Hz±5Hz		
Wiring		L-N-G		L1/L2/L3-N-G	
Max. Output Current	16A	22A ²	25A	12.8A	16A
Max. Input Current		32A		25A	
Power Factor (cosΦ)			0.8 leading – 0.8 lagging		
THDI			<3%		
Output (Back up)					
Rated Output Apparent Power	4000VA	5000VA	5000VA	8000VA	10000VA
Rated Output Active Power	3680W	4600W	4600W	7360W	9200W
Rated Output Voltage		230V		400V	
Rated Output Frequency			50/60Hz		
Max. Output Current	16A	20A	20A	11.6A	14.5A
THDV (@Linear Load)		<3%		<2%	
Switch Time			<20ms		
PV String Input					
Recommended Max. PV Input Power	4800W	6500W	7500W	16000W	20000W
Rated DC Voltage		400V		720V	
Max. Voltage Range		80V~580V		140V~1100V	
Startup Voltage		150V		200V	
MPPT Voltage Range		80V~560V		140V~1000V	
Number of MPPTs			2		
Max. Number of PV Strings per MPPT			1		
Max. Input Current per MPPT			15A		
Max. Short-Circuit Current per MPPT		18A		20A	

¹1. Australia 4999W, Germany and South Africa 4600W.

²2. Australia 21.7A, Germany and South Africa 20A.

TECHNICAL DATA

Hybrid Inverter Model	RESS-1P-3.6K-L00	RESS-1P-5K-L00	RESS-1P-6K-L00	RESS-3P-8K-L00	RESS-3P-10K-L00
Battery					
Battery Type	LFP (LiFePO4)				
Rated Battery Voltage	48V		51.2V		
Battery Voltage Range	40-60V		44-58V		
Max. Charging Current	50A	100A	100A	160A	
Max. Discharging Current	80A	100A	100A	200A	
Efficiency					
Max. PV Efficiency	97.6%				
Euro. PV Efficiency	97.0%				
Protection					
PV Over Voltage Protection	Yes				
String Fault Detection	Yes				
Residual Current Detection	Yes				
Insulation Detection	Yes				
Anti-Islanding Protection	Yes				
DC Switch (Battery)	Yes				
DC Reverse Polarity Protection (Both PV and Battery)	Yes				
AC/DC Surge Protection	DC Type II / AC Type III				
AC Over Voltage Protection	Yes				
AC Over Current Protection	Yes				
AC Short Circuit Protection	Yes				
Leakage Current Detection	Yes				
Ground Connection Detection	Yes				
Function					
Battery Charging from Grid	Yes				
Remote On/Off	Yes				
OTA	Yes				
General					
Dimensions W*H*D	540*590*240mm			540*980*240mm	
Net Weight	32kg			49kg	
Installation	Wall-mounted				
Operating Temperature Range	-25°C~+60°C, (derating above 40°C)				
Storage Temperature Range	-40°C~70°C				
Max. Operating Altitude	2000m (no derating)				
Relative Humidity Range	0~95% (No Condensation)				
Ingress Protection Rating	IP65				
Cooling	Natural convection				
Noise	<35dB			<55dB	
Communication	RS485/CAN2.0/WIFI/(4G option)				
Display	LCD/APP				
Warranty	5 years (expand to 10 years)				
Certification					
Certification	CE; IEC/EN 62109-1&2; IEC/EN61000-6-1/2/3/4; IEC/EN61000-3-11/12; IEC60529; IEC 60068; IEC61683; IEC62116; IEC61727; EN50549-1; VDE-AR-N-4105; C10/C11; G98, G99; CEI0-21; UNE 217001, UNE 217002 NTS V2.1; VDE 0126; EN50549+NC; RfG+PTPIREE; AS 4777.2; NRS 097			CE; IEC/EN 62109-1&2; IEC/EN61000-6-1/2/3/4; IEC/EN61000-3-11/12; IEC60529; IEC 60068; IEC61683; IEC62116; IEC61727; EN50549-1; VDE-AR-N-4105; G98; CEI0-21; VDE 0126; EN50549+RfG+EIFS; EN50549+NC RfG+PTPIREE;	
Compatible Battery System					
Compatible Battery System	RESS-BS-6.6-L0; RESS-BS-13.2-L0; RESS-BS-19.8-L0				



Follow us

ACE GROUP

Tel: +86-755-8887 8567

E-mail: sales@acebattery.com

Headquarters: 29F, Hanking Financial Center, No.9968 Shennan Avenue, Nanshan District, Shenzhen, China

Factory: Block B, BAK Industrial Park, Kuipeng Rd., Dapeng, Shenzhen, China

Web: www.acebattery.com