

CZV300-6

6V 300AH

OPzV



CZV300-6

Awaiting Image

Physical Specification

| | |
|------------------------------|------------|
| Part Number | CZV300-6 |
| Length | 145 ± 2 mm |
| Width | 206 ± 2 mm |
| Container Height | 355 ± 2 mm |
| Total Height (with terminal) | 390 ± 2 mm |
| Approx Weight | 26.0 kg |

Specifications

| | | |
|--------------------------------|-------------------------------------------------------------------------------------------------------------------------------------------------------------------|-------------------------------------------------------------------------------------------|
| | Nominal Voltage | 6V |
| | Nominal Capacity (20HR) | 300.0AH |
| Terminal Type | Standard Terminal | T11 |
| Container Material | Standard Option | ABS |
| | Flame Retardant Option (FR) | ABS (UL94:VO) |
| Rated Capacity | 10hr, 1.80V/cell, 25°C | 300 AH/30.0A |
| | 5hr, 1.75V/cell, 25°C | 263 A H/52.6A |
| | 3hr, 1.75V/cell, 25°C | 233.7 AH/77.9A |
| | 1hr, 1.60V/cell, 25°C | 171 AH/171A |
| Max Discharge Current | 2400A (5s) | |
| Internal Resistance | Approx 1.0mΩ | |
| Discharge Characteristics | Operating Temp. Range | Discharge: -20 ~ 55°C |
| | | Charge: 0 ~ 40°C |
| | | Storage: -20 ~ 50°C |
| | Cycle Use | Initial Charging Current less than 75.0A. Voltage 2.40V ~ 2.50V Temp. Coefficient -5mV/°C |
| | Standby Use | No limit on Initial Charging Current Voltage 2.25V ~ 2.30V Temp. Coefficient -3mV/°C |
| Capacity affect by Temperature | 40°C | 103% |
| | 25°C | 100% |
| | 0°C | 86% |
| Design Floating Life at 20°C | 20 Years | |
| Self Discharge | Canbat batteries may be stored for up to 6 months at 25°C(77°F) and then a refresh charge is required. For higher temperatures the time interval will be shorter. | |

Dimensions

T11 Terminal

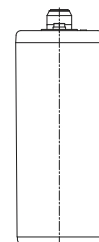
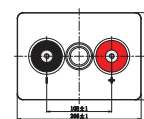
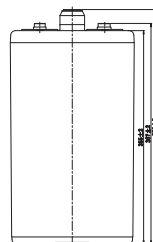
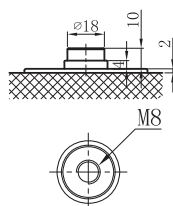

ALL DATA IS SUBJECT TO CHANGE WITHOUT NOTICE

Constant Current Discharge (Amperes) at 20°C

| F.V/Time | 10min | 15min | 30min | 1h | 2h | 3h | 5h | 8h | 10h |
|------------|-------|-------|-------|-----|------|------|------|------|------|
| 1.85V/cell | 256 | 233 | 183 | 135 | 91.2 | 70.0 | 47.8 | 33.3 | 28.1 |
| 1.80V/cell | 315 | 282 | 214 | 152 | 100 | 76.2 | 51.6 | 35.7 | 30.0 |
| 1.75V/cell | 373 | 316 | 228 | 158 | 103 | 77.9 | 52.6 | 36.3 | 30.5 |
| 1.70V/cell | 418 | 344 | 241 | 164 | 106 | 79.5 | 53.4 | 36.8 | 30.8 |
| 1.65V/cell | 449 | 364 | 251 | 168 | 108 | 81.0 | 54.2 | 37.2 | 31.1 |
| 1.60V/cell | 470 | 377 | 257 | 171 | 109 | 81.9 | 54.8 | 37.5 | 31.4 |

Constant Power Discharge (Watts) at 20°C

| F.V/Time | 10min | 15min | 30min | 1h | 2h | 3h | 5h | 8h | 10h |
|------------|-------|-------|-------|-----|-----|-----|------|------|------|
| 1.85V/cell | 476 | 438 | 350 | 260 | 177 | 137 | 94.1 | 66.1 | 55.9 |
| 1.80V/cell | 576 | 522 | 404 | 291 | 194 | 148 | 101 | 70.6 | 59.6 |
| 1.75V/cell | 669 | 577 | 426 | 301 | 198 | 151 | 103 | 71.7 | 60.4 |
| 1.70V/cell | 738 | 620 | 447 | 311 | 202 | 153 | 104 | 72.4 | 61.0 |
| 1.65V/cell | 778 | 645 | 460 | 317 | 205 | 155 | 105 | 73.1 | 61.5 |
| 1.60V/cell | 799 | 658 | 467 | 321 | 207 | 157 | 106 | 73.5 | 61.9 |

Discharge Characteristics

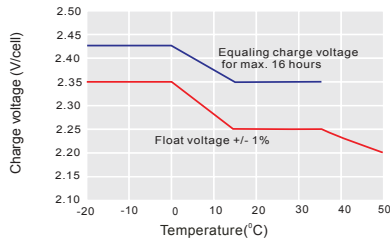

For continuous charging we recommend a voltage of 2.25 V. The charging voltage must be compensated to the curve for continuously different battery ambient temperature.

Float Charging Characteristics

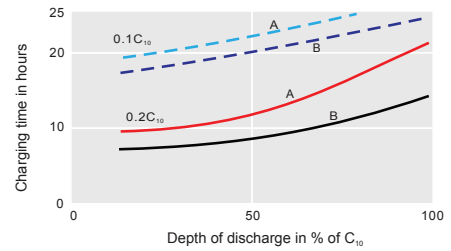

Charge voltage:
 A—2.25 V/cell B—2.40 V/cell
 --- State of charge 100% --- State of charge 90%

Temperature Effects in Relation to Battery Capacity

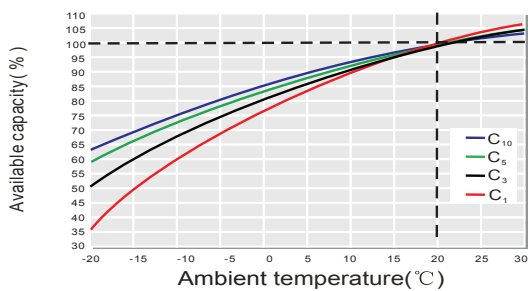

Effect of Temperature on Long Term Float Life

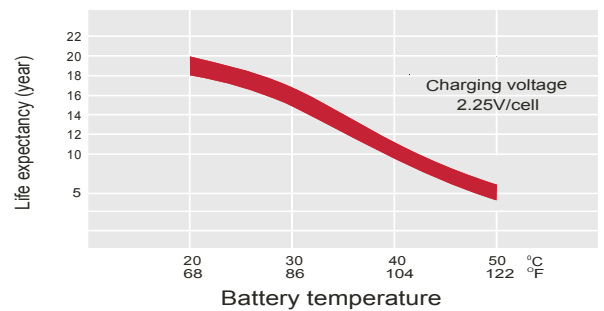

Cycle Life in Relation to Depth of Discharge

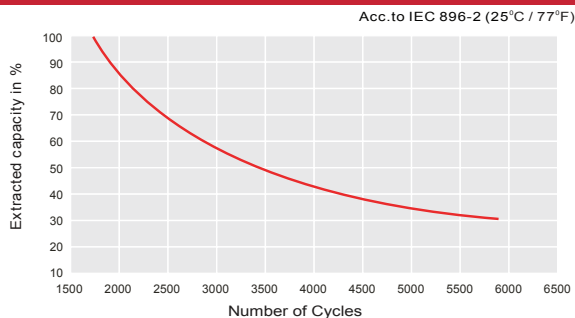

General Relation of Capacity VS. Storage Time

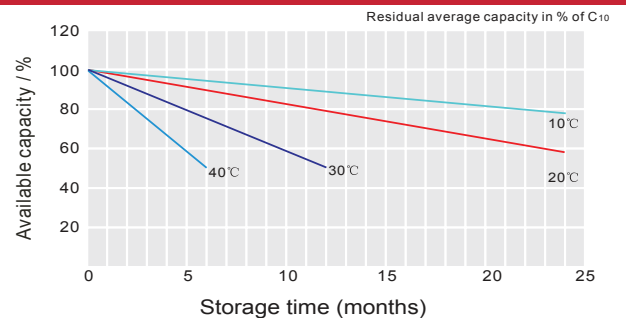

ALL DATA IS SUBJECT TO CHANGE WITHOUT NOTICE