

HP590 Series

3~6KW | Single Phase | 230VAC

HP590 series PV inverters take full account of the needs of end customers, with excellent performance at the same time, use LED as inverter status display, effectively improve product life. Using DSP digital control, could afford wide grid voltage range, have a full range of protection features; to maximize the benefits at the same time, greatly enhance the reliability of the product.



- High Frequency On Grid Solar Inverter
- Rate power: 3-6KW
- MPPT efficiency up to 99.50%
- Multiple communications: WIFI etc
- Monitoring inverters freely via mobile phones APP
- Fanless low-noise design
- IP66 water-proof and dust-proof

Back panel description

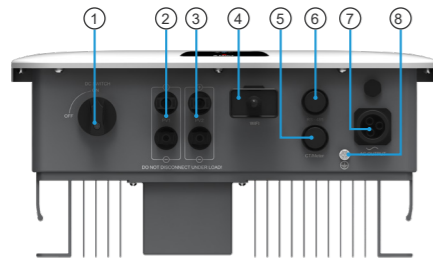

1. DC switch
2. PV1 input
3. PV2 input
4. WIFI connector
5. CT/Meter port
6. RS-485 connector
7. AC output
8. Ground

Solar system connection

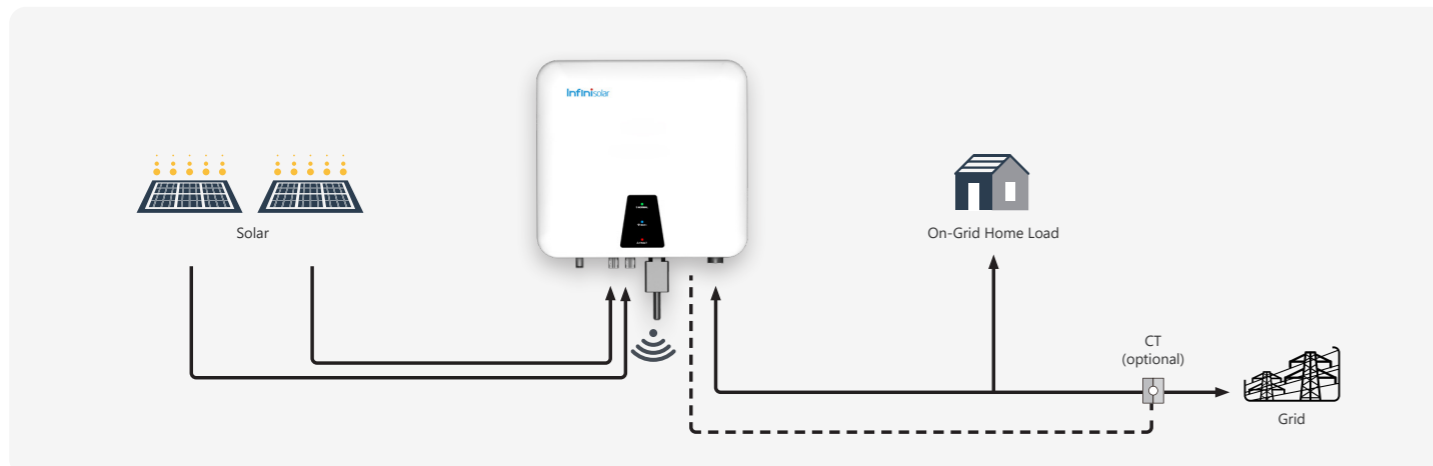

Specification

MODEL	HP590-3000M	HP590-3600M	HP590-4200M	HP590-4600M	HP590-5000M	HP590-6000M
Rated AC output power	3000W	3600W	4200W	4600W	5000W	6000W
PV INPUT(DC)						
Maximum recommended DC power	3900W	4700W	5460W	5980W	6500W	7800W
Nominal DC operating voltage	360V					
Maximum DC voltage	550V					
Start voltage	50V					
MPPT voltage range	40~550V					
Maximum input current	16A/16A					
No. of MPP tracker/ strings per MPP tracker	2/1					
DC connection	H4/MC4					
GRID OUTPUT(AC)						
Nominal AC output power	3000W	3600W	4200W	4600W	5000W	6000W
Max. AC output power	3000VA	3600VA	4200VA	4600VA	5000VA	6000VA
AC grid frequency	50/60Hz ±5Hz					
Maximum output current	13.6A	16A	19A	20.9A	22.7A	27.2A
AC nominal voltage	220V/230V/240V					
AC voltage range	180-280V					
Total harmonic distortion (THDi)	<3%					
Rate power factor	1					
Power factor adjustable range	0.8 leading ~ 0.8 lagging					
AC grid connection type	L+N+PE					
EFFICIENCY						
Maximum efficiency	98.0%	98.0%	98.1%	98.1%	98.2%	98.2%
Euro-efficiency	96.8%	96.8%	97.0%	97.0%	97.2%	97.2%
MPPT efficiency	99.5%					
Self-Consumption night	<1W					
PROTECTION DEVICES						
Output over current protection	Yes					
Output AC overvoltage protection	Yes					
DC reverse polarity protection	Yes					
DC switch	Yes					
Ground fault monitoring	Yes					
Integrated all-pole sensitive leakage current monitoring unit	Yes					
PHYSICAL						
Machine Dimension (W*H*D)(mm)	378*402*195					
Package Dimension (W*H*D)(mm)	/					
N.W(kg)	11					
G.W(kg)	/					
INTERFACE						
DC connection	H4/MC4					
AC connection	Connector					
Display	LED					
Communication interfaces	WIFI/RS485/GPRS(opt)					
ENVIRONMENT						
Ingress protection rating	IP66					
Humidity	0-100%					
Operating temperature range	-25°C~+60°C With derating above 45°C					
Cooling concept	Natural					
Noise emission(typical)[dB]	≤35dB(A)					
Self-consumption night	<1W					
Topology	Transformerless					
Altitude	4000m					
OTHERS						
Topology	transformerless					
Warranty	Standard 5years/10 years(opt.)					