

M10
182X182
HALF-CELL

IMPROVED LOAD

pressure
6200

tensile
4200

TESTED

TOPCON
CELLS INSIDE

SMBB
HALF-CELL
MONO PV MODULE

IBEX 108MHC-TOPCON
420/425/430/435/440

IBEX HIGH EFFICIENCY MONOCRYSTALLINE SOLAR MODULES WITH TOPCON CELLS TECHNOLOGY



SMBB TECHNOLOGY



EXCELLENT ANTI-PID
LOW LID PERFORMANCE



N-TOPCON CELL TECHNOLOGY



HIGHER POWER OUTPUT
LOWER BOS & LCOE



LESS HOT SPOT SHADING EFFECTS



HALF CUT CELL
TECHNOLOGY

- IEC61215(2016), IEC61730(2016)
- ISO9001:2015: Quality Management System
- ISO45001:2018 Occupational health and safety management systems



IBEX 108MHC-TOPCON 420-440

MONOCRYSTALLINE SOLAR MODULE

ELECTRICAL DATA AT STC

Module Type	420W	425W	430W	435W	440W
	STC	STC	STC	STC	STC
Rated power P _{mpp} [Wp]	420	425	430	435	440
P _{mpp} range to	0/+5W	0/+5W	0/+5W	0/+5W	0/+5W
Rated current I _{mpp} [A]	13.33A	13.41A	13.49A	13.57A	13.65A
Rated voltage V _{mpp} [V]	31.51V	31.70V	31.88V	32.06V	32.24V
Short-circuit current I _{sc} [A]	14.07A	14.15A	14.23A	14.31A	14.39A
Open-circuit voltage U _{oc} [V]	38.11V	38.30V	38.49V	38.68V	38.87V
Efficiency at STC up to	21.51%	21.76%	22.02%	22.28%	22.54%
Application Class	Class A	Class A	Class A	Class A	Class A

*STC: irradiance 1000W/m², AM1.5, and cell temperature of 25°C

ELECTRICAL DATA AT NMOT

Power at P _{mpp} [Wp]	316	320	323	326	329
Rated current I _{mpp} [A]	10.76	10.83	10.91	10.99	11.07
Rated voltage V _{mpp} [V]	29.34	29.50	29.63	29.76	29.89
Short-circuit I _{sc} [A]	11.36	11.42	11.49	11.56	11.63
Open-circuit voltage U _{oc} [V]	36.20	36.38	36.56	36.74	36.92

*NMOT: irradiance 800 W/m² | Wind speed 1 m/sec | Ambient temperature 20°C | AM = 1.5

LIMITING VALUES

Max. system voltage [V]	1500V DC (IEC)
Max. return current [I]	25A
Operating Temperature	- 40 to +85°C
Max. tested pressure load [Pa]2	6200
Max. tested tensile load [Pa]2	4200

TEMPERATURE COEFFICIENT

I _{sc}	V _{oc}	P _{max}
0.046% /°C	-0.25 % /°C	-0.30% /°C

SPECIFICATIONS

Type of cells	N-type Mono
Number of cells	108 (12x9) 182x182mm
Dimensions	1722 x 1134 x 30 mm
Weight	21.5 kg
Front-side glass	3.2 mm coated tempered glass
Frame	Anodized Aluminium Alloy
Junction box	Split Junction Box (IP68)
Cable	4 mm ² , +350mm,-350mm Cust.Length
Diodes	3 Diodes
Plug-in connection	MC4 Compatible
Hail test (max. hailstrom)	Ø45mm 23 m/s 83 km/h

PACKING CONFIGURATION

Container	40 HQ	Pieces Per Pallet	36
Pallets Per container	26	Pieces per Container	936

The specifications and average values can vary slightly. Relevant is the corresponding data of the individual measurement. Specifications are subject to change without notice. Measurement tolerance depending on equipment: rated power +/- 3%, other values +/- 10%. All information given in this data sheet corresponds to DIN EN 50380. A potential light-induced degradation of the power after commissioning is not considered here. Further information in the installation manuals. 1 The specific warranty conditions are given under www.swissenergy-solar.ch | 2 Horizontal mounted | 3 Tolerance L/W = +/- 3 mm. H +/- 2mm, the dimensions given in the order confirmation will be decisive | 4 Location and dimensions of holes on request

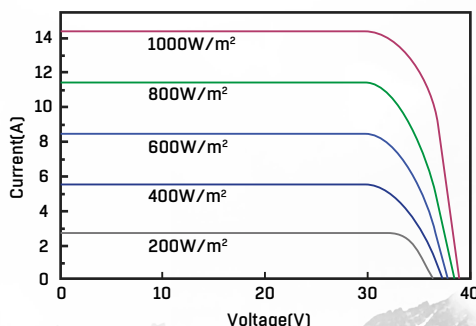
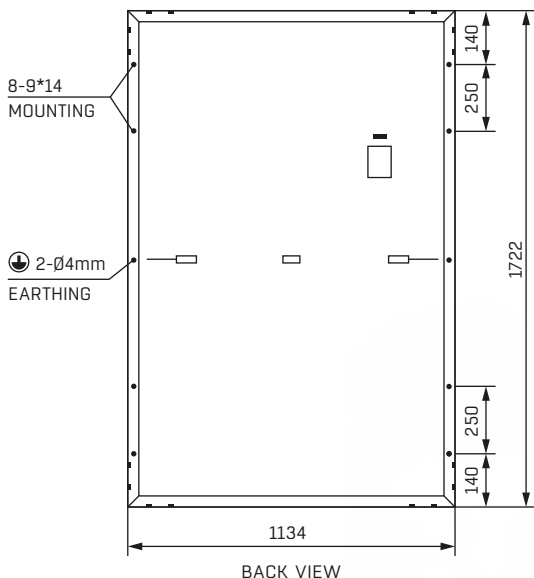

WARRANTY

25 YEARS
PRODUCT WARRANTY

30 YEARS
POWER WARRANTY

swiss solar

SWISSENERGY-SOLAR.CH