

Haitai TaiJi2.0 (182)

HTM620~640MH5-78NT TOPCon Monofacial high efficiency PV module

22.90%

Module Efficiency 22.90%

PRODUCT FEATURES



High Power Output

N-type MBB half cut technology, improve energy density, bring higher power output.



High Durability

Passed TUV Salt & Ammonia corrosion test, and 2400Pa wind load, 5400Pa snow load test, higher reliability



Better Low Light Performance

Higher power generation compare with standard module in cloudy, foggy and low light condition



Low Power Degradation

First year power degradation <1.0%, year 2-30 power degradation <0.40% each year



Low Temperature coefficient

Passivated contact cell technology for higher power generation in operating



Better Anti-LID

N-type cells with boron-oxide-free composite LID to increase module power generation

LINEAR PERFORMANCE WARRANTY

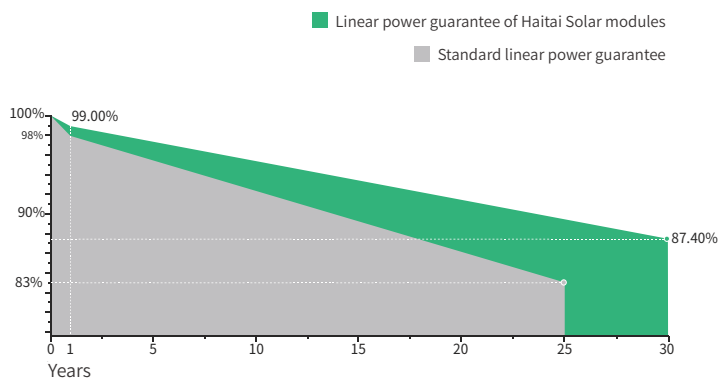

12 YEARS product warranty



30 YEARS linear power warranty



0.40% Linear attenuation of 0.40% per year within 30 years

CERTIFICATES

- IEC 61215, IEC 61730
- ISO 9001: 2015 Quality Management System
- ISO 14001: 2015 Environment Management System
- ISO 45001: 2018 Occupational health and safety management systems



Electrical Data (STC)

Maximum Power (Pmax/W)	620	625	630	635	640
Open Circuit Voltage (Voc/V)	55.46	55.61	55.76	55.91	56.06
Short Circuit Current (Isc/A)	13.98	14.05	14.13	14.2	14.27
Voltage at Maximum Power (Vmp/V)	45.93	46.08	46.23	46.38	46.53
Current at Maximum Power (Imp/A)	13.51	13.57	13.63	13.7	13.76
Module Efficiency (%)	22.18	22.36	22.54	22.72	22.90
Operating Temperature	-40° C~+85° C				
Maximum System Voltage	1000/1500V				
STC (Standard Testing Conditions): Irradiance 1000W/m ² , Cell Temperature 25°C, AM1.5					

Electrical Data (NMOT)

Maximum Power (Pmax/W)	466	470	474	478	482
Open Circuit Voltage (Voc/V)	52.73	52.88	53.03	53.18	53.33
Short Circuit Current (Isc/A)	11.41	11.47	11.54	11.6	11.66
Voltage at Maximum Power (Vmp/V)	43.18	43.33	43.48	43.63	43.78
Current at Maximum Power (Imp/A)	10.8	10.85	10.91	10.96	11.01
NMOT (Nominal Module Operating Temperature): Irradiance 800W/m ² , Ambient Temperature 20°C, AM1.5, Wind Speed 1m/s.					

Mechanical Data

Cell Type	182×91mm Mono
Cell Orientation	156(6×26)
Module Dimensions	2465×1134×30mm
Weight	30.5kg
Glass	3.2mm high transmittance, reinforced glass
Backsheet	Anti-aging film
Frame Material	Anodized aluminum alloy
Junction Box	Protection class IP68
Cable	4.0 mm ² positive pole: 200 mm negative pole: 250 mm wire length can be customized
Connector	MC4 compatible connector

Temperature Coefficients

Temperature Coefficient (Pm)	-0.300%/°C
Temperature Coefficient (Voc)	-0.250%/°C
Temperature Coefficient (Isc)	0.046%/°C
NMOT (Nominal Module Operating Temperature)	41±3°C

Packaging

Transportation methods	Number of modules per cabinet	Number of modules per pallet
40HQ container	576pcs	36pcs +36pcs

Module Dimensions (mm)

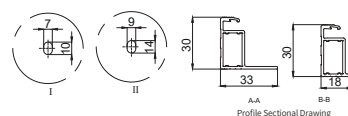
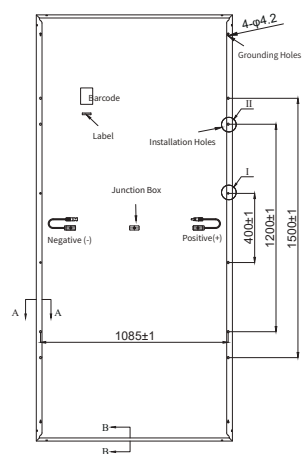
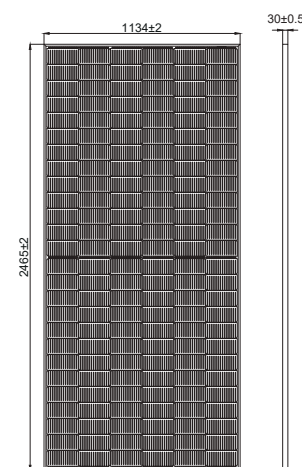

I-V Curve

