

2173×1303×35

Module dimensions (mm)

210×105

Cell size (mm)

120 CELL

Mono N-TOPCon module

600-620Wp

Power output

1500V DC

Max. system voltage

21.89%

Max. efficiency

Quality Guarantee

12-Years Material & technology warranty

30- Years Linear power output warranty

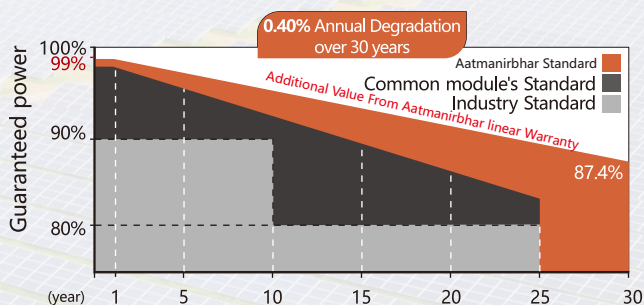

▶ Aatmanirbhar solar Liner power Output Guarantee

▶ Standard Liner Power Output Guarantee

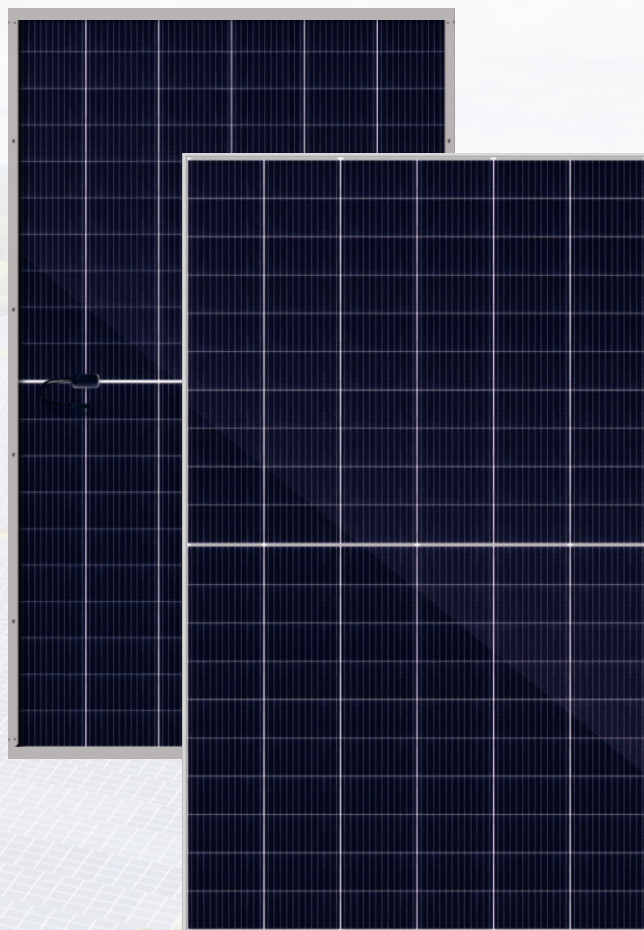

KEY FEATURES



Higher Power Output

Module power increases by 5-25% generally, bringing significantly lower LCOE and higher IRR. 0-5w positive tolerance output warranty.



ZERO LID

N-Type cell is characterized by "0" LID, which generates more power



PID Resistance

Excellent Anti-PID performance guarantee via optimized mass-production process and material control.



Optimal Choice for Ultra-large Power Plants

Contribute to Lower BOS cost and LCOE.



Durability Against Extreme Environmental Conditions

High salt mist and ammonia resistance, Lower temperature coefficient and operating temperature.



More Outstanding Low-light Performance

Higher power output even under low-light environments like on cloudy days



Enhanced Mechanical Load

Certified to withstand: wind load (2400 Pa) and snow load (5400 Pa).



3 EL Full Inspection

Three stage 100% EL Inspection warranting defect-free product.

Reg. Office:

304 - Vraj Valencia, B/H, Mahindra Show Room,
S.G. Hwy, Sola, Ahmedabad, Gujarat 380060

Factory Address :

Survey No: 192, At Dudhathal Village, Taluko-Kapadvanj,
Dist.Kheda, Pin 387 620, Gujarat, India.

Dimensions of PV Module

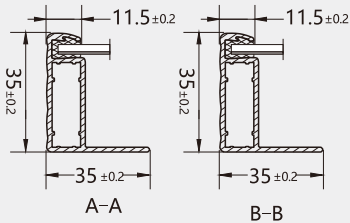
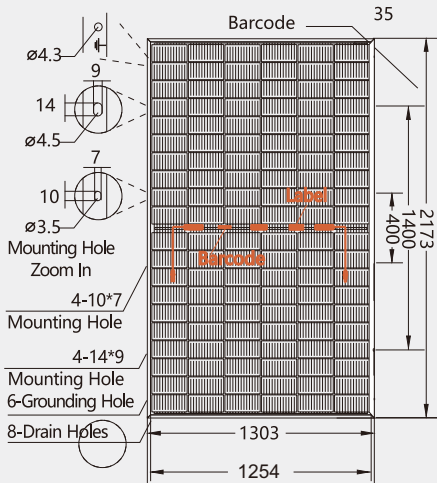

ASPL-620W-210MP/120TB

I-V characteristics at different irradiances

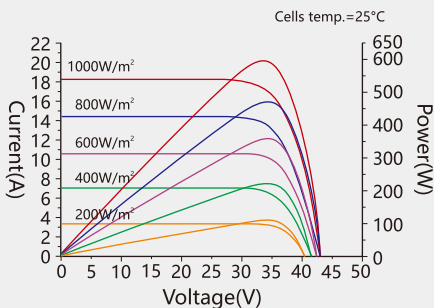

I-V characteristics at different temperatures

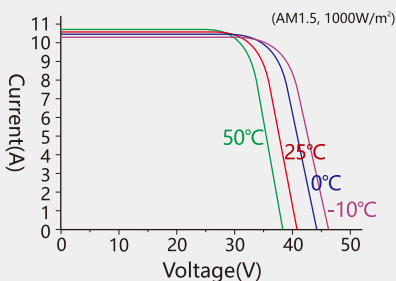

ELECTRICAL CHARACTERISTICS

Model Number	ASPL-600W-210M/120TB	ASPL-605W-210M/120TB	ASPL-610W-210M/120TB	ASPL-615W-210M/120TB	ASPL-620W-210M/120TB
Rated Power in Watts-Pmax(Wp)	600	605	610	615	620
Open Circuit Voltage-Voc(V)	42.42	42.62	42.83	43.05	43.27
Short Circuit Current-Isc(A)	18.01	18.05	18.08	18.12	18.16
Max. Power Voltage-Vmpp(V)	35.3	35.51	35.74	35.97	36.18
Max. Power Current-Impp(A)	17.00	17.04	17.07	17.10	17.14
Module Efficiency(%)	21.19	21.36	21.54	21.72	21.89
Maximum system voltage(V)	1500				
Fuse Rating(A)	30				
Temperature coefficient Pmax(%/°C)	-0.30				
Temperature coefficient Isc(%/°C)	0.04				
Temperature coefficient Voc(%/°C)	-0.25				

STC: Irradiance 1000W/m², module temperature 25°C, AM=1.5

Bifacial Output-Backside Power Gain

	Pmax(W)	660	665	671	676	682
10%	Module efficiency(%)	23.31	23.49	23.70	23.88	24.09
20%	Pmax(W)	720	726	732	738	744
	Module efficiency(%)	25.43	25.64	25.85	26.07	26.28

WORKING CHARACTERISTICS

Power level	600	605	610	615	620
Pmax(W)	457	460	464	468	472
Vmp(V)	33.14	33.34	33.56	33.77	33.97
Imp(A)	13.79	13.80	13.83	13.86	13.89
Voc(V)	40.15	40.34	40.54	40.75	40.95
Isc(A)	14.52	14.55	14.57	14.60	14.64
Power tolerance(%)	0~+3				
NOCT(°C)	44±2				

NOCT: Irradiance 800W/m², ambient temperature 20°C, wind speed 1m/s

MECHANICAL CHARACTERISTICS

Number of cells	120pcs	Type of frame	Anodized Aluminum Alloy
Size of cell(mm)	210×105	Size of module(mm)	2173×1303×35
Type of cell	N-TOPCon Mono	Weight(kg)	37.2
Thickness of glass(mm)	2.0	Cables/connectors	4.0mm ² , MC4 compatible
Junction box	IP68	Length of Cable	+300mm/-300mm(connector included)

MAXIMUM RATINGS

Operating Temperature(°C)	-40~85
Operating humidity(°C)	5~85
Allowable Hail Load	25mm ice-ball with velocity of 23m/s

PACKAGING CONFIGURATION

	40ft (HQ)
Number of Modules Per Container	300
Number of Modules Per Pallet	30
Number of Pallets Per Container	10
Packaging Box Dimensions (l×w×h) (mm)	2200×1120×1445
Box Gross Weight (kg)	965

CAUTION: READ SAFETY AND INSTALLATION INSTRUCTIONS BEFORE USING THE PRODUCT

