

FLEXIBLE SOLAR PANEL YH135W-14M

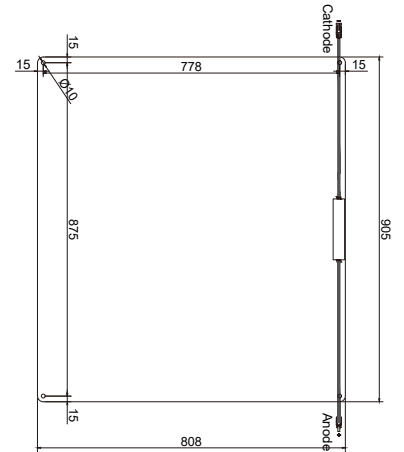
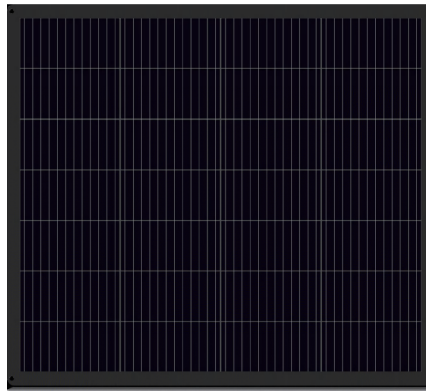

ELECTRICAL DATA

Model Type	YH135W-14M
Peak Power(Pmax)	135
Maximum Power Voltage(Vmp)	15.59V
Maximum Power Current(Imp)	8.66A
Open Circuit Voltage(Voc)	18.40V
Short Circuit Current(Isc)	9.15A
Module Efficiency(%)	18.46

* STC: irradiance 1000 W/m², AM 1.5G, and cell temperature of 25°C

THERMAL CHARACTERISTICS & OPERATING CONDITIONS

Maximum System Voltage(V)	1000
Maximum Series Fuse Rating(A)	10
Power Tolerance	0~+3%
Pmax Temperature Coefficients(W/°C)	-0.400%
Voc Temperature Coefficients(V/°C)	-0.330%
Isc Temperature Coefficients(A/°C)	+0.048%
NOCT Nominal Operating Cell Temperature(°C)	45±2
Operating and Storage Temperature(°C)	-40~+85

MECHANICAL CHARACTERISTICS

Cell Type	210*105Mono
No. of Cells	28(4*7)
Dimensions	900*805*3mm
Weight	2.67kg
Junction box	IP65/IP67
Output cables	2.5mm ² cable90cm + mc4
MaxWind Load/Snow Load	2400Pa/5400Pa