

LF285P6-60

- LF265P6-60
- LF270P6-60
- LF275P6-60
- LF280P6-60

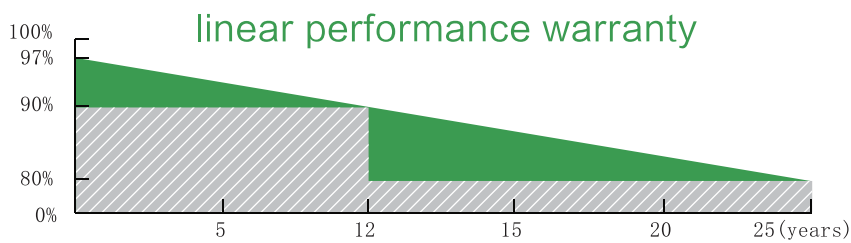

Ningbo Lefeng New Energy Co.,Ltd

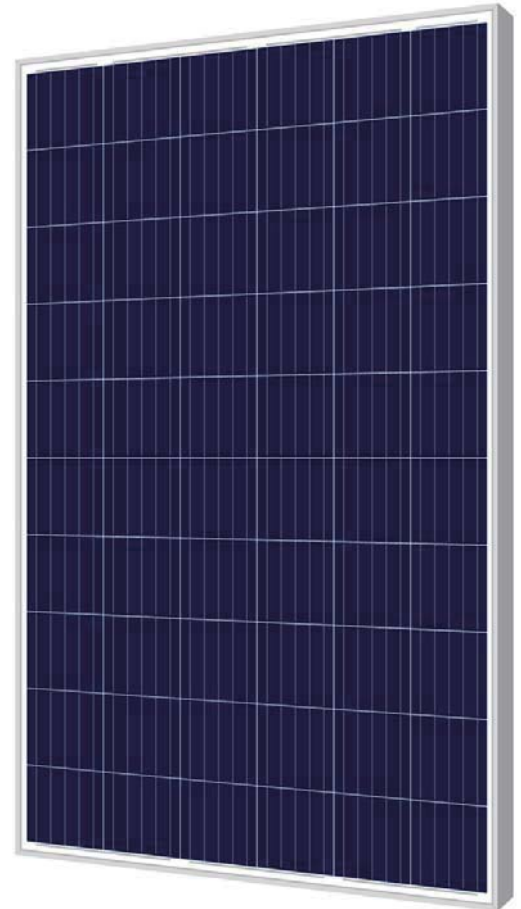
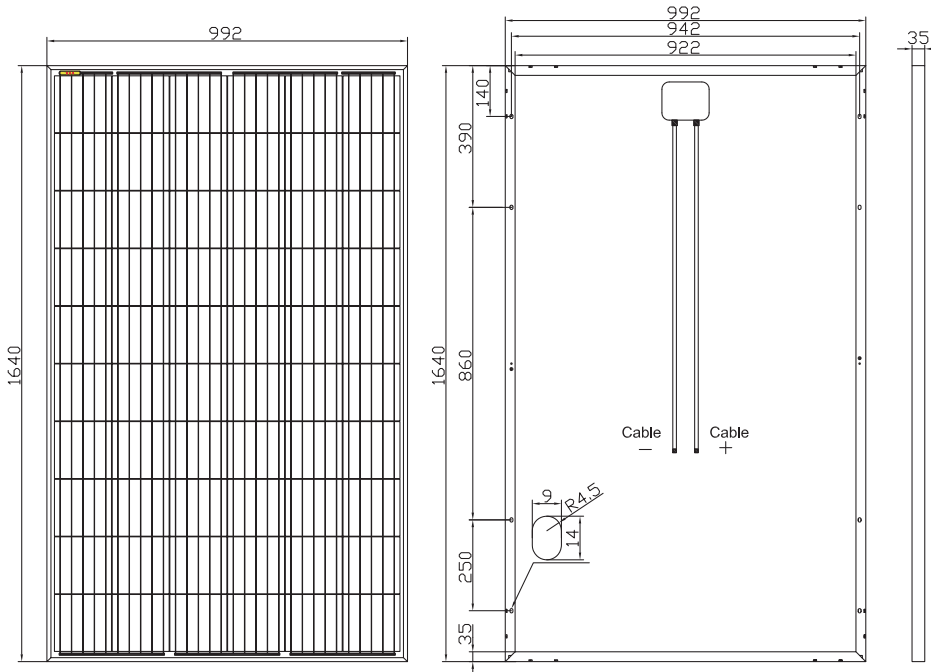

12 Years
Material&Craft
Quality
assurance

25 Years
80% output
Power
guarantee



ISO9001
ISO14001
OHSAS18001



High Module Efficiency



Mechanical Load
Capability up to 5400 Pa



Salt Mist Corrosion Protect
Ammonia Resistance



Potential Induced
Degradation Free

Ningbo Lefeng New Energy Co.,Ltd

Tel: +86-0574-25709777

Tel: +86-0574-25758826

E-mail: Sales@lefnosolar.com

Add: No. 55 Haihe Road, Binhai Industrial Park, Xiangshan County, Ningbo, 315700, China



LF285P6-60

- LF265P6-60
- LF270P6-60
- LF275P6-60
- LF280P6-60



Ningbo Lefeng New Energy Co.,Ltd

Electrical Characteristics

TYPE	LF 265P6-60	LF 270P6-60	LF 275P6-60	LF 280P6-60	LF 285P6-60
POWER OUTPUT	265	270	275	280	285
MAXPOWER TOLERANCE	0-5W	0-5W	0-5W	0-5W	0-5W
MODULE EFFICIENCY (%)	16.29	16.60	16.90	17.21	17.52
VOLTAGE MPP Vmpp	31.48	31.61	31.74	31.82	31.88
CURRENT MPP Impp (A)	8.42	8.54	8.66	8.80	8.94
VOLTAGE OPEN CIRCUIT Voc	37.38	37.54	37.70	37.86	37.92
SHORT CIRCUIT CURRENT Isc (A)	8.98	9.14	9.27	9.42	9.56
TEMPERATURE COEFFICIENTS Isc (% / °C)			0.050		
TEMPERATURE COEFFICIENTS Voc (% / °C)			-0.320		
TEMPERATURE COEFFICIENTS Pmpp (% / °C)			-0.410		
NOCT (°C)			45±2°C		

Mechanical Data

DIMENSIONS OF MODULE	1640*992*35mm
WEIGHT(Kg)	18.0
CABLE	4mm ²
GLASS	High transmission glass 3.2mm
JUNCTION BOX	IP67, 3 Bypass-Diode, 900mm in length
TYPE OF CONNECTOR	Compatible with MC 4 plug

Working Conditions

MAX SYSTEM VOLTAGE (VDC)	1000V
SERIES FUSE RATING	15A
MECHANICAL LOAD	5400Pa
OPERATING TEMPERATURE (°C)	-40~+85
APPLICATION CLASS	A

Packaging Configuration

Loading Capacity	372 pcs/20GP
	868 pcs/40HC

Contact Information

I-V CURVES

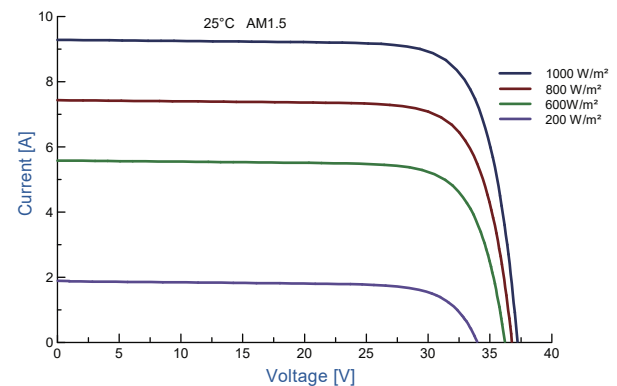

Ningbo Lefeng New Energy Co.,Ltd

Tel: +86-0574-25709777

Tel: +86-0574-25758826

E-mail: Sales@lefnosolar.com

Add: No. 55 Haihe Road, Binhai Industrial Park, Xiangshan County, Ningbo, 315700, China

