

AXE^{CP}

Car Port - Economical

Durable

Hot-dip galvanised steel for the toughest environmental conditions. Optional aluminium rails.

Economical

Cost competitive, functional design with minimal number of tools needed, reducing installation costs.

Trust

Conservative coefficient selections in structural design to assure resistance to failure.

Simplified

Easy installation method with a practical integrated solution for any environment.

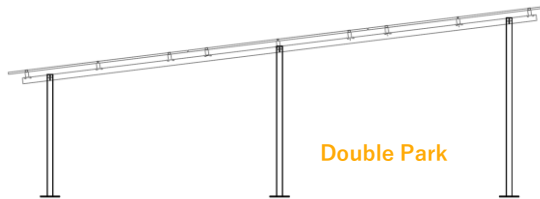

Additions	Cable trays along rails and cable clips to panel frames End caps for rails Diagonal support to upright posts to reduce foundation moments										
Sway prevention	Cross brace in selected bays Available in either cables or angles										
Module layout		<table border="0"> <tr> <td></td> <td>Single:</td> <td>Double:</td> </tr> <tr> <td>Landscape / Horizontal:</td> <td>Up to 6 high</td> <td>Up to 12 high</td> </tr> <tr> <td>Portrait / Vertical:</td> <td>Up to 3 high</td> <td>Up to 6 high</td> </tr> </table>		Single:	Double:	Landscape / Horizontal:	Up to 6 high	Up to 12 high	Portrait / Vertical:	Up to 3 high	Up to 6 high
	Single:	Double:									
Landscape / Horizontal:	Up to 6 high	Up to 12 high									
Portrait / Vertical:	Up to 3 high	Up to 6 high									
Module inclination	5° to 10° angle										
Width and height	Thermal gap within 35 meters increments of table length Lowest panel at maximum 3.2 meters Per post height customisable to accommodate terrain variations										
Support spacing	2 park bays (up to 5.4 meters) End overhang of up to 2.1 meters										
Foundation	Footplates connected to casted threaded rods Posts casted into reinforced concrete Ground screws connected to footplates										
Standards	Eurocode 1 / SANS 10160 Eurocode 3 / SANS 10162 ISO 1461 Eurocode 9 Eurocode 7 / SANS 10400	Structural design Structural use of steel Hot dip galvanized coatings Design of aluminium structure Foundation design									
Materials	Support rails (Selection) Rafters and Upright posts Small parts	Extruded aluminium (6063 T6) or Hot-dip galvanised lipped channels (S355) Hot-dip galvanised lipped channels (S355) Hot-dip galvanised steel (8.8) Stainless steel (A2) Extruded aluminium (6063 T6)									
Certification	ISO 9001										
Warranty	10 years ¹										

Clamp connection

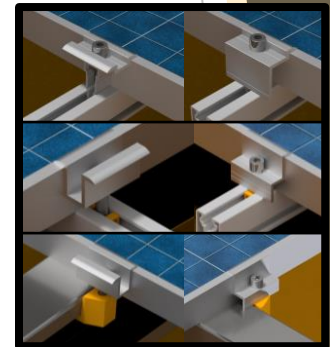

Rail connections to Rafter

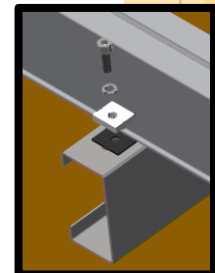

Post connections to Rafter

