

## 535-550 Watt MONO-FACIAL MODULE

- ◆ IEC 61215: 2021
- ◆ IEC 61730: 2016
- ◆ TÜV Rheinland Standard
- ◆ CE: European Certification
- ◆ Resistance to salt mist and ammonia corrosion
- ◆ Performance tests under extreme conditions
- ◆ Wind and snow load testing

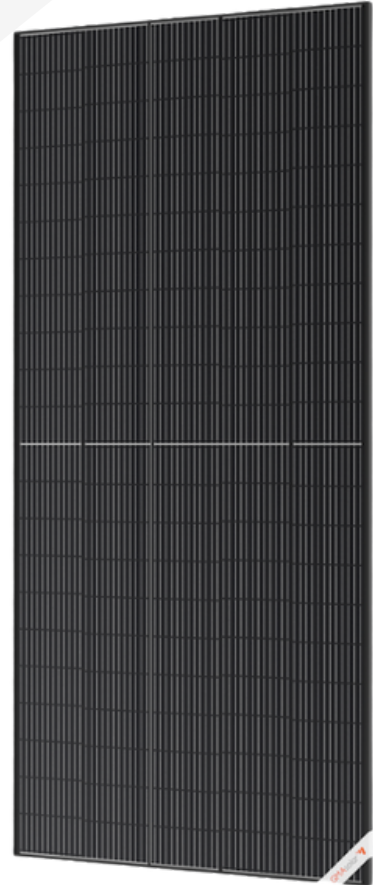

### ◆ Key Features



#### Higher Energy Efficiency

Mono-Facial technology harnesses reflected light.



#### High Climate Resilience

Wind load resistance of 2400Pa and snow load resistance of 5400Pa.



#### Improved Performance in Low Light

Optimal operation in low irradiation conditions.



#### Longer Lifespan

25-year warranty with over 85% power output.



#### PID Protection

Minimized power loss due to degradation effects.



#### Easy Installation & Compatibility

Lightweight design for easier handling and installation.

## 535-550 Watt MONO-FACIAL MODULE

### > Electrical Parameters at STC

Maximum Power (Pmax)	535 Wp	540 Wp	545 Wp	550 Wp
Voltage at Maximum Power (Vmpp)	31.36 V	31.56 V	31.76 V	31.96 V
Current at Maximum Power (Impp)	17.06 A	17.11 A	17.16 A	17.21 A
Open Circuit Voltage (Voc)	37.66 V	37.86 V	38.06 V	38.26 V
Short Circuit Current (Isc)	18.07 A	18.12 A	18.17 A	18.22 A
Module Efficiency	20.48 %	20.67 %	20.86 %	21.05 %

Values at standard test conditions STC (Air mass AM 1.5, Irradiance 1000W/sqm, Cell temperature 25°C)  
Power Measurement Tolerance: 0 / +3%

### > Specifications

Weight	29.5 kg
Dimension	2384mm*1096mm*35mm
Cell Dimension	210*105mm
Cell Amount	55*2 pcs
Junction Box	IP68
Frame	Aluminum Alloy
Cable	4mm <sup>2</sup> , +300, -300mm/±1300mm Length can be customized
Connector	MC4 compatible
Application Level	Class A

### > Maximum Ratings

Operating Temperature	-40°C~+85°C
Maximum System Voltage	1500 V
Wind Load/ Snow Load	2400pa/5400pa
Fuse Current	30 A

### > Warranty & certifications

Warranty	25 years Power Output Warranty 10 years 90%, 25 years 85% 10 years Product Warranty on Material
Certification	IEC 61215:2021 IEC 61730:2016

### > Mechanical Drawing

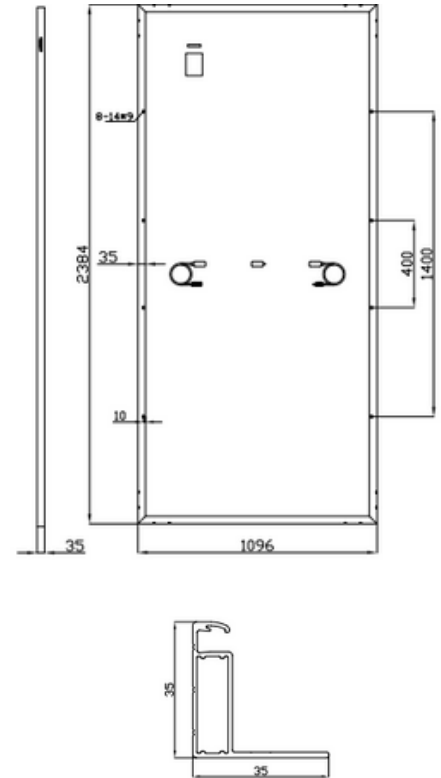

### > IV Characteristics

