

166-9BB 单晶 PERC+SE 双面电池

166KBMP-9BBF

产品外观

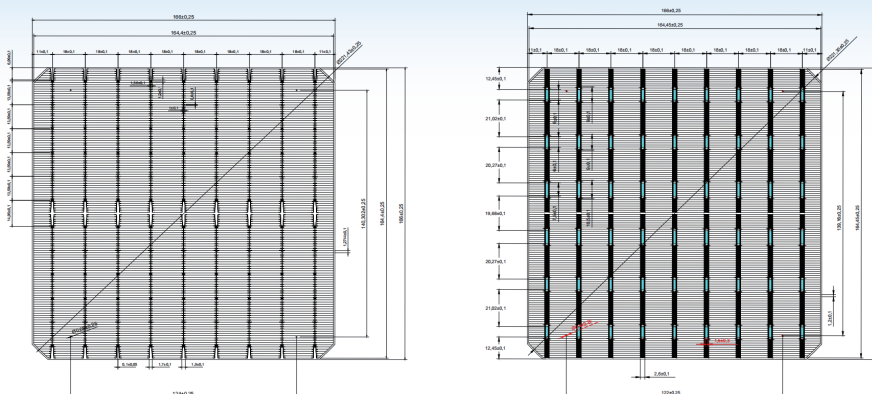

技术参数

产品规格		温度系数	
尺寸	166mm*166mm±0.25mm, 对径223mm±0.25mm	TkVoltage	-0.36 %/K
厚度	175μm±17.5μm	TkCurrent	+0.04 %/K
正面 (-)	0.1±0.05mm 主栅线 (银) 130根副栅线, 蓝色减反射膜 (氮化硅)	TkPower	-0.38 %/K
背面 (+)	背电极宽度1.5±0.3mm (银), 138根副栅线, 背面覆盖铝栅线		

光强响应

Intensity [W/m ²]	Uoc	Isc
1000	1.00	1.00
800	0.99	0.80
600	0.98	0.60
400	0.96	0.40
200	0.93	0.20

IV 曲线

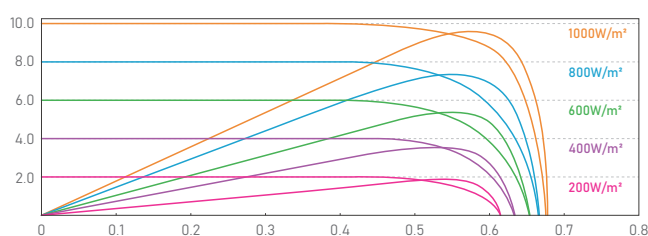

电性能参数

Eta [%]	Pmpp [W]	Umpp [V]	Impp [A]	Voc [V]	Isc [A]	FF [%]
22.9	6.28	0.586	10.713	0.686	11.204	81.68
22.8	6.25	0.585	10.685	0.685	11.184	81.59
22.7	6.22	0.584	10.656	0.684	11.164	81.50
22.6	6.20	0.583	10.627	0.683	11.143	81.41
22.5	6.17	0.582	10.599	0.682	11.122	81.32
22.4	6.14	0.581	10.570	0.681	11.101	81.23
22.3	6.11	0.580	10.541	0.680	11.080	81.14
22.2	6.09	0.579	10.511	0.679	11.062	81.03
22.1	6.06	0.578	10.482	0.678	11.043	80.92

■ 标准测试条件: 1000W/m², AM1.5, 25°C

以上技术参数动态变更的解释权归鑫非公司所有

X.F SOLAR

166-9BB Monocrystalline Bifacial Solar Cell PERC+SE

166KBMP-9BBF

Pattern Design

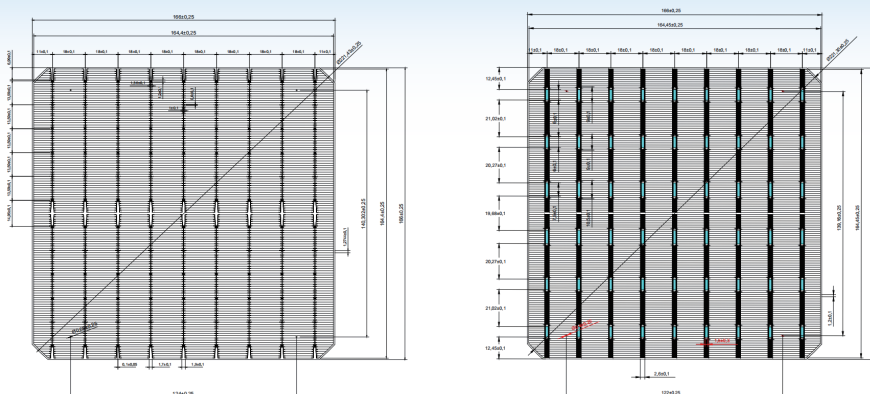

Technical Parameter »

Product specification		Temperature Coefficient	
Dimension	166mm*166mm±0.25mm, Diameter 223mm±0.25mm	TkVoltage	-0.36 %/K
Thickness	175µm±17.5µm	TkCurrent	+0.04 %/K
Front [-]	0.1±0.05mm bus bars(silver) 130 finger grids, Blue anti-reflecting coating(silicon nitride)	TkPower	-0.38 %/K
Rear [+]	width of back electrode 1.5±0.3mm (Silver), 138 finger grids, finger grids(Al)		

Light intensity response »

Intensity [W/m ²]	Uoc	Isc
1000	1.00	1.00
800	0.99	0.80
600	0.98	0.60
400	0.96	0.40
200	0.93	0.20

IV Curves

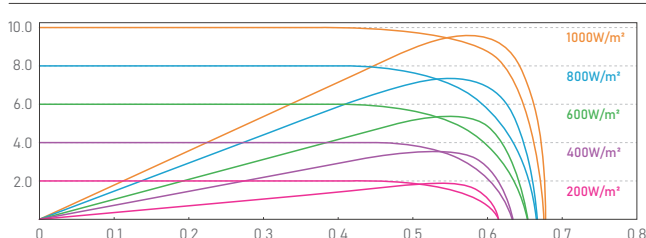

Electrical performance parameter »

Eta [%]	Pmpp [W]	Umpp [V]	Impp [A]	Voc [V]	Isc [A]	FF [%]
22.9	6.28	0.586	10.713	0.686	11.204	81.68
22.8	6.25	0.585	10.685	0.685	11.184	81.59
22.7	6.22	0.584	10.656	0.684	11.164	81.50
22.6	6.20	0.583	10.627	0.683	11.143	81.41
22.5	6.17	0.582	10.599	0.682	11.122	81.32
22.4	6.14	0.581	10.570	0.681	11.101	81.23
22.3	6.11	0.580	10.541	0.680	11.080	81.14
22.2	6.09	0.579	10.511	0.679	11.062	81.03
22.1	6.06	0.578	10.482	0.678	11.043	80.92

■ STC (Standard Testing Conditions): 1000W/m², AM1.5, 25°C

XF company reserves the right to interpret the dynamic changes of the above technical parameters

X.F SOLAR