

Household Energy Storage Product

To Be The World's Leading Clean Energy Service Provider

Household Energy Storage Application Scenarios

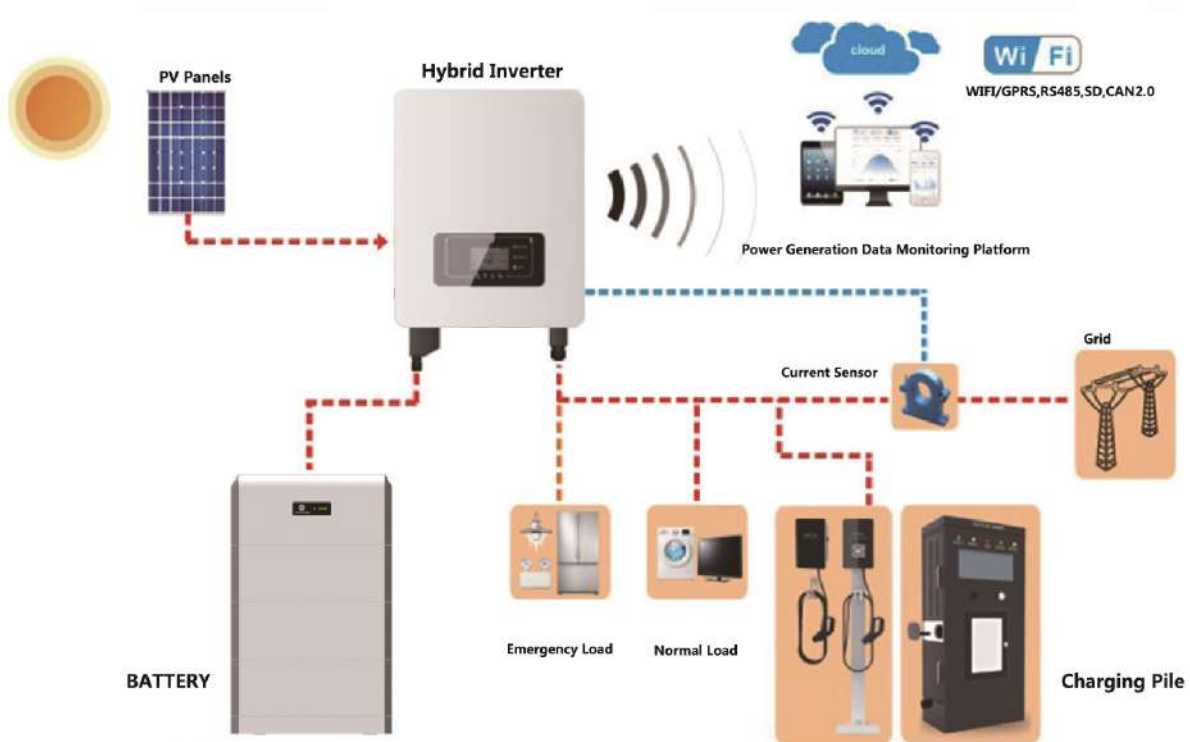

Features:

- Improve power self-generation to save users' electricity bills;
- Reduce electricity load due to peak load cutting.



Features:

- Solve the problem of new energy consumption and ease the pressure on grid regulation;
- Emergency power supply in case of power failure.



Household Energy Storage Products Features



Flexible Investment

Modular design
Flexible configuration



Easy Installation

Stacked installation, single-person operable
Save installation time and cost



Safe and Reliable

Global first-tier brand LFP cell



Perfectly Compatible

Compatible with mainstream brand inverters

Introduction of Household Energy Storage Products

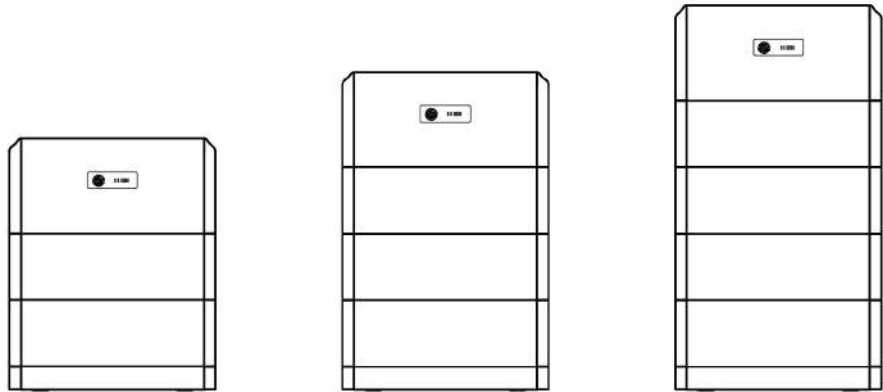

| Items | Parameter | | |
|-----------------------|----------------------|----------------------|-----------------------|
| Model | HES5.32-A01 | HES7.98-A01 | HES10.649-A01 |
| Rated Power | 5.32kWh | 7.98kWh | 10.649kWh |
| Available Electricity | 4.79kWh | 7.19kWh | 9.58kWh |
| Battery Modules | 2(1P32S) | 3(1P48S) | 4(1P64S) |
| Communication | RS485/CAN | | |
| Dimension (W x H x T) | 620 x 755 x 150 (mm) | 620 x 955 x 150 (mm) | 620 x 1155 x 150 (mm) |
| Weight | 80kg | 105kg | 130kg |
| Module Dimension | 620 x 200 x 150 (mm) | | |
| Module Weight | 25kg | | |
| Installation | Indoor/Outdoor | | |
| Working Temperature | -20℃ ~ + 50℃ | | |
| Max. Working Altitude | 2000 m | | |

Introduction of Household Energy Storage Products

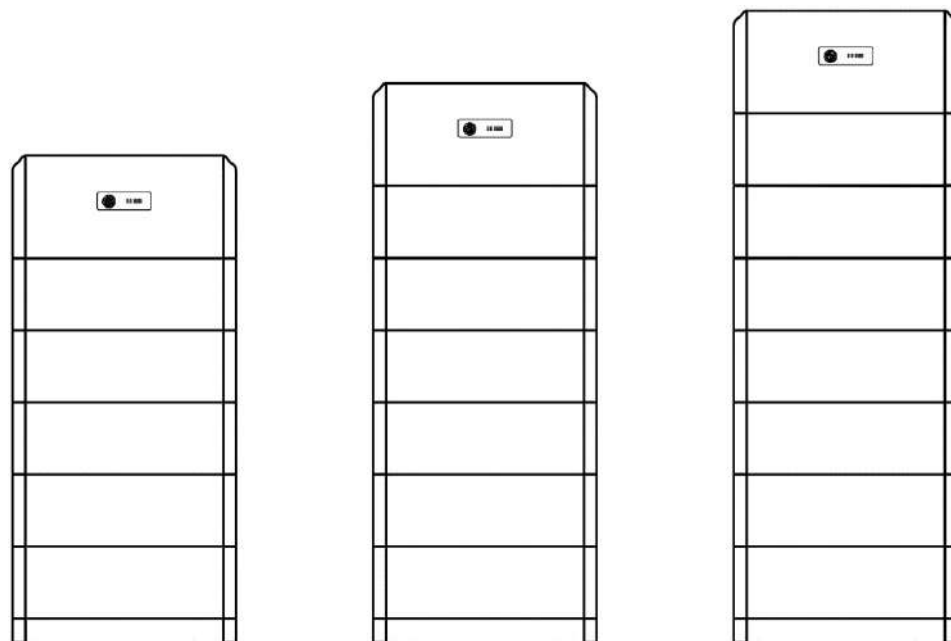

| Items | Parameter | | |
|-----------------------|-----------------------|-----------------------|-----------------------|
| Model | HES13.312-A01 | HES15.97-A01 | HES18.63-A01 |
| Rated Power | 13.312kWh | 15.97kWh | 18.63kWh |
| Available Electricity | 11.98kWh | 14.37kWh | 16.77kWh |
| Battery Modules | 5(1P80S) | 6(1P96S) | 7(1P112S) |
| Communication | RS485/CAN | | |
| Dimension (W x H x T) | 620 x 1355 x 150 (mm) | 620 x 1555 x 150 (mm) | 620 x 1755 x 150 (mm) |
| Weight | 155kg | 180kg | 205kg |
| Module Dimension | 620 x 200 x 150 (mm) | | |
| Module Weight | 25kg | | |
| Installation | Indoor/Outdoor | | |
| Working Temperature | -20℃ ~ + 50℃ | | |
| Max. Working Altitude | 2000 m | | |



To Be The World's Leading Clean Energy Service Provider

Address: No. 125, Keji 2nd Road, East Lake
New Technology Development Zone, Wuhan
Website: <http://www.chinacamel.com/>
Postcode: 430000
Tel: 400-189-9507