

# RS6S-M

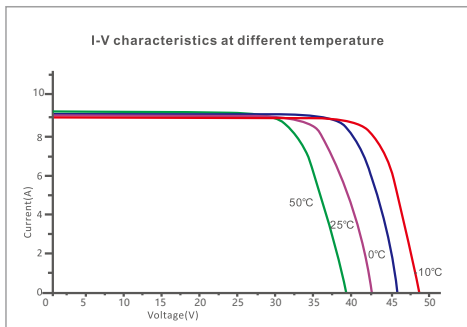

GLOBAL PROFESSIONAL PV PRODUCTS INTERGRATED SOLUTIONS SUPPLIER

Dimension of PV Modules Unit: mm

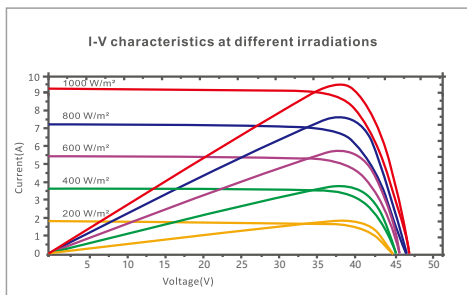
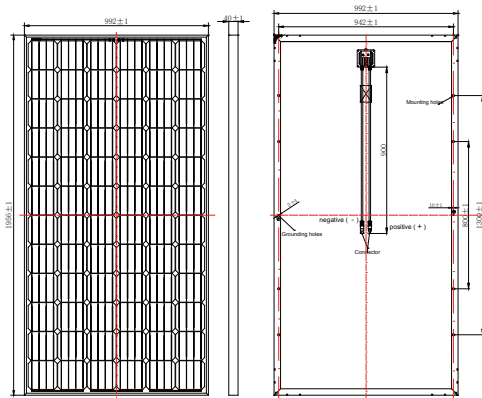

## ELECTRICAL DATA(STC)

| Rated Power in Watts-Pmax(Wp) | 345W   | 350W   | 355W   | 360W   | 365W   | 370W   |
|-------------------------------|--------|--------|--------|--------|--------|--------|
| Open Circuit Voltage-Voc(V)   | 46.25V | 46.41V | 46.85V | 47.12V | 48.2V  | 48.5V  |
| Short Circuit Current-Isc(A)  | 9.58A  | 9.67A  | 9.72A  | 9.78A  | 9.84A  | 9.93A  |
| Maximum Power Voltage-Vmp(V)  | 38.3V  | 38.64V | 38.98V | 39.31V | 39.7V  | 39.9V  |
| Maximum Power Current-Imp(A)  | 9.01A  | 9.06A  | 9.11A  | 9.16A  | 9.20A  | 9.28A  |
| Module Efficiency (%)         | 17.78% | 18.04% | 18.30% | 18.55% | 18.81% | 19.07% |

STC: Irradiance 1000 W/m<sup>2</sup>, Cell Temperature 25°C, Air Mass AM1.5 according to EN 60904-3.

## ELECTRICAL DATA(NOCT)

| Maximum Power-Pmax (Wp)       | 275W   | 279W   | 283W   | 286W   | 288W   | 290W   |
|-------------------------------|--------|--------|--------|--------|--------|--------|
| Open Circuit Voltage-Voc (V)  | 46.62V | 46.79V | 46.92V | 47.15V | 47.66V | 47.79V |
| Short Circuit Current-Isc (A) | 7.55A  | 7.60A  | 7.73A  | 7.77A  | 7.80A  | 7.84A  |
| Maximum Power Voltage-Vmp(V)  | 38.21V | 38.35V | 38.46V | 38.65V | 38.75V | 38.85V |
| Maximum Power Current-Imp(A)  | 7.20A  | 7.28A  | 7.36A  | 7.40A  | 7.43A  | 7.46A  |

NOCT: Irradiance at 800 W/m<sup>2</sup>, Ambient Temperature 20°C, Wind Speed 1 m/s.

## MECHANICAL DATA

|                    |  |
|--------------------|--|
| Solar cells        | Mono-crystalline 156 x 156mm, 5 Bus bars |
| Cell configuration | 72 cells(6x12)                           |
| Module dimensions  | 1956 x 992 x40mm(77.0 x 39.1 x 1.57in)   |
| Weight             | 22KGS                                    |
| Front Cover        | 3.2mm Tempered Glass                     |
| Frame Material     | Anodized Aluminum Alloy                  |
| J-BOX              | IP67                                     |
| Cable              | 4mm <sup>2</sup> (IEC)/12AWG(UL),900mm   |
| Connectors         | MC4 or MC4 Comparable                    |
| Standard Packaging | 26pcs/pallet                             |

## TEMPERATURE & MAXIMUM RATINGS

|   |                     |
|---|---------------------|
| Nominal Operating Cell Temperature (NOCT) | 45°C±2°C            |
| Temperature Coefficient of Voc            | -0.32%/°C           |
| Temperature Coefficient of Isc            | 0.05%/°C            |
| Temperature Coefficient of Pmax           | -0.39%/°C           |
| Operational Temperature                   | -40~+85°C           |
| Maximum System Voltage                    | 1000V(IEC)/600V(UL) |
| Max Series Fuse Rating                    | 15A                 |
| Limiting Reverse Current                  | 15A                 |

## PACKAGING CONFIGURATION

|                                 | 40HQ   | 20GP                    |
|---------------------------------|--|-------------------------|
| Number of modules per container | 696pcs   | 260pcs                  |
| Package                         | 26pcs/pallet,2pcs/carton box                         | 26pcs/pallet            |
| Package Number                  | 24pallets + 36carton boxes                           | 10pallets               |
| Package Weight                  | 600kg/pallet,46kg/carton box                         | 600kg/pallet            |
| Package Dimension               | 1980*1120*1130mm/pallet<br>1980*1020*90mm/carton box | 1980*1120*1130mm/pallet |

## Partner information

A: No 15 Puzhuang Avenue, Wuzhong District,  
Suzhou, Jiangsu Chian, 21500  
F: +86512-66292101 T: +86 512-66293858  
W: www.resunsolar.com E: info@resunsolar.com



WWW.RESUNSOLAR.COM



RS6S-M is a robust solar module with 72 solar cells. These modules can be used for on-grid solar applications. Our meticulous design and production techniques ensure a high-yield, long-term performance for every module produced. Our rigorous quality control and in-house testing facilities guarantee Resun Solar's modules meet the highest quality standards possible. RS6S-M have five instead of three bus bars, which allows more efficient current collection and can also improve long term performance. The RS6S-M cells use a novel junction formation technology which is standard in semiconductor manufacturing. This allows for improved minority carrier lifetimes and a very tight distribution of cell performance in manufacturing. RS6S-M cells are PID free and further increase the cell efficiency allowing to increase the average module power distribution.

## RS6S-M

**72 Cells**

Mono-crystalline

**345-370W**

Power output

**19.07%**

The Highest Efficiency

**0~+5W**

Tolerance

**0.5% Annual Degradation  
over 30 years**

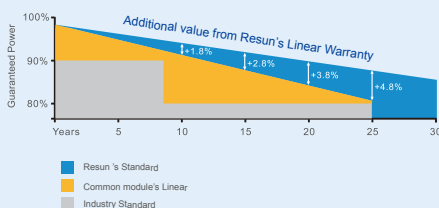

**LINEAR PERFORMANCE WARRANTY**  
12 year Product Warranty / 30 year Linear Power Warranty



**High module conversion efficiency (up to 19.07%), through superior manufacturing technology**



**Guaranteed 0~+5W positive power output tolerance ensures high reliability**



**Anti-reflective, hydrophobic coating improves light absorption and reduces surface dust**



**Excellent performance under low light environments (mornings, evenings and cloudy days)**



**Suitable for harsh environments, such as coasts, deserts and lakes. Withstand high level of wind loads (2400pa) and snow loads (5400pa)**

**Full range of products and certification systems**

ISO 9001 TUV PID-FREE CE IEC61215/61730/61701/62716

