

## 685W/690W/695W/700W

Cortex™ series of solar modules by Omnis Power are very powerful which provide the world-class performance. The Cells and raw materials structure design ensures the maximized of sunlight and enhances the reliability. Cortex™ includes the most leading technologies of solar cells like PERC, N-Topcon, HJT, and shingled. After years of effort, Cortex is able to increase customer's value beyond the efficiency, the performance and durability under real conditions makes our customers succeed no matter in residential or commercial applications.

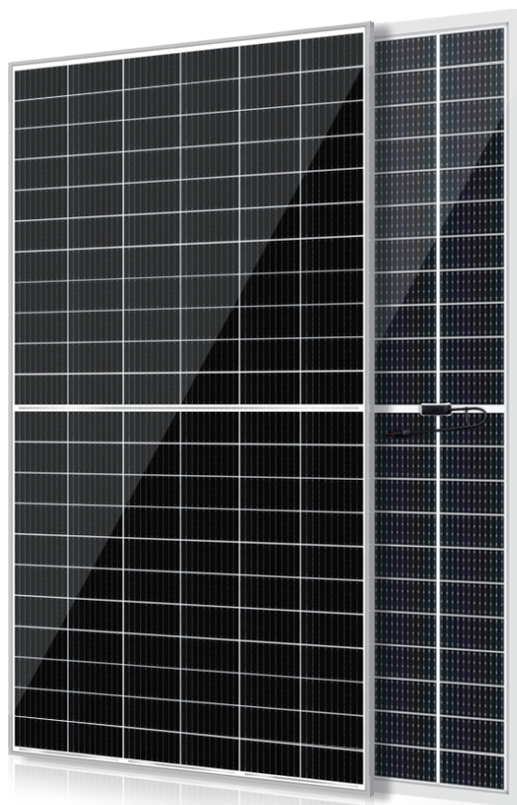

## Highlight



### Higher Efficiency With HJT Technology

The leading high efficiency of solar cells ensures the high output power which making it more sufficient in limited space.



### Lower Power Degradation

Ensured PID resistance through cell process and module material control to help harvest more. Cortex HJT is guaranteed ONLY 0.375% annual power degradation in 30 years.



### Warranty Extended Up To 30 Years

Cortex provide 30 years warranty of product materials and workmanship which is leading the whole industry.



### Durability In Extreme Conditions

Cortex is passed the test by salt mist, ammonia and mechanical loads up to 5400pa positive.

## About Omnis Power

In the year of 2010, Omnis power was created by a group of passionate people in U.S who are dedicating into renewable energies. Since more than 10 Years, Omnis Power has grown to become one of the most innovative and dependable solar product and solution provider. Omnis Power offers sustainability and brings the future to both commercial and residential applications worldwide with top-of-the-line solar products, solutions, and services. Being an qualified PV company means operating in a way that reflects our values and mission to provide our partners with the innovation and quality they deserve. Omnis Power is committed to upholding the standards and responsibility that made us one of the best.

### Electrical Data (STC)

Part Number	OP685M66-NH4	OP690M66-NH4	OP695M66-NH4	OP700M66-NH4
Peak Power Watts- $P_{MAX}(Wp)^*$	685	690	695	700
Power Output Tolerance	0~5W			
Open Circuit Voltage- $V_{oc}(V)$	49.66	49.82	49.98	50.13
Short Circuit Current- $I_{sc}(A)$	17.25	17.31	17.37	17.43
Maximum Power Voltage- $V_{MPP}(V)$	41.65	41.80	41.95	42.10
Maximum Power Current- $I_{MPP}(A)$	16.45	16.51	16.57	16.63
Panel Efficiency(%)	22.10	22.20	22.40	22.50

STC :Irradiance 1000w/m<sup>2</sup>,Cell Temperature 25°C,Measure Tolerance :+/- 3%

### Electrical Data (NOCT)

MaximumPower- $P_{MAX}(Wp)^*$	756	761	767	772
Open Circuit Voltage- $V_{oc}(V)$	49.66	49.82	49.98	50.13
Short Circuit Current- $I_{sc}(A)$	19.04	19.09	19.17	19.22
Maximum Power Voltage- $V_{MPP}(V)$	41.65	41.80	41.95	42.10
Maximum Power Current- $I_{MPP}(A)$	18.16	18.21	18.29	18.35

NOCT:Irradiance at 800W/m<sup>2</sup>,Ambient Temperature 20°C,Wind Speed 1m/s

### Mechanical Data

Panel Dimension(H/W/O)	2384 x 1303 x 35 mm
Weight	38.7kg
Cell Type	HJT Mono
Cell Size	210 x 105 mm
Cell Connection	132 ( 66 x 2 )
Glass Thickness	(F)2.0mm Anti-reflective surface Solar glass (B)2.0mm Solar glass
Encapsulant Type	POE
Frame Type	Anodized Aluminium Alloy
Junction Box Protection Class	IP 67 / IP68
Connector Type	MC4 Compatible
Output Cable	4mm <sup>2</sup> ,200mm in length,length can be customized /UV Resistant

### DIMENSIONS OF PV MODULE(mm)

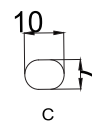
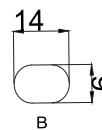
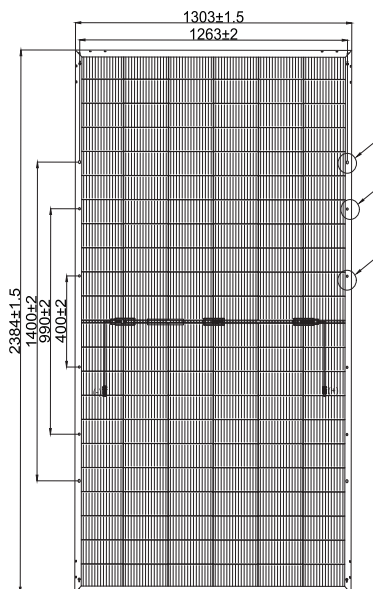
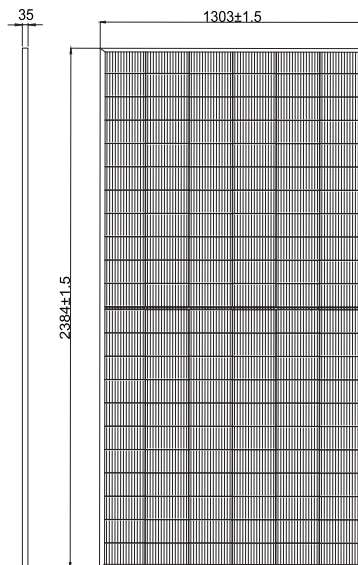

### Temperature Ratings

NOCT	44°C(±2°C)
Temperature Coefficient of $P_{MAX}$	-0.26%/°C
Temperature Coefficient of $V_{oc}$	-0.24%/°C
Temperature Coefficient of $I_{sc}$	0.04%/°C

(Do not connect Fuse in Combiner Box with two or more strings in parallel connection)

### Maximum Ratings

Operational Temperature	-40~+85 °C
Front/Rear Side Load	5400/2400pa
Max Series Fuse Rating	30A
Max System Voltage	1500V (IEC)
Fire Rating	Class 1(UNI9177)

### Warranty

30 years Product Workmanship Warranty
30 years Output Power Warranty

### Packaging Configuration

Modules per box:31 pieces
Modules per 40'container:527 pieces

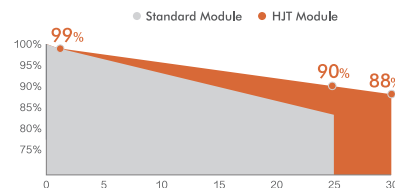

\* Refer to OMNISPOWER standard warranty for details

