

# SOLAR LEADING

To a better future

## SL6P72-290W-310W

Polycrystalline Photovoltaic Module



**14.94-15.97%**  
MAXIMUM EFFICIENCY

**290-310W**  
POWER OUTPUT RANGE

**72 CELL**  
POLYCRYSTALLINE MODULE

**0~+5W**  
POSITIVE OUTPUT GUARANTEE



**Excellent low light performance on cloudy days, mornings and evenings**

- Anti-reflective coating



**Ideal for large scale installations**

- High power footprint reduces installation time and BOS costs



**Certified to withstand challenging environmental conditions**

- 2400 Pa wind load
- 5400 Pa snow load
- 35mm hail stone at 97 km/hr



**IP68 connectors enhance the reliability of the PV system**



**Blowing sand resistance certification**



**Anti-PID**



**Fire test certification**



**Ammonia corrosion certification**



**Salt mist corrosion certification**

### **LINEAR PERFORMANCE WARRANTY**

**12 Year Product Warranty 25 Year Linear Power Warranty**

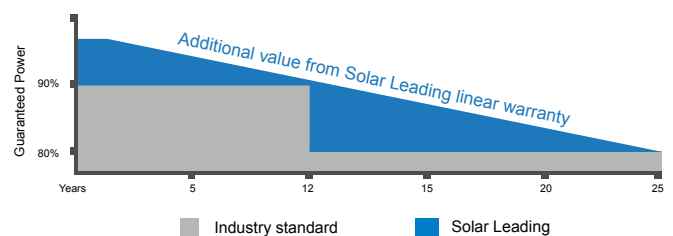

## Electrical Characteristics

Characteristics	Unit	SL6P72-290W	SL6P72-295W	SL6P72-300W	SL6P72-310W
Maximum Power (Pmax)	W	290	295	300	310
Power Tolerance	W	(0, +5)	(0, +5)	(0, +5)	(0, +5)
Maximum Power Voltage (Vmp)	V	36.2	36.4	36.5	36.7
Maximum Power Current (Imp)	A	8.01	8.11	8.21	8.31
Open Circuit Voltage (Voc)	V	44.7	44.9	45.1	45.3
Short Circuit Current (Isc)	A	8.54	8.61	8.67	8.74
Module Efficiency (ηm)	%	14.94	15.20	15.46	15.97
Dimension of module	mm	1956×992×40mm (77.0×39.1×1.6inch)			
Pmax Temperature Coefficient	%/C	-0.42			
Voc Temperature Coefficient	%/C	-0.30			
Isc Temperature Coefficient	%/C	+0.05			
Maximum System Voltage	VDC	1000(TUV);600(UL)			
Maximum Series Fuse Rating	A	15			
Operating Temperature	℃	-40 ~ +85			
<b>NOCT</b>	℃	45±2			

STC:1000W/m2. AM1.5 and 25℃ cell temperature: NOCT : Nominal Operating Cell Temperature

## I-V Curves

I-V Curves of PV Module SL6P72-290W  
(Cell Temp. 25℃)

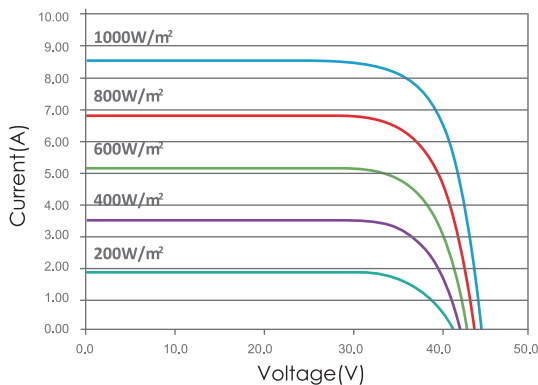

I-V Curves of PV Module SL6P72-290W  
at Different Cell Temp. (AM1.5, 1000W/m²)

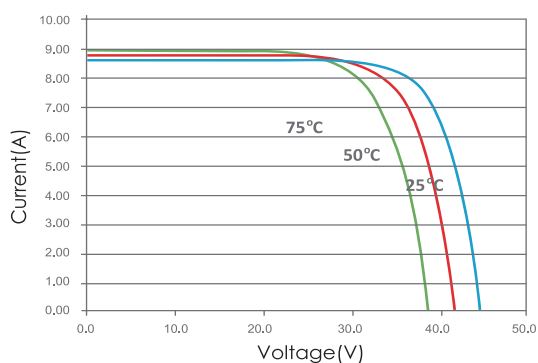

## Physical Characteristics

Unit:mm(inch)

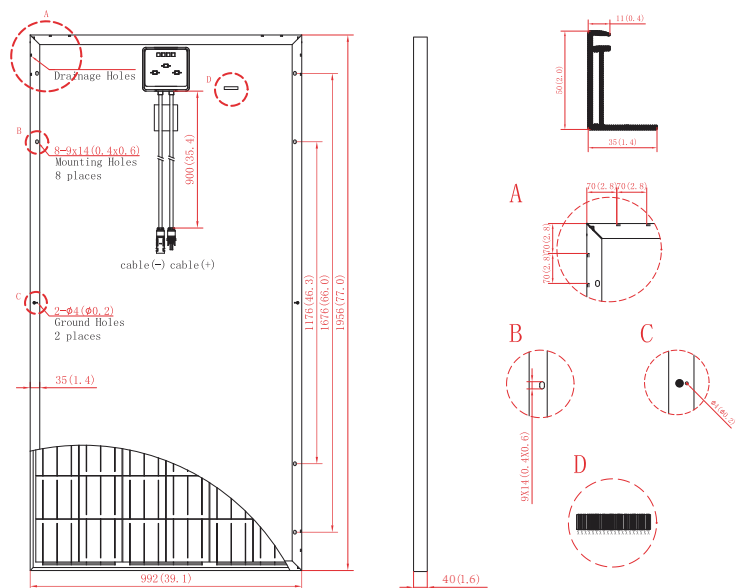

Cell Type	156mm x 156mm, Polycrystalline Silicon
No. of Cells	72pcs (6x12)
Dimension	1956x992x40mm (77.0x39.1x1.6inch)
Weight	24.0kg (52.9lbs.)
Cable Length	900mm (35.4inch)
Bypass Diodes	6/6pcs
Junction Box	IP65/IP68
Front Glass	4.0mm (0.1inch) tempered low-iron glass
Frame	Anodized aluminum alloy

\* Specifications are subjected to change without further notice

