

SSF Solar Module

SSF-M60



ELECTRICAL DATA (STC)

Peak Power Watts- P_{MAX} (Wp)*	280	285	290	295	300	305	310	315
Power Output Tolerance- P_{MAX} (W)	0 ~ +5							
Maximum Power Voltage- V_{MPP} (V)	31.7	31.8	32.2	32.5	32.6	32.9	33.1	33.3
Maximum Power Current- I_{MPP} (A)	8.84	8.97	9.01	9.08	9.19	9.28	9.37	9.46
Open Circuit Voltage- V_{OC} (V)	38.4	38.5	38.9	39.6	39.8	40.0	40.2	40.5
Short Circuit Current- I_{SC} (A)	9.42	9.51	9.66	9.68	9.77	9.85	9.94	10.0
Module Efficiency η_m (%)	17.1	17.4	17.7	18.0	18.3	18.6	18.9	19.2

STC: Irradiance 1000W/m², Cell Temperature 25°C, Air Mass AM1.5.
*Measuring tolerance: $\pm 3\%$.

ELECTRICAL DATA (NOCT)

Maximum Power- P_{MAX} (Wp)	209	212	216	220	223	227	231	235
Maximum Power Voltage- V_{MPP} (V)	29.4	29.5	29.9	30.1	30.2	30.5	30.7	30.9
Maximum Power Current- I_{MPP} (A)	7.10	7.21	7.24	7.30	7.38	7.46	7.53	7.60
Open Circuit Voltage- V_{OC} (V)	35.7	35.8	36.2	36.8	37.0	37.2	37.4	37.6
Short Circuit Current- I_{SC} (A)	7.61	7.68	7.80	7.82	7.89	7.95	8.03	8.10

NOCT: Irradiance at 800W/m², Ambient Temperature 20°C, Wind Speed 1m/s.

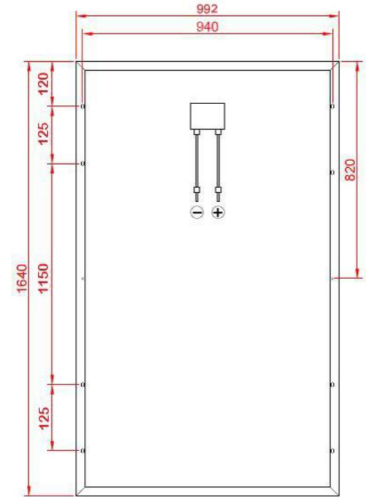

COMPONENT MATERIALS

Solar Cells	Mono Crystalline 157 × 157 mm (6.18 inches)
Cell Orientation	60 cells (6 × 10)
Module Dimensions	1640 × 992 × 35 mm (64.57 × 39.05 × 1.37 inches)
Weight	17.8 kg (39.24 lb)
Glass	3.2 mm (0.125 inches), High Transmission, AR Coated Tempered Glass, Anti-Reflective, Low Iron
Backsheet	White
Frame	Silver Anodized Aluminium Alloy
J-Box	IP 67 rated - 4 Railes - 3 pcs bypass diodes
Cables	Photovoltaic Technology Cable 4.0mm ² (0.006inches ²), 1000 mm (30.37 inches)
Connector	MC4 Compatible

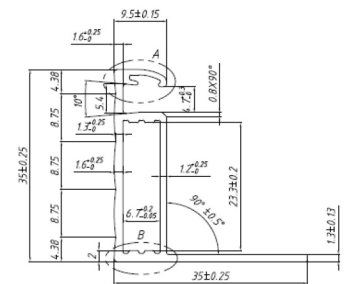

TEMPERATURE RATINGS

Nominal Operating Cell Temperature (NOCT)	44°C ($\pm 2^\circ\text{C}$)
Temperature Coefficient of P_{MAX}	-0.39%/°C
Temperature Coefficient of V_{OC}	-0.29%/°C
Temperature Coefficient of I_{SC}	0.05%/°C

MAXIMUM RATINGS

Operational Temperature	-40~+85°C
Maximum System Voltage	1000V DC
Max Series Fuse Rating	15A

WARRANTY

10 year Product Workmanship Warranty
25 year Linear Power Warranty

PACKAGING CONFIGURATION

Modules per box: 24 pieces
Modules per 40' container: 624 pieces

(Please refer to product warranty for details)

LINEAR PERFORMANCE WARRANTY

10 Year Product Warranty • 25 Year Linear Power Warranty

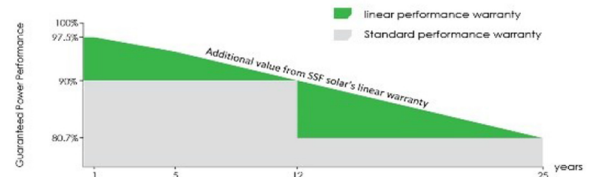

Electrical Performance & Temperature Dependence

I-V CURVES OF PV MODULE(305W)

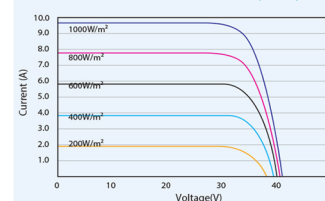

P-V CURVES OF PV MODULE(305W)

