



MONO PERC TWIN CELL SERIES

(72 Full Cells)

MCAL-TC-Series

Model	MCAL-TC-385	MCAL-TC-390	MCAL-TC-395	MCAL-TC-400	MCAL-TC-405	MCAL-TC-410	MCAL-TC-415
Type of cells	Mono Crystalline (PERC)						
Numbers of cells	72 (Twin Cell)						
Wattage (Wp)	385	390	395	400	405	410	415
Voltage at max.power (Vmax)	40.2	40.4	40.6	40.8	41.0	41.2	41.4
Open Circuit Voltage (Voc)	48.0	48.2	48.4	48.6	48.8	49.0	49.2
Current at maximum power (Imax)	9.58	9.66	9.73	9.80	9.88	9.95	10.02
Short circuit current (Isc)	10.09	10.17	10.25	10.33	10.41	10.50	10.57
Frame	Anodized Aluminium Alloy						
Front Glass	Tempered 3.2 mm (Low iron solar glass)						
Junction Box	IP 68						
Cable	4 mm ² PV cable						
Connector	MC4 Series						
Number of Diode	3						
Dimensions (mm)	2038 x 1000 x 40 mm						
Max Series fuse rating	30 A						
Weight (Kg)	22.5						
Operating temperature (Deg.C)	-40°C to + 85°C						
Application Class	Class A						
Maximum System Voltage	1500 VDC						
Temp. Coefficient's	Power = -0.35%/°C Voltage = -0.29%/°C Current = +0.05%/°C						
NOCT	45 +/- 3° C						
Maximum Load	5400 Pa						

Rear View

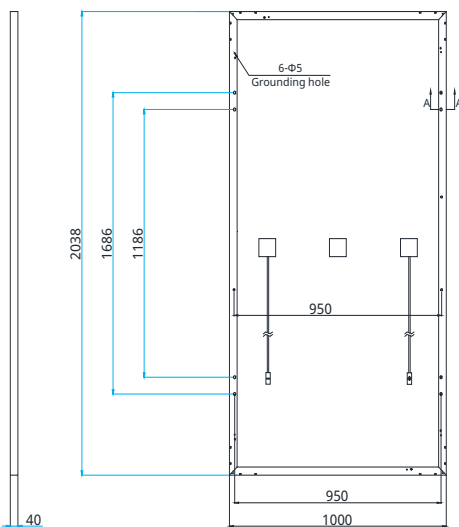

Frame Cross Section A-A

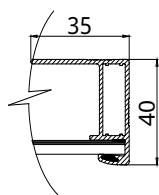

Mounting Hole

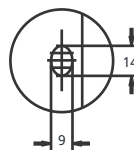

Current (A)

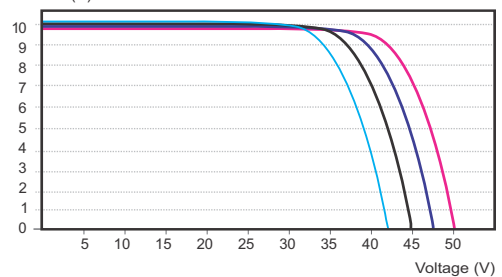

Current (A)

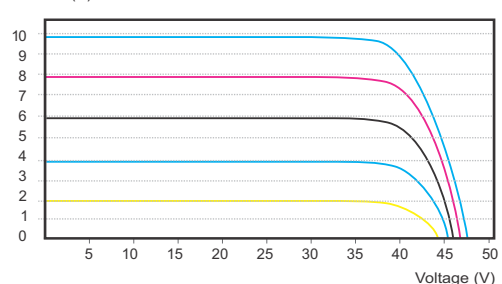

Specifications are subject to change without prior notice.