

Photowatt® PW72HT-C-XF



High efficiency multicrystalline module

Photowatt's PW72HT-C-XF is a high power double glass module with aluminium frame, using industry leading multi-PERC cell technology and the innovative Low Internal Current module technology

144 CELLS

MULTI-CRYSTALLINE MODULE

370 - 340 Wp

TYPICAL POWER

18.65 %

TYPICAL EFFICIENCY

CO₂

LOW-CARBON

0/+5 Wp

POWER TOLERANCE



ENVIRONMENTAL STANDARDS

- Respect the best standards of the profession (ISO 14001)
- Photowatt is co-founder of PV-CYCLE France for recycling used panels
- Priority to drastically limiting the carbon footprint



DURABILITY AND PERFORMANCE

- Modules certified by international laboratories (VDE)
- Anti-reflective coated glass to maximize power output
- Cells sorted out according to reverse current and shunt resistance
- Uniform and optimized spacing between solar cells



RELIABILITY

- 100% electroluminescence (EL) testing process to eliminate hidden defects

HIGHLY STRENGTHENED DESIGN

- Module complies with advanced loading tests to meet 5400 Pa loading requirements



MBB

5BB

***Transparent doubleglass module can be provided upon request**

Rear View

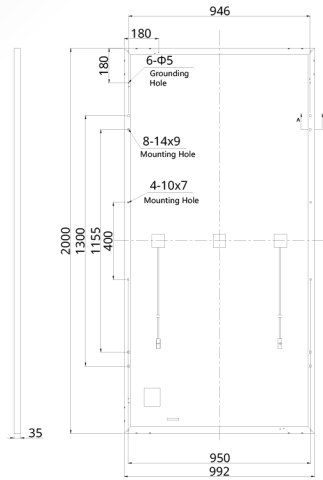

Frame Cross Section A-A

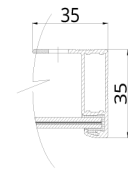

Mounting Hole

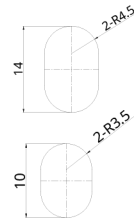

I-V CURVES

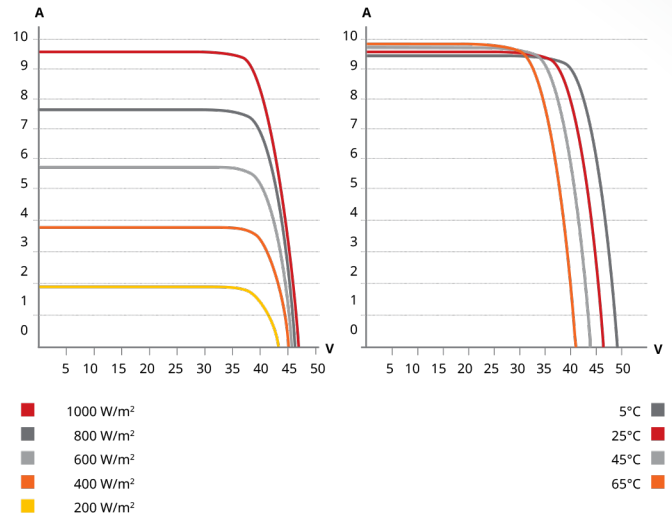

ELECTRICAL DATA (STC*)

Nominal Max. Power (Pmax)	W	340	345	350	355	360	365	370
Opt. Operating Voltage (Vmp)	V	38.4	38.6	39.2	39.4	39.6	39.8	40.0
Opt. Operating Current (Imp)	A	8.86	8.94	8.94	9.02	9.10	9.18	9.26
Open Circuit Voltage (Voc)	V	45.9	46.1	46.6	46.8	47.0	47.2	47.4
Short circuit current (Isc)	A	9.36	9.44	9.51	9.59	9.67	9.75	9.83
Module Efficiency	%	17.14	17.39	17.64	17.89	18.15	18.40	18.65
Operating temperature	-40°C à +85°C							
Maximum system voltage	1500V (IEC/UL) or 1000V (IEC/UL)							
Maximal serie fuse rating	30 A							
Application classification	Class A							
Power tolerance	0~ + 5 W							
Module Fire Performance	TYPE 3 / Type 13 (UL 1703) or CLASS C (IEC 61730)							

* Under Standard Test Conditions (STC) of irradiance of 1000 W/m², spectrum AM 1.5 and cell temperature of 25°C.

ELECTRICAL DATA (NMOT*)

Typical power	W	340	345	350	355	360	365	370
Nominal Max. Power (Pmax)	W	251	255	259	264	268	271	275
Opt. Operating Voltage (Vmp)	V	35.5	35.6	36.2	36.6	36.8	37.0	37.2
Opt. Operating Current (Imp)	A	7.08	7.15	7.15	7.21	7.27	7.34	7.40
Open Circuit Voltage (Voc)	V	42.7	42.9	43.4	43.9	44.1	44.3	44.4
Short circuit current (Isc)	A	7.55	7.62	7.68	7.74	7.80	7.87	7.93

* Under Nominal Module Operating Temperature (NMOT), irradiance of 800 W/m², spectrum AM 1.5, ambient temperature 20°C, wind speed 1 m/s.

WARRANTY

Product warranty	10 years
Linear power output warranty*	30 years

*See general warranty terms and conditions

MECHANICAL CHARACTERISTICS

Cell type	Multi-crystalline
Module size	2000 X 992 X 35 mm (78.7 X 39.1 X 1.38 in)
Module weight	26.5 kg (58.4 lbs)
Front / back glass	2.0 mm heat strengthened glass
Frame	Anodized aluminium alloy
J-BOX	IP68, 3 bypass diodes
Cable	4 mm ² (IEC), 12 AWG (UL)
Cable length (Including connector)	Portrait : 400mm (15.7 in) (+) / 280MM (11.0 in) (-); landscape : 1250mm (49.2 in); leapfrog connection : 1670mm (65.7 in)*
Connector type	T4 series or MC4-EVO2 or H4 UTX
Per pallet	30 pcs
Per container (40'HQ)	660 pcs

TEMPERATURE COEFFICIENT *

Typical cells temperature NMOT	°C	42 (±3°C)
Temperature coefficient Pmax	γ	-0.37 % / °C
Temperature coefficient Voc	β	-0.29 % / °C
Temperature coefficient Isc	α	0.05 % / °C

*1000 W/m²; temperature 25°C; spectrum AM 1,5

QUALITY CERTIFICATES

